



# HD Engineering & Design

*Solutions for all your engineering and design needs*

3/21/2024

STEWART BUILDERS

**RE: DECK POST CONNECTION**  
**3208 SW SADDLEBRED**  
**LEE'S SUMMIT, MO**

Our firm has been asked to address a rough framing inspection item for the deck of the home being built at the location listed above.

Please find below the alternate attachment detail for the post and side rim of the deck.

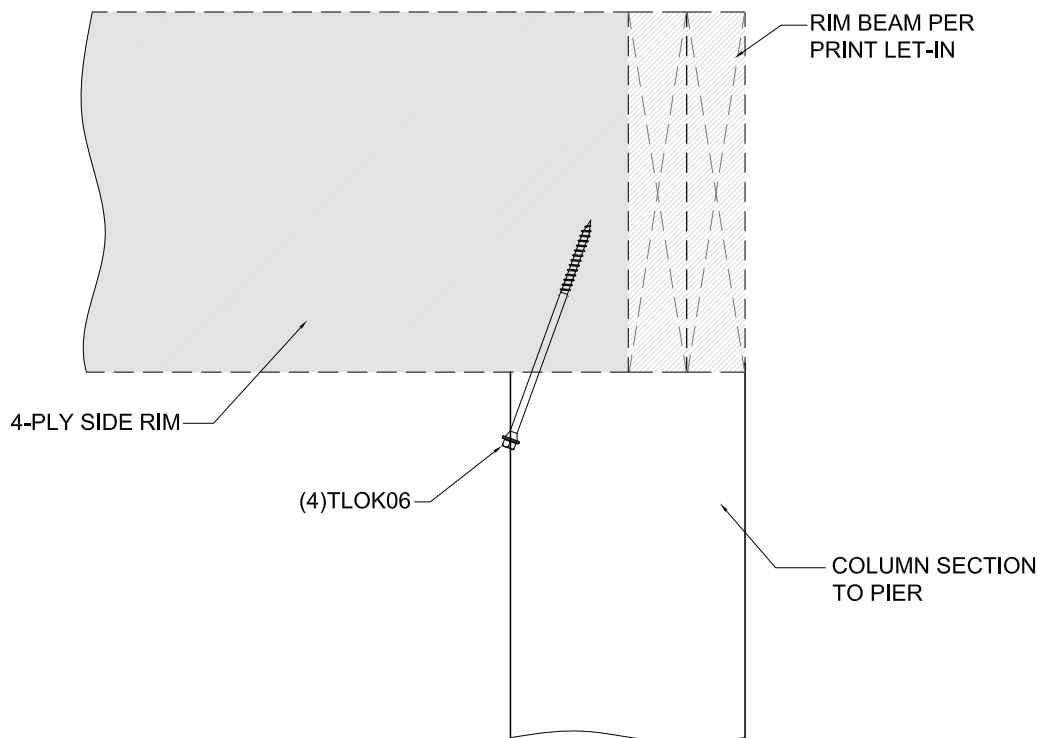

This report has been prepared for the exclusive use of our client for specific application to the project discussed and has been prepared in accordance with generally accepted engineering practices. No warranties, either express or implied, are intended or made.

We appreciate the opportunity to be of service to you on this project.  
If you have any questions regarding this report, please contact us.

Very truly yours,  
HD ENGINEERING & DESIGN, INC.

John Hulse, Principal



STRUCTURAL REVIEW  
HD ENGINEERING & DESIGN  
HD: 45344 DATE: 3/21/2024