

RELEASE FOR CONSTRUCTION
 AS NOTED FOR PLAN REVIEW
 DEVELOPMENT SERVICES
 LEE'S SUMMIT, MISSOURI
02/27/2024

LEGEND

- Gas Meter
- Telephone or Fiber-Optic Pedestal
- Cable TV Pedestal
- Electric Pedestal
- Light Pole
- Mailbox
- Fire Hydrant
- Water Valve

PROPOSED HOUSE

TOP FOUNDATION = 952.50
 GARAGE FLOOR = 951.00
 TOP FOOTING = 943.50
 BASEMENT FLOOR = 943.83
 DRIVE SLOPE = 7.8%

E = EXISTING ELEVATION
 F = PROPOSED FINAL ELEVATION
 G = ADJACENT GRADE AT EGRESS
 U/E = UTILITY EASEMENT
 B/L = BUILDING LINE
 S/Y/S = SIDE YARD SETBACK
 R/Y/S = REAR YARD SETBACK

NOTES

1. BUILDER TO VERIFY ALL BUILDING ELEVATIONS AND DIMENSIONS.
2. THIS PLOT PLAN DOES NOT CONSTITUTE A BOUNDARY SURVEY.
3. THE EASEMENTS SHOWN ON THIS PLOT PLAN ARE TAKEN FROM THE FINAL PLAT. OTHER EASEMENTS MAY EXIST.

Scale 1" = 30'

LOT INFORMATION

11,171 SQ. FT.
 MSFE = 941.39
 MLO (REAR LEFT) = 942.70
 MLO (REAR RIGHT) = 940.82
 ADDRESS
 2219 SW HOOK FARM DRIVE

LEGAL DESCRIPTION

LOT 115, HOOK FARMS SECOND PLAT, A SUBDIVISION AS RECORDED IN LEE'S SUMMIT, JACKSON COUNTY, MISSOURI.

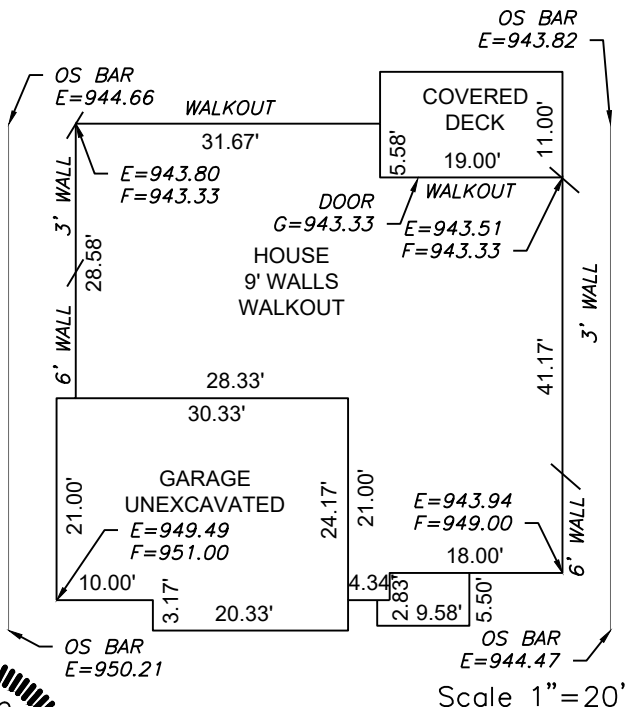

ENGINEERING

SOLUTIONS

ENGINEERING & SURVEYING

50 SE 30TH STREET
 LEE'S SUMMIT, MO 64082
 P:(816) 623-9888 F:(816)623-9849
 WWW.ENGINEERINGSOLUTIONKCC.COM

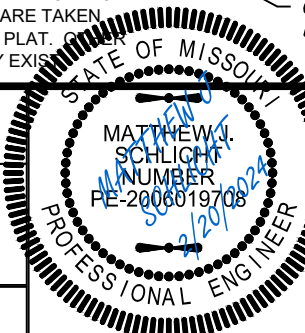

PLOT PLAN - LOT 115

HOOK FARMS SECOND PLAT
 LEE'S SUMMIT, JACKSON COUNTY, MISSOURI

ASPEN HOMES
 6018 ROYAL STREET
 PLEASANT VALLEY, MO 64068

PROJECT NO.	FILE NAME	DATE	SHEET	OF
1	LOT 115, HOOK FARMS	1/23/24	1	1

THIS DRAWING IS NOT VALID UNLESS THE SIGNATURE, DATE AND SEAL OF THE ENGINEER WHO SUPERVISED THE PREPARATION OF THIS DRAWING HAS BEEN AFFIXED HERETO.