

RELEASE FOR CONSTRUCTION  
AS NOTED FOR PLAN REVIEW  
DEVELOPMENT SERVICES  
LEE'S SUMMIT, MISSOURI  
02/13/2024

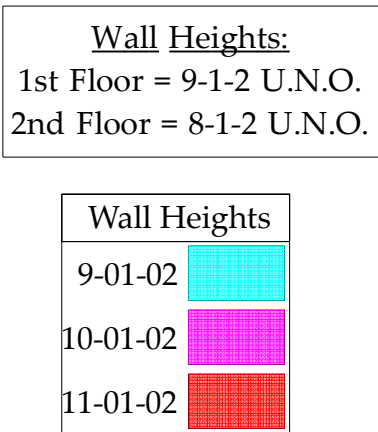

Triangle denotes the left end of the Truss as it appears on the Engineered Drawings provided.

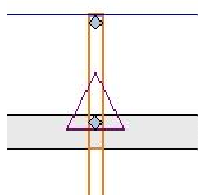

THIS IS A TRUSS PLACEMENT DIAGRAM ONLY. These trusses are designed as individual building components to be incorporated into the building design at the specification of the building designer. See individual design sheets for each truss identified on the placement drawing. The building designer is responsible for temporary and permanent bracing of the trusses during construction. The building designer is responsible for the design of the trusses and the design of the walls and columns is the responsibility of the building designer. For general guidance regarding trussing, consult "Bracing of wood trusses" available from the Truss Plate Institute, 583 Dornbros Drive, Madison, WI 53179.

**Shop Drawing Approval**

THIS LAYOUT IS THE SOLE SOURCE FOR FABRICATION OF TRUSSES AND JOISTS ALL PREVIOUS ARCHITECTURAL OR OTHER TRUSS LAYOUTS, REVIEW AND APPROVAL OF THIS LAYOUT MUST BE RECEIVED BEFORE ANY TRUSSES WILL BE BUILT. VERIFY ALL CONDITIONS TO INSURE AGAINST CHANGES THAT WILL RESULT IN EXTRA CHARGES TO YOU.

Approved By: \_\_\_\_\_ Date: \_\_\_\_\_

*Wheeler Lumber  
1959 Old Hwy 50 NE  
Waverly, KS 66871*



## Roof Truss Layout

Scale: 3/16" = 1'

EVERSTEAD  
SHOP DRAWINGS/SUBMITTAL REVIEW

SUBMITTAL WAS REVIEWED FOR DESIGN CONFORMITY  
AND GENERAL CONFORMANCE TO CONTRACT  
DOCUMENTS ONLY. THE CONTRACTOR IS RESPONSIBLE  
FOR CONFIRMING AND CORRELATING DIMENSIONS AT  
JOBSITE FOR TOLERANCE, CLEARANCE, QUANTITIES,  
FABRICATION, COORDINATION OF HIS OR HER WORK  
WITH OTHER TRADES, AND FULL COMPLIANCE WITH  
CONTRACT DOCUMENTS.

STATUS:  
**APPROVED**  
02/12/2024

REVIEWED BY:  
HCH

ENGINEER, EVERSTEAD ENGINEERING & DESIGN LLC.

RELEASE FOR CONSTRUCTION  
AS NOTED FOR PLAN REVIEW  
DEVELOPMENT SERVICES  
LEE'S SUMMIT, MISSOURI  
02/13/2024

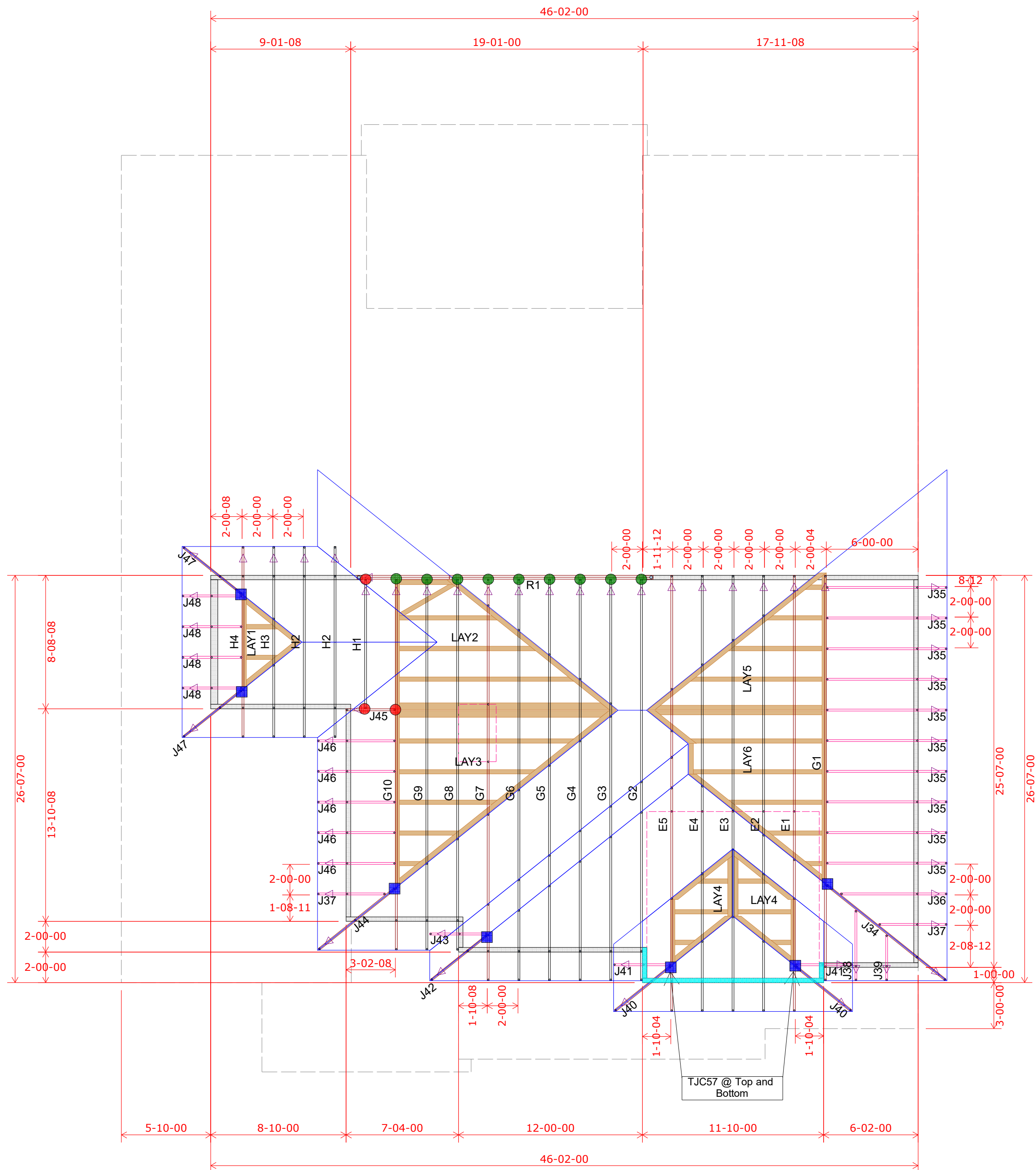

## Roof Truss Layout

Scale: 3/16" = 1'

	HANGER SCHEDULE	Quantity
●	LUS24	23
●	LUS26	0
●	HUS26	40
▲	HHUS26-2	0
▲	HGUS26-2	0
▲	HGUS28-3	0
■	LTHJA26	0
■	TJC37	12
■	TJC57	0
▲	HTS20	0

Triangle denotes the left end of the Truss as it appears on the Engineered Drawings provided.

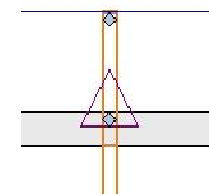

Unless otherwise specified  
by Engineer Of Record,  
Wheeler Lumber, LLC  
recommends an uplift  
connection at each bearing  
point per the following:

<u># of Uplift</u>	<u>Connector</u>
0 - 495:	(1) H2.5A
495 - 990:	(2) H2.5A
990 - 1245:	(1) HTS20

Installation per Simpson  
Strong-Tie guidelines.

For Reactions greater than 1245#, refer to EOR.

**THIS IS A TRUSS PLACEMENT DIAGRAM ONLY.** These trusses are designed as individual building components to be incorporated into the building design at the specification of the building designer. See individual design sheets for each truss design identified on the Placement drawing. The building designer is responsible for temporary and permanent bracing of the roof and floor system and for the overall structure. The design of the truss support structure including headers, beams, walls, and columns is the responsibility of the building designer. For general guidance regarding bracing, consult "Bracing of wood trusses" available from the Truss Plate Institute, 263 D'Ontorio Drive, Madison, WI 53179.

THIS LAYOUT IS THE SOLE SOURCE FOR FABRICATION OF TRUSSES AND VOIDS ALL PREVIOUS ARCHITECTURAL OR OTHER TRUSS LAYOUTS, REVIEW AND APPROVAL OF THIS LAYOUT MUST BE RECEIVED BEFORE ANY TRUSSES WILL BE BUILT. VERIFY ALL CONDITIONS TO INSURE AGAINST CHANGES THAT WILL RESULT IN EXTRA CHARGES TO YOU.

*Wheeler Lumber  
1959 Old Hwy 50 NE  
Waverly, KS 66871*

