



Wednesday, December 13, 2023

Whitney Neese
New Mark Homes
5207 NW Crooked Road
Parkville, MO 64152

Project: 23-341 Hook Farms Homestead – Lot 119
2630 S.W. Tracker Ln.
Lee's Summit, MO

Dear Whitney Neese,

This document shall serve as a response to the structural plan review comments for above referenced project ("Project").

#	PLAN REVIEW COMMENTS/RESPONSE
1.	The front entrance header has (2) jack studs and (2) king studs in place of the (3) king studs called for on the plans. Response: Install a Simpson CS16 strap from the top of the jack studs (minimum 11" overlap) up to the double top plate. See attached.

Where any requirements of the previously issued documents are modified, or deleted, the unaltered provisions shall remain in effect.

Please call if Apex Engineers, Inc. can be of further assistance.

Best Regards,

Response By:

Thomas Adams, P.E.
Project Engineer
Apex Engineers, Inc.

Reviewed By:

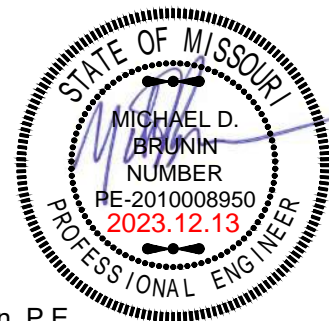

Michael D. Brunin, P.E.
Principal
Apex Engineer, Inc.



Project: 23-341

Sheet: 1/1

LOT 119 HOOK FARMS

Engineer: TDA

Date: 12/12/23

info@apex-engineers.com | www.apex-engineers.com

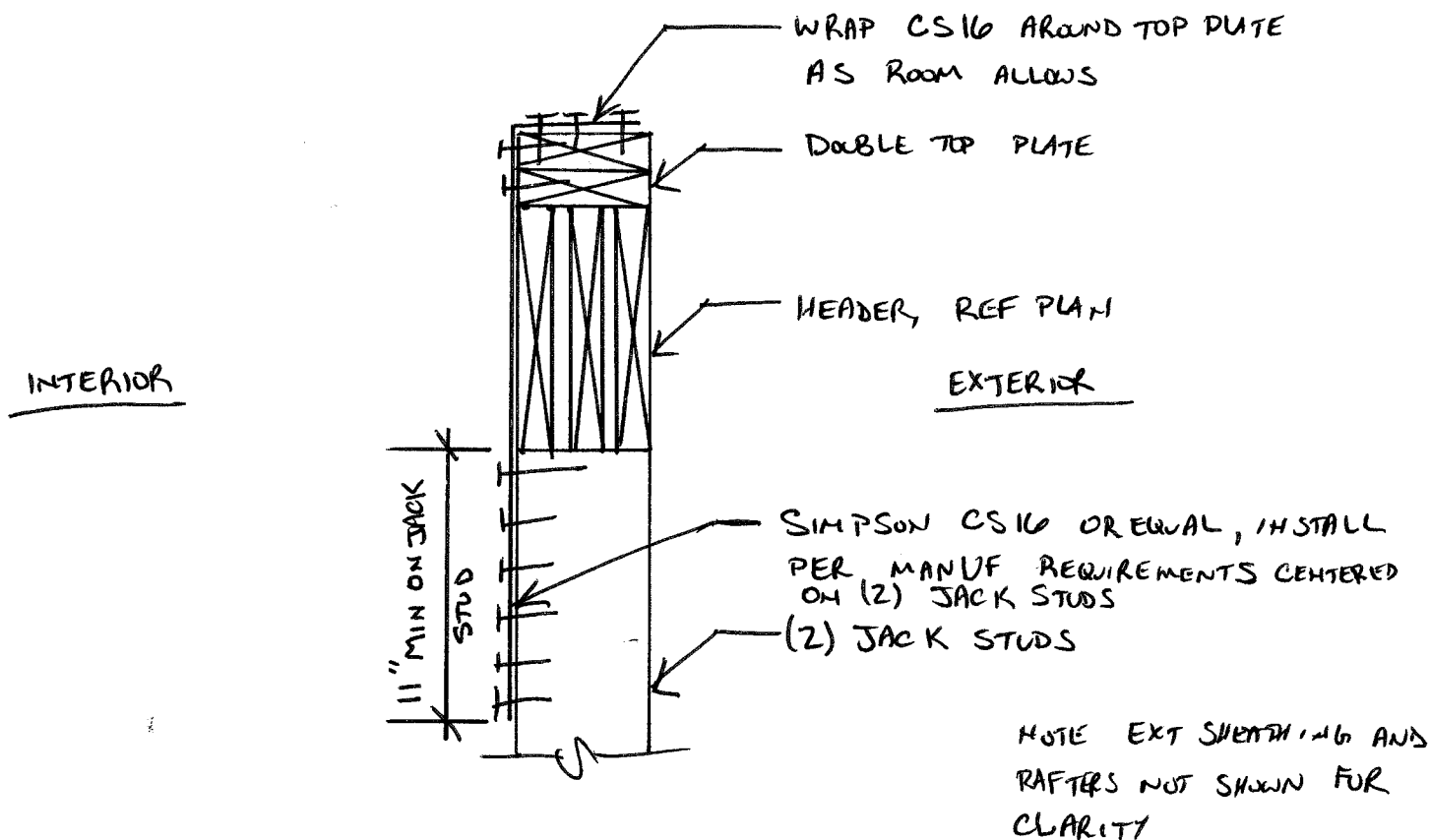

COIL STRAP INSTALLATION
N.T.S.