

RFI #149: LSFS 4&5 - Tel/Radio Room UL Listing Clarification

Status	Open		
To	Rich Arave (GLMV Architecture) Edgar Flores (GLMV Architecture) Chad Bard (GLMV Architecture)	From	Andrew Calderwood (McCownGordon Construction, LLC) 850 Main Street Kansas City, Missouri 64105
Date Initiated	Oct 17, 2023	Due Date	Oct 20, 2023
Location	Fire Station 4 & 5	Project Stage	
Cost Impact		Schedule Impact	
Spec Section		Cost Code	
Drawing Number	A-410, A-103	Reference	
Linked Drawings			
Received From	Sub Job		
Copies To	Andrew Calderwood (McCownGordon Construction, LLC), Nate Henson, STSC (McCownGordon Construction, LLC), Chloe Huxol (McCownGordon Construction, LLC), Michael Morgan (McCownGordon Construction, LLC)		

Activity

Question

Question from Andrew Calderwood McCownGordon Construction, LLC on Tuesday, Oct 17, 2023 at 09:47 AM CDT

Please confirm that U419 called out for the Tel/Radio room walls is sufficient to achieve the necessary fire rating at these walls. Please note that at the wall under the middle stringer, the inside two layers of rock will extend up to the shower pans, but the layer on the outside of the wall will terminate at the wood sill called out in D4/A-410.

Please provide details for how the ceiling shown in A6/A-410 is to tie into the walls to achieve the 1 hour fire rating.

Awaiting an Official Response

Refer to the image and email thread below for solution to this RFI.

- Edgar Flores, GLMV

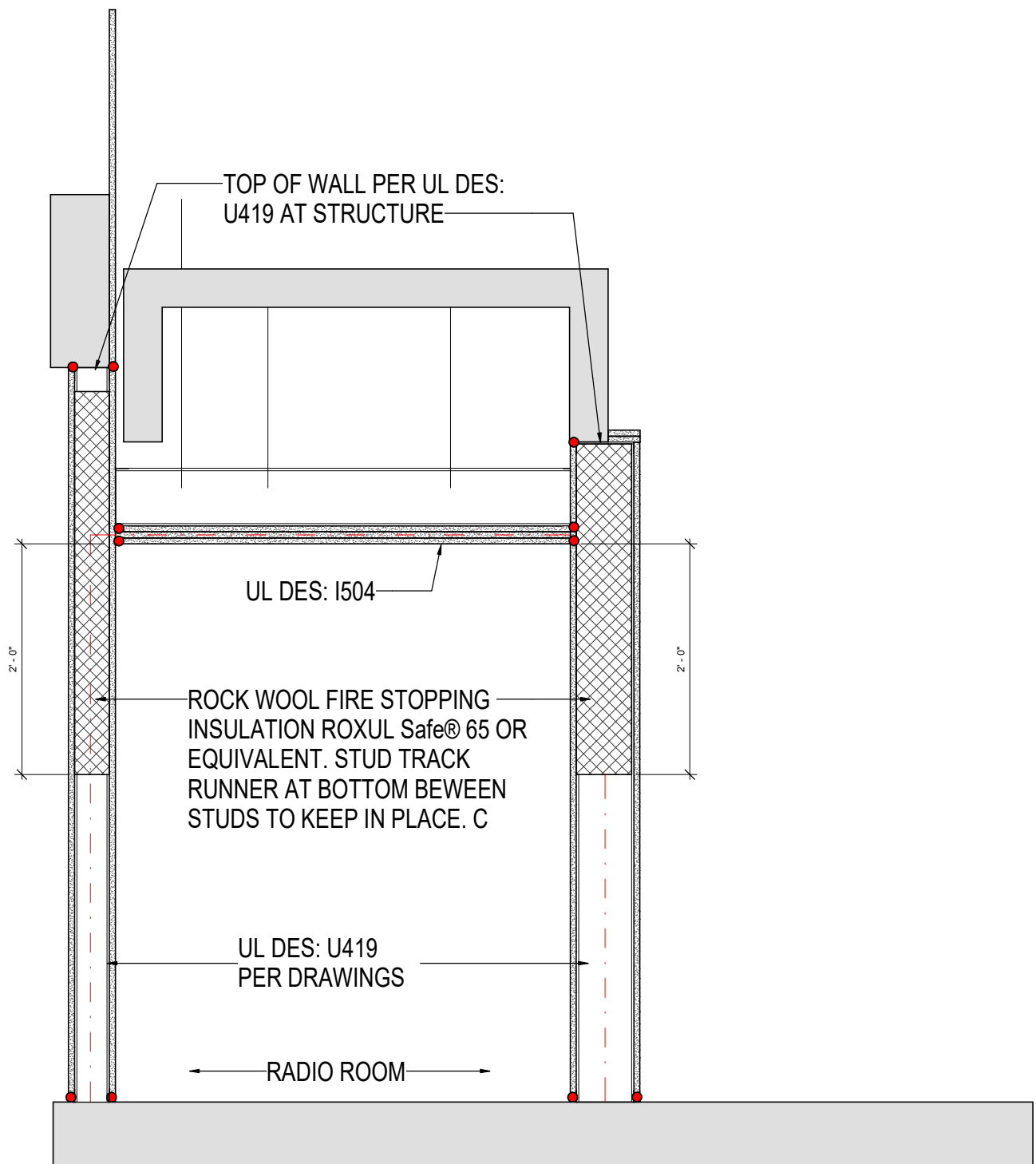

WALL OPTION WITH EXISTING STUDS TO REMAIN.

Chad,

PCI brought up CR103 and asked if it would be possible to use this UL in our condition. It is on page 108 of the attached and snipped below. Looks a lot like what you sent before. What are your thoughts on this?

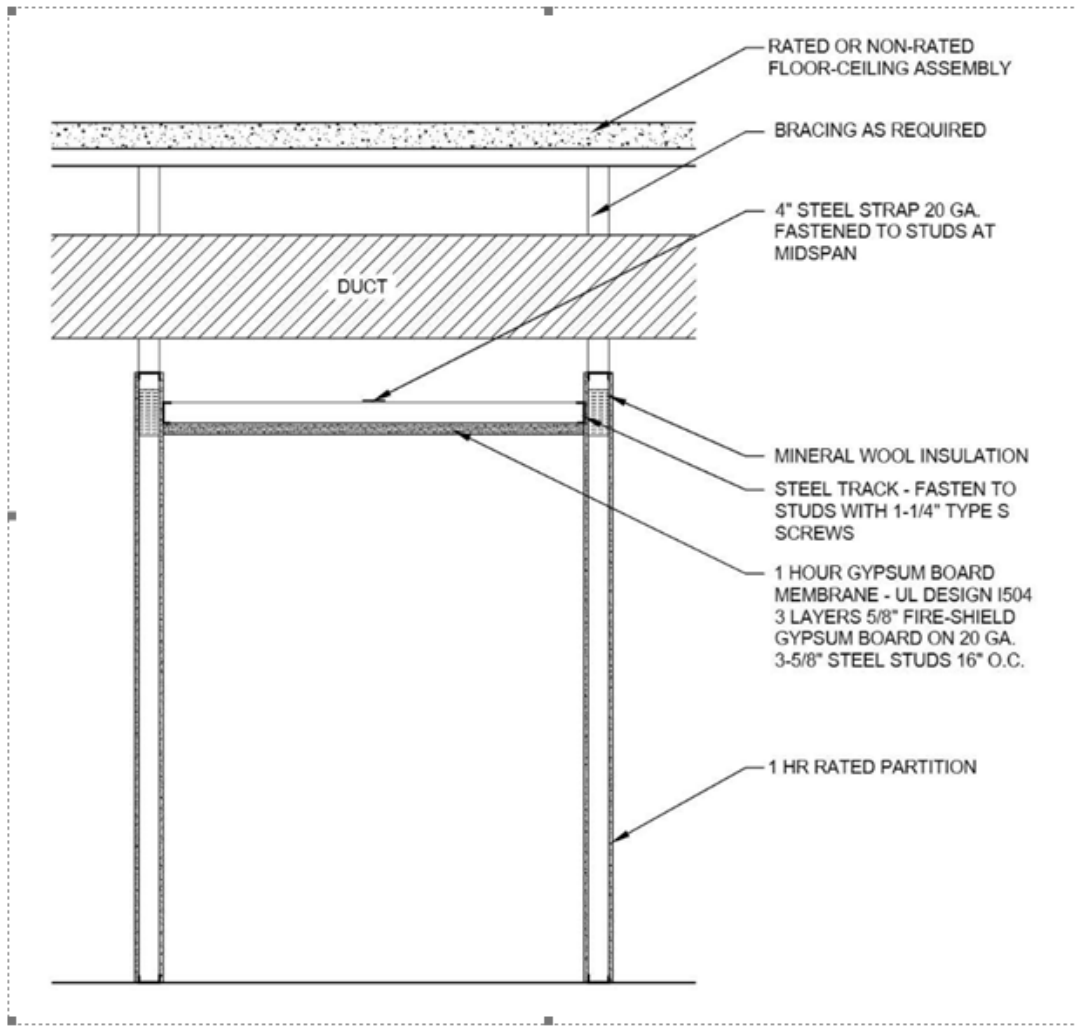

ANDREW CALDERWOOD
Senior Project Engineer

From: Chad Bard <chad.bard@glmv.com>
Sent: Monday, October 30, 2023 12:42 PM
To: Andrew Calderwood <acalderwood@mccowngordon.com>; Edgar Flores <edgar.flores@glmv.com>
Cc: Chloe Huxol <chuxol@mccowngordon.com>; Mike Morgan <mmorgan@mccowngordon.com>; Travis Grimes <tgrimes@mccowngordon.com>; Nate Henson <nhenson@mccowngordon.com>
Subject: Re: Revised Radio Room walls for discussion

This works for me. It doesn't appear different than the assemblies I sent to you and is functionally the same. This particular arrangement is intended for corridors where the wall doesn't go up to a roof, deck, or floor. Let's proceed with it. The mineral wool as I called out is the key component to continuity at the wall / ceiling transition. Thanks.

Chad Bard, AIA, NCARB
Project Manager
GLMV Architecture
9229 Ward Parkway, Suite 210 | Kansas City, MO 64114
Office 816-444-4200
Email chad.bard@glmv.com

From: Andrew Calderwood <acalderwood@mccowngordon.com>
Sent: Monday, October 30, 2023 12:46 PM
To: Chad Bard <chad.bard@glmvm.com>; Edgar Flores <edgar.flores@glmvm.com>
Cc: Chloe Huxol <chuxol@mccowngordon.com>; Mike Morgan <mmorgan@mccowngordon.com>; Travis Grimes <tgrimes@mccowngordon.com>; Nate Henson <nhenson@mccowngordon.com>
Subject: RE: Revised Radio Room walls for discussion

⚠ Sent from external sender ⚠

Sounds good, thanks Chad.

To be clear, we don't have any top of wall requirements that require interrupting the studs at the top of the first floor with a certain top track or anything right? Is there a required mineral wool depth?

ANDREW CALDERWOOD
Senior Project Engineer

MCCOWNGORDON
O 816.960.1111 M 816.501.8628



Chad Bard

To ✓ Andrew Calderwood; ✓ Edgar Flores
Cc ● Chloe Huxol; ✓ Mike Morgan; ○ Travis Grimes; ○ Nate Henson

Reply

Reply All

Forward

Mon 10/30/2023 1:43 PM

If there are problems with how this message is displayed, click here to view it in a web browser.

the top of wall is non load bearing in the UL Design. I don't see a UL callout for the wall used in the screen shot, but it appears that the top of wall track can happen above the fire rating line of the ceiling if the transition of fire stopped with mineral wool. The installation of the insulation is per manufacturer's written instructions for the desired rating, but full stud depth with non-combustible retention in the form of horizontal track between studs

Chad Bard, AIA, NCARB
Project Manager
GLMV Architecture
[9229 Ward Parkway, Suite 210 | Kansas City, MO 64114](https://www.glmv.com)
Office 816-444-4200
Email chad.bard@glmvm.com