

CURRAN
ARCHITECTURE
5719 LAWTON LOOP E. DR. #212
INDIANAPOLIS, IN 46216
O :: 317 . 288 . 0681
F :: 317 . 288 . 0753



SCANNELL
PROPERTIES

CERTIFICATION

THE DRAWING AND THE DATA DESIGN AND CONCEPTS CONTAINED HEREIN ARE THE EXCLUSIVE INTELLECTUAL PROPERTY OF CURRAN ARCHITECTURE. NO PART OF THIS DRAWING OR DESIGN MAY BE REPRODUCED OR TRANSMITTED IN ANY FORM OR BY ANY MEANS, WITHOUT THE WRITTEN CONSENT OF CURRAN ARCHITECTURE. © COPYRIGHT 2017, CURRAN ARCHITECTURE

PROJECT INFORMATION
LEES SUMMIT LOGISTICS
BUILDING B LOT 2

X CORNER OF
NE TUDOR RD & MAIN ST
LEES SUMMIT, MO 64086



8/22/23

ISSUE DATES	
PERMIT SET	08.29.23
CITY COMMENTS 09.18.23	

HERITAGE ELECTRIC, L.L.C.
844 N. MARTIN
Olathe, Kansas 66061
phone (913) 747 0528
fax (913) 747 0538



THIS DRAWING HAS BEEN PRODUCED BY HERITAGE ELECTRIC, L.L.C. AND THE ALIEN COMPANY OF HERITAGE ELECTRIC, L.L.C. AND THE ALIEN COMPANY OF HERITAGE ELECTRIC, L.L.C. FOR ANY OTHER PURPOSES. THE SEAL OF THE ELECTRICAL P.E. APPLIES TO ONLY THIS DRAWING, SPECIFICATIONS AND OTHER DOCUMENTS WHICH DO NOT CONTAIN THE PERSONAL SEAL OF THE UNDERSIGNED PROFESSIONAL.

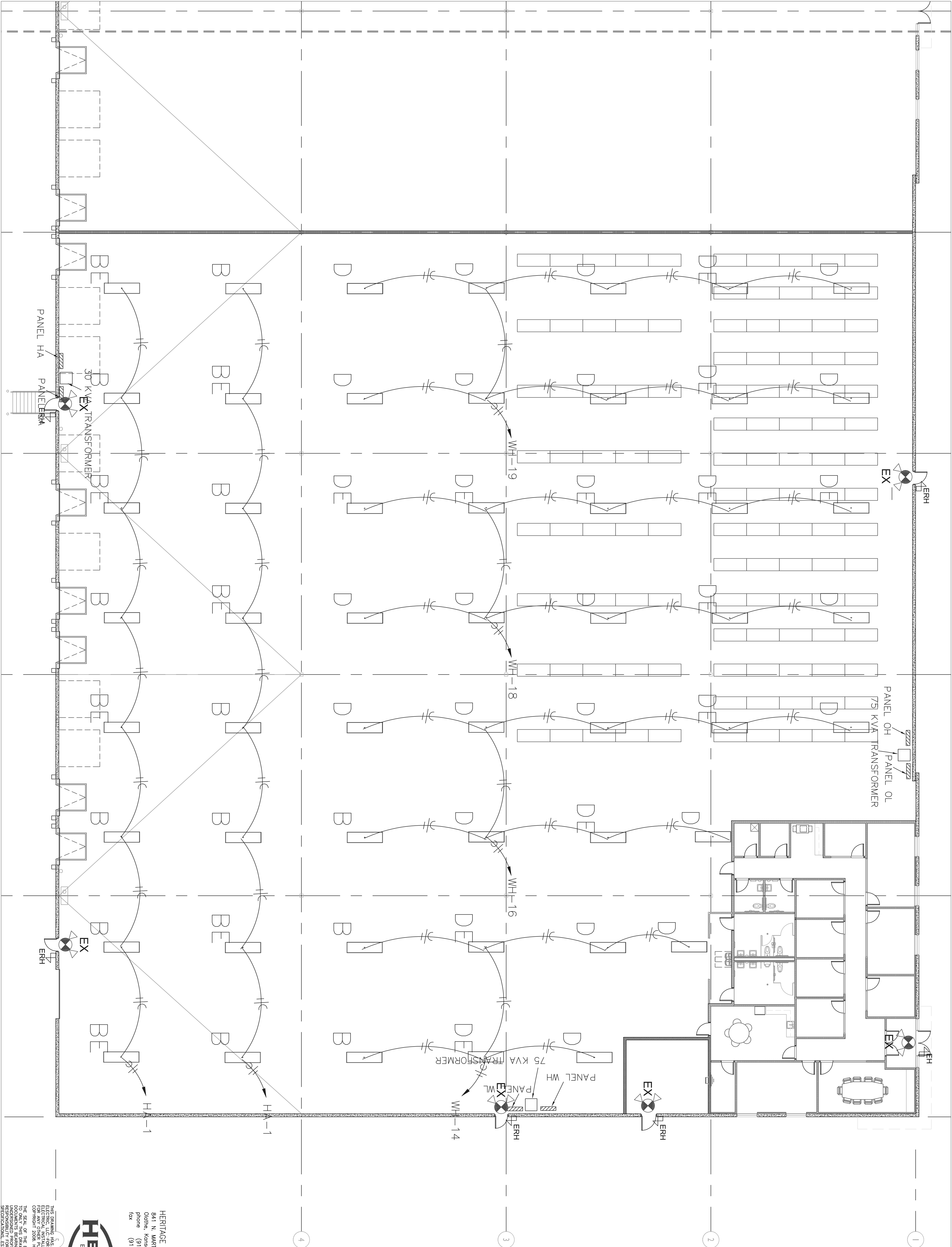

1 WAREHOUSE LIGHTING PLAN
3/32" = 1'

EI.10

220018
WAREHOUSE LIGHTING
PLAN