



2023 REMODEL

2801 NORTHEAST
INDEPENDENCE AVE
SUITE 201
LEE'S SUMMIT
MISSOURI, 64064

RELEASED FOR CONSTRUCTION
As Noted on Plan Review

Lee's Summit Fire Department
Lee's Summit, Missouri

09/26/2023

- NOTES:
1. All smoke detectors shall be located a minimum of three (3) feet from any HVAC diffuser.
 2. All manual pull stations shall be mounted four (4) feet above the finished floor (centerline of device, +or-6inches), unless otherwise noted.
 3. All strobe and horn/strobes shall be located so the bottom of the device is not less than 80 inches above the finished floor and not greater than 96 inches above the finished floor.
 4. All notification devices shall be located no less than 6 inches below finished ceilings.
 5. The candela rating of the strobes or horn/strobes shall be shown on the drawings.
 6. The location of the notification devices shall be at a uniform height for all devices.
 7. All cables, conduits, or wire mold shall be securely fastened to the structure.
 8. Smoke detectors shall be located in the ceiling no less than 4 inches from a sidewall to the nearest edge of the detector.
 9. Drawings indicate general fire alarm device locations and Field Verify device locations with minimal deviations and document any changes.
 10. FACP & Power Supplies shall be on a dedicated 120V, 20A circuit breaker marked in red with lock-on provision.
 11. Fire Alarm wire paths are reserved for fire alarm cabling only. Including all UL listed fire barrier penetrations.
 - 12.Outdoor Weatherproof Horn/Strobe is to be mounted 10' 00" AFF FDC.
 13. All ceilings are 10' or below unless otherwise noted.
 14. Default batteries are 18 - amp hour unless otherwise noted.
 15. LED Remote Test Switches are to be ceiling mounted directly below above ceiling duct detector.

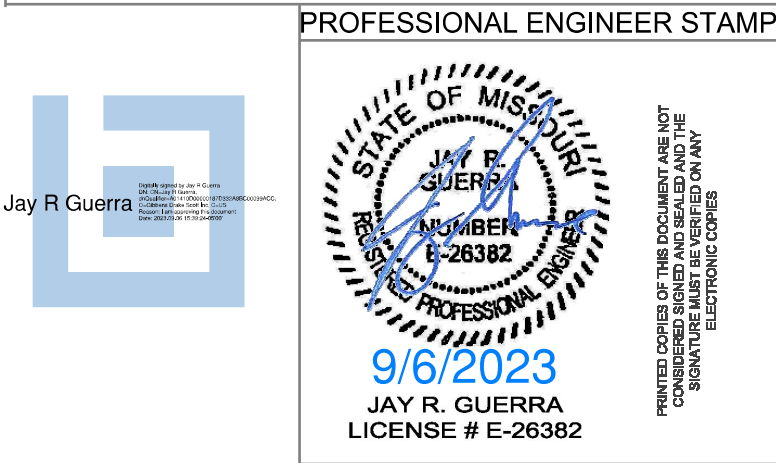
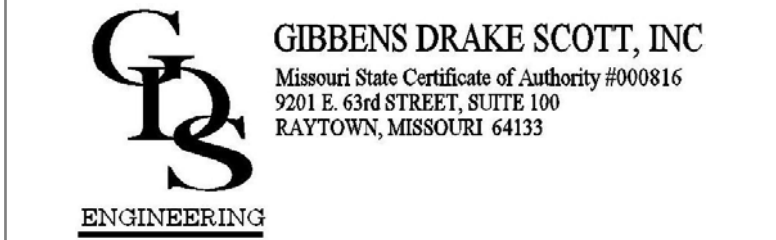

REVISIONS:		DATE:



SITE:2801 NE Independence Ave Suite 201, Lee's Summit

TITLE: Cover Page

SCALE AT:	DATE: 8/29/2023	DESIGNED BY:
PROJECT NO:	DRAWING NO:	REVISION:

- A. NEW BUILDING AND INTERIOR FINISH
- B. ALL CONSTRUCTION FOR THIS PROJECT SHALL BE PERFORMED UNDER THE PROVISIONS OF FOLLOWING LIST OF CODES, AS AMENDED BY THE CITY OF LEES SUMMIT, MISSOURI:
- B.1. 2018 International Building Code
 - B.2. 2018 International Plumbing Code
 - B.3. 2018 International Mechanical Code
 - B.4. 2018 International Fuel Gas Code
 - B.5. 2018 International Residential Code
 - B.6. 2018 International Fire Code
 - B.7. 2017 National Electrical Code
 - B.8. ICC/ANSI A117.1-2017, Accessible and Usable Buildings and Facilities
- C. Use, Occupancy Classification, and Type of Construction:
- C.1. Tenant Use: Professional Services - Medical Office.
 - C.2. Tenant Occupancy Classification: B - Business
 - C.3. Building Type of Construction: IIB
- D. Tenant Square Foot Calculations:
- D.1. Existing with limited work = 5,500 sf
 - D.2. Existing to be remodeled = 681 sf
 - D.3. Expansion in empty shell = 1,808 sf
 - D.4. Total Tenant area = 7,989 sf
- E. Fire Protection Systems:
- E.1. Automatic Sprinkler Systems: Provided.
 - E.2. Fire Alarm and Detection Systems: Provided.
- F. Tenant Occupant Load (Table 1003.2.2.2): See Code Plan
22.02 + 13.89 + 20.44 + 27.92 + 6.63 = 90.9 = 91 occupants

Circuit Legend			
Abbreviation	Type	Name	Wire
A	Notification	NAC	14/2 UNS SOL FPLF RED Jkt

Symbol Legend		
SYMBOL	DESCRIPTION	PART NUMBER
	HORN/STROBE, 2 WIRE, M-C,WHITE, WALL	HS-24WW
	STROBE, M-C, WHITE, WALL	S-24WW

Scope:	SANO Orthopedics is remodeling an existing building. Envision will installing new Potter devices in the remodeled space that will added on to the existing Potter FA system.
--------	--

Sheet Index	
FA-1	Cover Sheet
FA-2	Floor Plan
FA-3	Floor Plan-Remodeled Space Expanded
FA-4	Battery Calculations, Riser Diagram
FA-5	NFPA 72 Reference

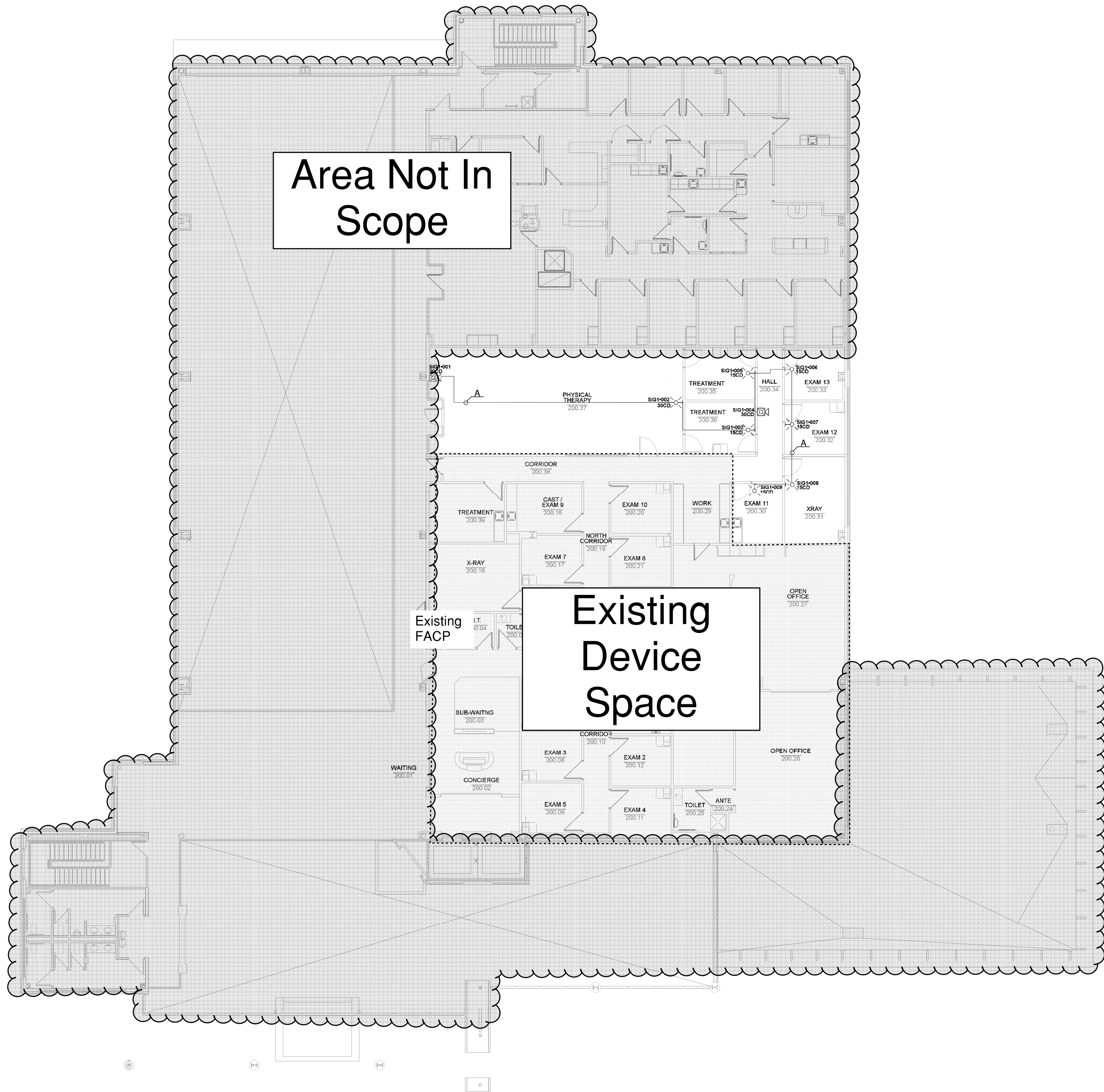

NOTES:

1. All smoke detectors shall be located a minimum of three (3) feet from any HVAC diffuser.
2. All manual pull stations shall be mounted four (4) feet above the finished floor (centerline of device, +or-6inches), unless otherwise noted.
3. All strobe and horn/strobes shall be located so the bottom of the device is not less than 80 inches above the finished floor and not greater than 96 inches above the finished floor.
4. All notification devices shall be located no less than 6 inches below finished ceilings.
5. The candela rating of the strobes or horn/strobes shall be shown on the drawings.
6. The location of the notification devices shall be at a uniform height for all devices.
7. All cables, conduits, or wire mold shall be securely fastened to the structure.
8. Smoke detectors shall be located in the ceiling no less than 4 inches from a sidewall to the nearest edge of the detector.
9. Drawings indicate general fire alarm device locations and Field Verify device locations with minimal deviations and document any changes.
10. FACP & Power Supplies shall be on a dedicated 120V, 20A circuit breaker marked in red with lock-on provision.
11. Fire Alarm wire paths are reserved for fire alarm cabling only. Including all UL listed fire barrier penetrations.
12. Outdoor Weatherproof Horn/Strobe is to be mounted 10' 00" AFF FDC.
13. All ceilings are 10' or below unless otherwise noted.
14. Default batteries are 18 - amp hour unless otherwise noted.
15. LED Remote Test Switches are to be ceiling mounted directly below above ceiling duct detector.

GIBBENS DRAKE SCOTT, INC.
Missouri State Certificate of Authority #000816
9201 E. 63rd STREET, SUITE 100
RAYTOWN, MISSOURI 64133

ENGINEERING

PROFESSIONAL ENGINEER STAMP:



REVISIONS:	DATE:

ENVISION
TECHNOLOGY GROUP

6985 W 153rd St
Overland Park, KS 66223

913-491-1700
913-491-1701

SITE: 2801 NE Independence Ave Suite 201, Lee's Summit

TITLE: Floor Plan

SCALE AT: 1/16"=1'	DATE: 8/29/2023	DESIGNED BY:
PROJECT NO:	DRAWING NO:	REVISION:



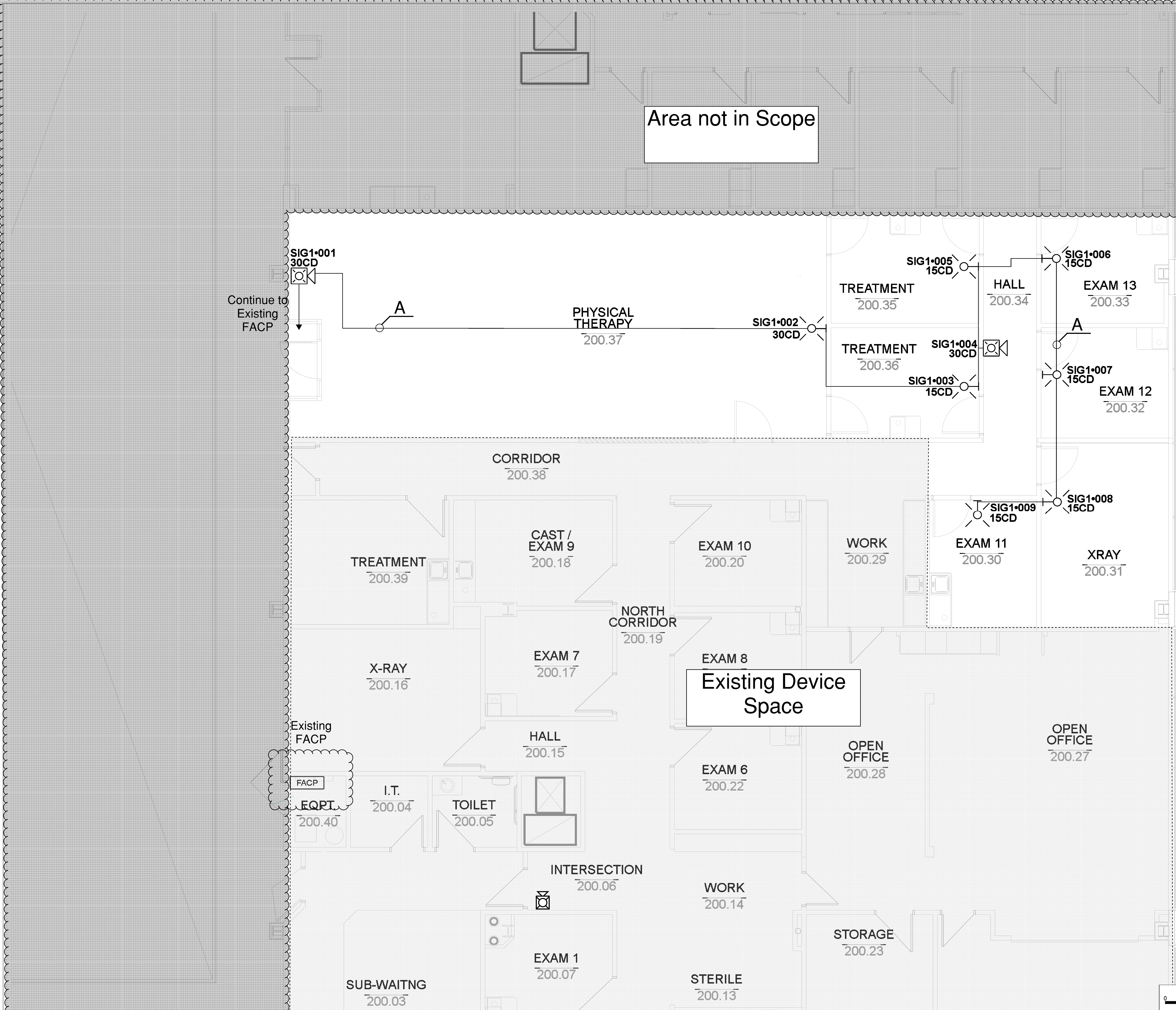

NOTES:

1. All smoke detectors shall be located a minimum of three (3) feet from any HVAC diffuser.
2. All manual pull stations shall be mounted four (4) feet above the finished floor (centerline of device, +or-6inches), unless otherwise noted.
3. All strobe and horn/strobes shall be located so the bottom of the device is not less than 80 inches above the finished floor and not greater than 96 inches above the finished floor.
4. All notification devices shall be located no less than 6 inches below finished ceilings.
5. The candle rating of the strobes or horn/strobes shall be shown on the drawings.
6. The location of the notification devices shall be at a uniform height for all devices.
7. All cables, conduits, or wire mold shall be securely fastened to the structure.
8. Smoke detectors shall be located in the ceiling no less than 4 inches from a sidewall to the nearest edge of the detector.
9. Drawings indicate general fire alarm device locations and Field of view of devices with minimal deviations and document any changes.
10. FACP & Power Supplies shall be on a dedicated 120V, 20A circuit breaker marked in red with lock-on provision.
11. Fire Alarm wire paths are reserved for fire alarm cabling only. Including all UL listed fire barrier penetrations.
12. Outdoor Weatherproof Horn/Strobe is to be mounted 10' 00" AFF FDC.
13. All ceilings are 10' or below unless otherwise noted.
14. Default batteries are 18 - amp hour unless otherwise noted.
15. LED Remote Test Switches are to be ceiling mounted directly below ceiling duct detector.



HIBBENS DRAKE SCOTT, INC
Missouri State Certificate of Authority #000816
101 E. 63rd STREET, SUITE 100
ST. LOUIS, MISSOURI 64113



REVISIONS:		DATE:



913-491-1700 6985 W 153rd St
913-491-1701 Overland Park, KS 66223



SITE:2801 NE Independence Ave Suite 201, Lee's Summit

TITLE: Floor Plan-Remodeled Space Expanded

SCALE AT: 1/4"=1'	DATE:	DESIGNED BY:
-------------------	-------	--------------

PROJECT NO:	DRAWING NO:	REVISION:
-------------	-------------	-----------

Battery Calculations for Panel: Existing FACP						
Part No:IPA-60 - IPA-60, 60 POINT RELEASING FACP						
Job number: 1 Job name: Drawing1						
Part No.	Qty.	Description	Standby	Total Standby	Alarm	Total Alarm
		Panel Equipment				
IPA60_MB	1	IPA60_MB	160.0000 mA	160.0000 mA	200.0000 mA	200.0000 mA
			Total Panel Stby	160.0000 mA	Total Panel Alarm	200.0000 mA
		Peripheral Devices				
S-24WW	6	STROBE, M-C, WHITE, WALL (Notification) 15CD	0.0000 mA	0.0000 mA	42.0000 mA	252.0000 mA
HS-24WW	2	HORN/STROBE, 2 WIRE, M-C,WHITE, WALL (Notification) 30CD 70dB	0.0000 mA	0.0000 mA	73.0000 mA	146.0000 mA
S-24WW	1	STROBE, M-C, WHITE, WALL (Notification) 30CD	0.0000 mA	0.0000 mA	58.0000 mA	58.0000 mA
			Total Peripheral Stby	0.0000 mA	Total Periph Alarm	456.0000 mA
			Total Standby Amps	160.0000 mA	Total Alarm Amps	656.0000 mA
					Standby time: 24 Hrs	3.84 Ah
					Alarm time: 5 Min	0.055 Ah
					Battery requirement:	3.895 Ah
Compensation Factors - Standby:1.25 Alarm:1.25 Requirement with compensation:						4.868 Ah
Circuit Calculations Panel: Existing FACP Card: 00 Circuit:SIG1						
Circuit Name: SIG1						
Circuit Type: Notification Terminal Voltage: 20.4 V:DC Amperage: 3.0000 A						
Cable: 16 AWG 2 CONDUCTOR BARE COPPER, TWISTED, SHIELDED, PLENUM FA, FPLP #16						
Calculations based on Running Total Length.						
Design Criteria: Ambient temperature: 167 °F Max. operating voltage drop: 18%						
Device	Part No	Appliance Desc	Distance	Current	Voltage	Voltage Drop
	IPA-60	Panel			20.4 V	
001	HS-24WW	HORN/STROBE, 2 WIRE, M-C,WHITE, WALL, 30CD	58'-6	73.0000 mA	20.2678 V	(0.1322 V)
002	S-24WW	STROBE, M-C, WHITE, WALL, 30CD	53'-8½	58.0000 mA	20.1663 V	(0.1015 V)
003	S-24WW	STROBE, M-C, WHITE, WALL, 15CD	18'-6½	42.0000 mA	20.137 V	(0.0292 V)
005	S-24WW	STROBE, M-C, WHITE, WALL, 15CD	11'-3	42.0000 mA	20.1254 V	(0.0116 V)
006	S-24WW	STROBE, M-C, WHITE, WALL, 15CD	8'-6½	42.0000 mA	20.1187 V	(0.0067 V)
007	S-24WW	STROBE, M-C, WHITE, WALL, 15CD	11'-0	42.0000 mA	20.1118 V	(0.0069 V)
008	S-24WW	STROBE, M-C, WHITE, WALL, 15CD	11'-11	42.0000 mA	20.1071 V	(0.0046 V)
009	S-24WW	STROBE, M-C, WHITE, WALL, 15CD	7'-5	42.0000 mA	20.1057 V	(0.0015 V)

004	HS-24WW	HORN/STROBE, 2 WIRE, M-C,WHITE, WALL, 30CD	0'-11½	73.0000 mA	20.1328 V	(0 V)
			181'-10½	456.0000 mA		
Total Current: 456.0000 mA						
(Total VDrop Percent:1.44%) Total Voltage Drop : 0.2943 V						

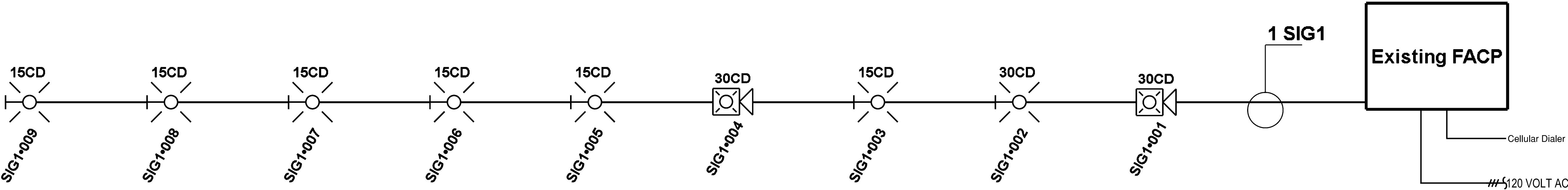

NOTES:

1. All smoke detectors shall be located a minimum of three (3) feet from any HVAC diffuser.

2. All manual pull stations shall be mounted four (4) feet above the finished floor (centerline of device, +or-6inches), unless otherwise noted.

3. All strobe and horn/strobes shall be located so the bottom of the device is not less than 80 inches above the finished floor and not greater than 96 inches above the finished floor.

4. All notification devices shall be located no less than 6 inches below finished ceilings.

5. The candela rating of the strobes or horn/strobes shall be shown on the drawings.

6. The location of the notification devices shall be at a uniform height for all devices.

7. All cables, conduits, or wire mold shall be securely fastened to the structure.

8. Smoke detectors shall be located in the ceiling no less than 4 inches from a sidewall to the nearest edge of the detector.

9. Drawings indicate general fire alarm device locations and Field Verify device locations with minimal deviations and document any changes.

10. FACP & Power Supplies shall be on a dedicated 120V, 20A circuit breaker marked in red with lock-on provision.

11. Fire Alarm wire paths are reserved for fire alarm cabling only. Including all UL listed fire barrier penetrations.

12.Outdoor Weatherproof Horn/Strobe is to be mounted 10' 00" AFF FDC.

13. All ceilings are 10' or below unless otherwise noted.

14. Default batteries are 18 - amp hour unless otherwise noted.

15. LED Remote Test Switches are to be ceiling mounted directly below above ceiling duct detector.

GS

ENGINEERING

GIBBENS DRAKE SCOTT, INC

Missouri State Certificate of Authority #000816

9201 E. 63rd STREET, SUITE 100

RAYTOWN, MISSOURI 64133

PROFESSIONAL ENGINEER STAMP:



REVISIONS:	DATE:

ENVISION

TECHNOLOGY GROUP

913-491-1700

913-491-1701

6985 W 153rd St

Overland Park, KS 66223

SITE:2801 NE Independence Ave Suite 201, Lee's Summit

TITLE: Battery Calculations, Riser Diagram

SCALE AT:

DATE: 8/29/2023

DESIGNED BY:

PROJECT NO:

DRAWING NO:

REVISION:

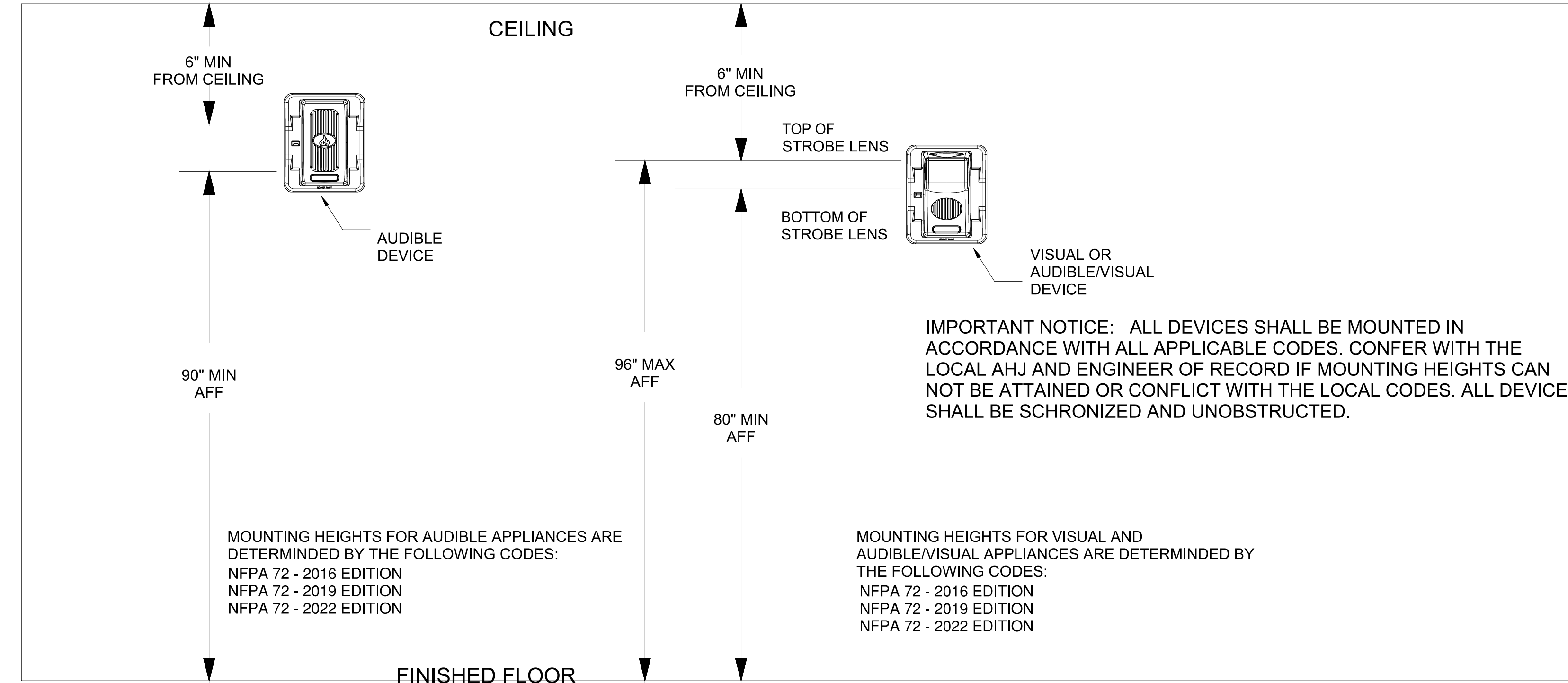
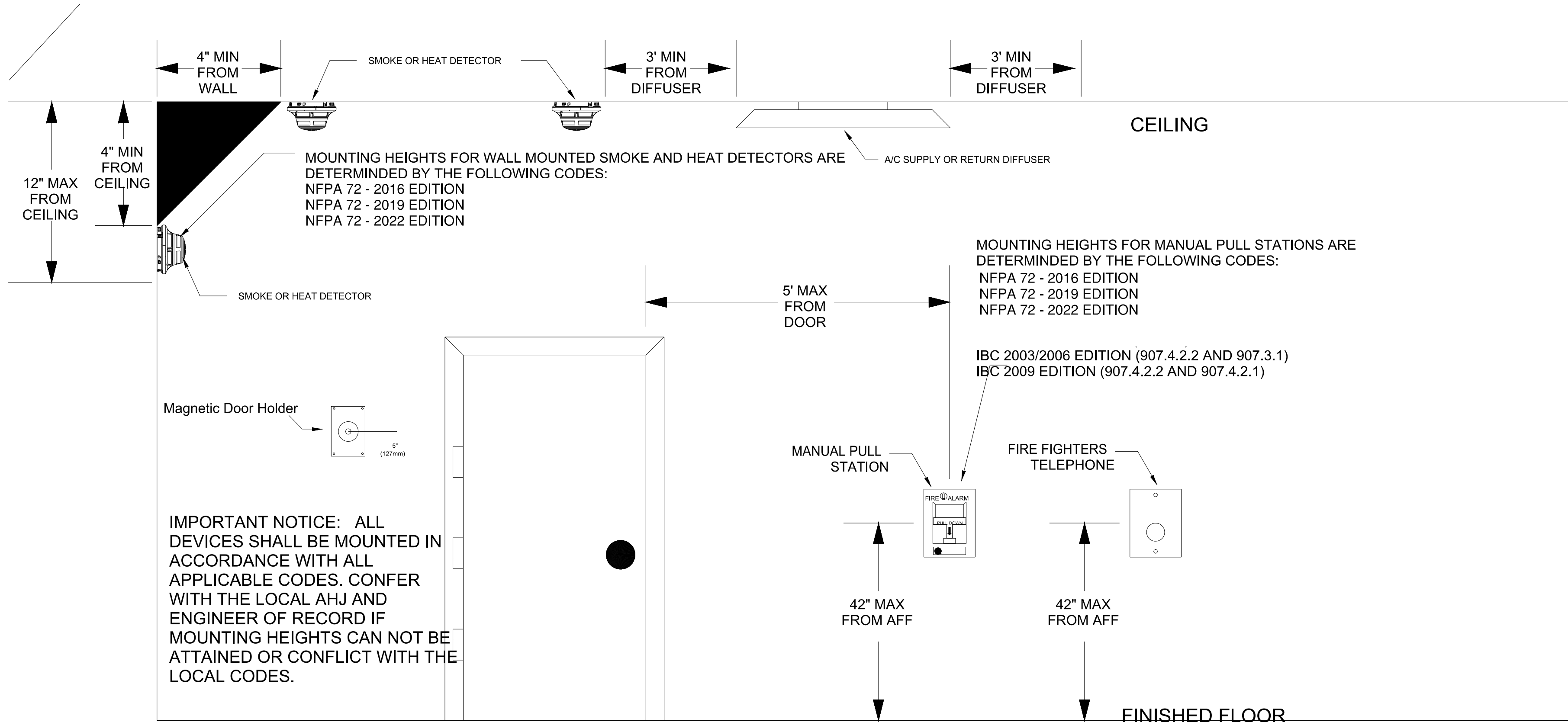

DETECTOR LOCATION REQUIREMENTS FOR WALL SECTIONS

NFPA 72

DEPTH OF WALL SECTION ABOVE DOOR	DOOR FRAME MOUNTED	SMOKE DETECTOR LISTED FOR FRAME MOUNTING OR AS PART OF CLOSER ASSEMBLY	A	B	C	D	E	F	G
d									
0 - 610 mm (0 - 24 in.) ON BOTH SIDES OF DOORWAY									
OVER 610 mm (24 in.) ON ONE SIDE ONLY									
OVER 610 mm (24 in.) ON BOTH SIDES									
OVER 1524 mm (60 in.)									

- NOTES:
1. All smoke detectors shall be located a minimum of three (3) feet from any HVAC diffuser.
 2. All manual pull stations shall be mounted four (4) feet above the finished floor (centerline of device, +or-6inches), unless otherwise noted.
 3. All strobe and horn/strobes shall be located so the bottom of the device is not less than 80 inches above the finished floor and not greater than 96 inches above the finished floor.
 4. All notification devices shall be located no less than 6 inches below finished ceilings.
 5. The candela rating of the strobes or horn/strobes shall be shown on the drawings.
 6. The location of the notification devices shall be at a uniform height for all devices.
 7. All cables, conduits, or wire mold shall be securely fastened to the structure.
 8. Smoke detectors shall be located in the ceiling no less than 4 inches from a sidewall to the nearest edge of the detector.
 9. Drawings indicate general fire alarm device locations and Field Verify device locations with minimal deviations and document any changes.
 10. FACP & Power Supplies shall be on a dedicated 120V, 20A circuit breaker marked in red with lock-on provision.
 11. Fire Alarm wire paths are reserved for fire alarm cabling only. Including all UL listed fire barrier penetrations.
 - 12.Outdoor Weatherproof Horn/Strobe is to be mounted 10' 00" AFF FDC.
 13. All ceilings are 10' or below unless otherwise noted.
 14. Default batteries are 18 - amp hour unless otherwise noted.
 15. LED Remote Test Switches are to be ceiling mounted directly below above ceiling duct detector.

GIBBENS DRAKE SCOTT, INC
Missouri State Certificate of Authority #000816
9201 E. 63rd STREET, SUITE 100
RAYTOWN, MISSOURI 64133

PROFESSIONAL ENGINEER STAMP:
JAY R. GUERRA
E-26382
9/6/2023
JAY R. GUERRA
LICENSE # E-26382

REVISIONS:	DATE:

ENVISION
TECHNOLOGY GROUP
913-491-1700
913-491-1701
6985 W 153rd St
Overland Park, KS 66223

SITE:2801 NE Independence Ave Suite 201, Lee's Summit

TITLE: NFPA 72 Reference

SCALE AT:	DATE: 8/29/2023	DESIGNED BY:
PROJECT NO:	DRAWING NO:	REVISION:

NFPA 72 Device Reference