



**LEE'S SUMMIT**  
**GRID: 0901**

94°23'19"W 38°56'7"N NAD83  
Maximo WO #: 25729568

THE ROUTE OF THE GAS SERVICE  
MUST BE BROUGHT TO GRADE AND  
CLEARED OF BUILDING MATERIAL  
BY THE CUSTOMER PRIOR TO  
INSTALLATION.

GRANULAR BACKFILL, IF REQUIRED,  
IS TO BE PROVIDED BY THE  
CUSTOMER. IN WHICH CASE, SPIRE  
WILL NOT BE RESPONSIBLE FOR  
THE DISPOSAL OF EXCESS SPOIL  
FROM THE DITCH.

SPIRE TO ONLY PATCH THAT  
PAVEMENT REMOVED FOR THE  
INSTALLATION OF THE GAS  
SERVICE.

**PIPE SYSTEM**  
PRESSURE SYS - C-012  
MINOP -  
MOP - 44 PSIG  
MAOP - 44 PSIG  
DESIGNED MAOP - 60 PSIG  
TEST PRESSURE - 100 PSIG

**CUSTOMER APPROVAL SIGNATURE:**

**GAS METER MUST COMPLY WITH  
REQUIREMENTS SHOWN BELOW**

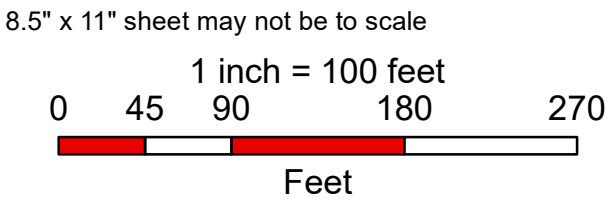
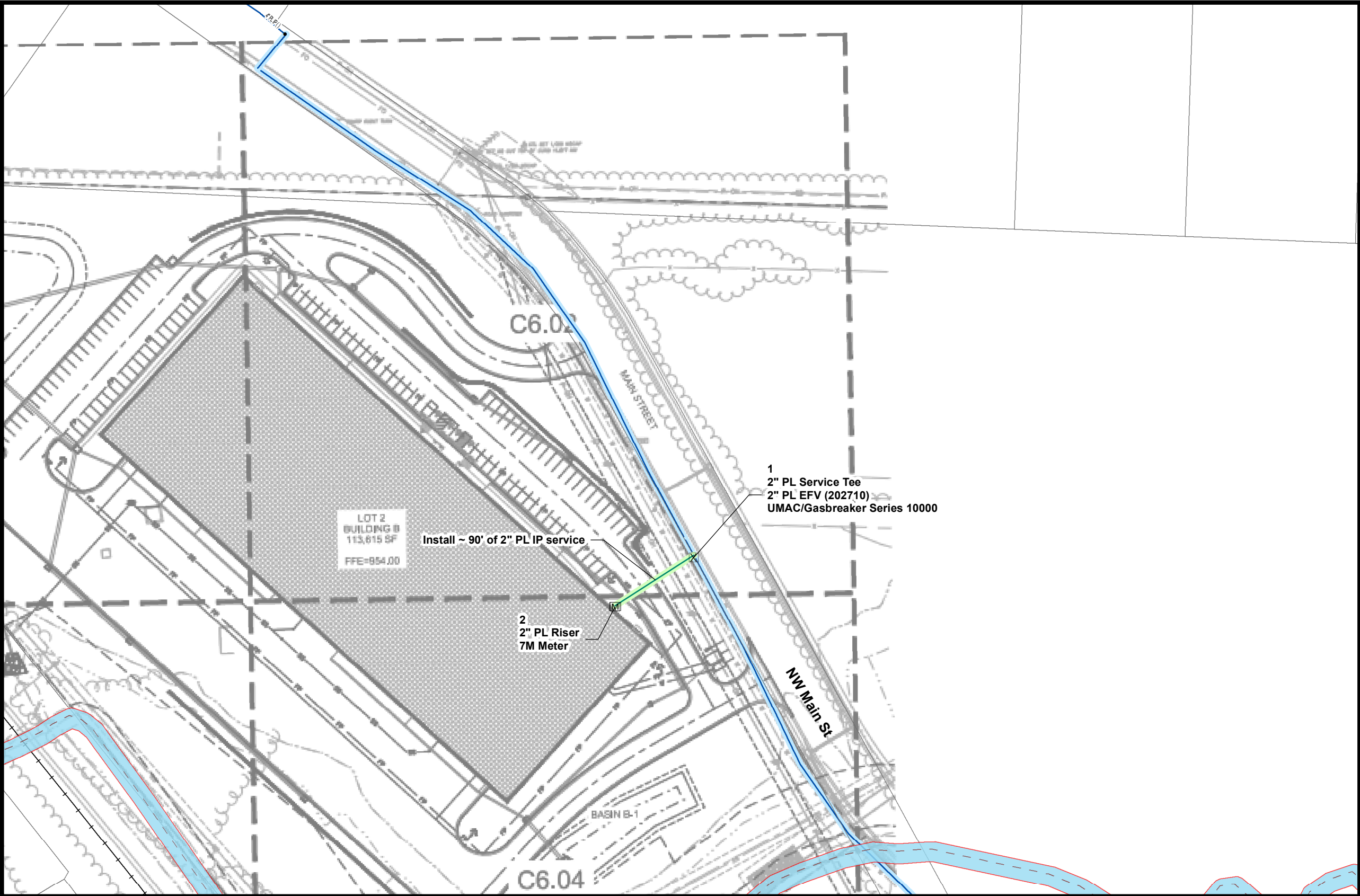
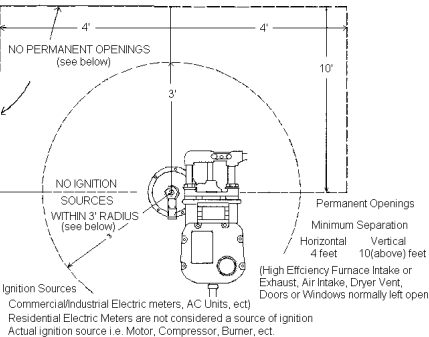

<b>DESIGNER:</b> BKW	<b>REVISION DATE(S):</b> _____ _____ _____
<b>DATE:</b> 11-21-22	_____ _____ _____



**1220 NW MAIN ST**  
**LEE'S SUMMIT**  
**TOTAL LOAD 6,400 CFH**  
**2 PSIG DELIVERY PRESSURE**