

UTILITY NOTES:

1. ALL UTILITY AND STORM SEWER TRENCHES CONSTRUCTED UNDER AREAS THAT RECEIVE PAVING SHALL BE BACKFILLED TO 18 INCHES ABOVE THE TOP OF THE PIPE WITH SELECT GRANULAR MATERIAL PLACED ON EIGHT-INCH LIFTS, AND COMPACTED TO 95% MODIFIED PROCTOR DENSITY.
2. CONTRACTOR SHALL NOT OPEN, TURN OFF, INTERFERE WITH, OR ATTACH ANY PIPE OR HOSE TO OR TAP ANY WATER MAIN BELONGING TO THE CITY UNLESS DULY AUTHORIZED TO DO SO BY THE CITY. ANY ADVERSE CONSEQUENCE OF ANY SCHEDULED OR UNSCHEDULED DISRUPTIONS OF SERVICE TO THE PUBLIC ARE TO BE THE LIABILITY OF THE CONTRACTOR. SM ENGINEERING AND OWNER ARE TO BE HELD HARMLESS.
3. ALL WATER AND SANITARY SEWER SYSTEMS THAT ARE TO BE PUBLIC LINES SHALL BE CONSTRUCTED IN ACCORDANCE WITH SPECIFICATIONS PREVIOUSLY APPROVED BY THE CITY OF LEE'S SUMMIT AND THE STATE OF MISSOURI AND SHALL BE INSPECTED BY THE CITY. IT IS THE CONTRACTOR'S RESPONSIBILITY TO ASSURE THAT THIS INSPECTION OCCURS.
4. LOCATIONS SHOWN FOR PROPOSED WATER LINES ARE APPROXIMATE. VARIATIONS MAY BE MADE, WITH APPROVAL OF THE ENGINEER, TO AVOID CONFLICTS.
5. CONTRACTOR TO INSTALL TRACING TAPE ALONG ALL NON-METALLIC WATER MAINS AND SERVICE LINES PER SPECIFICATIONS.
6. CONTRACTOR SHALL EXPOSE EXISTING UTILITIES AT LOCATIONS OF POSSIBLE CONFLICT AND POINTS OF CONNECTION PRIOR TO ANY CONSTRUCTION OF NEW UTILITIES.
7. WATER LINES SHALL HAVE A MINIMUM COVER OF 42 INCHES. ALL VALVES ON MAINS AND FIRE HYDRANT LEADS SHALL BE WITH VALVE BOX ASSEMBLIES. THE SIZE OF VALVE BOX ASSEMBLY TO BE INSTALLED IS DETERMINED BY THE TYPE AND SIZE OF VALVE. VALVE BOX CAPS SHALL HAVE THE WORD "WATER".
8. A MINIMUM HORIZONTAL DISTANCE OF 10 FEET SHALL BE MAINTAINED BETWEEN PARALLEL WATER AND SANITARY SEWER LINES. WHEN IT IS NECESSARY FOR ANY WATER LINE TO CROSS A SANITARY SEWER LINE, THE SEWER LINE SHALL BE CONSTRUCTED OF DUCTILE IRON PIPE AT LEAST 10 FEET EITHER SIDE OF THE WATER LINE UNLESS THE WATER LINE IS AT LEAST 2 FEET CLEAR DISTANCE ABOVE THE SANITARY SEWER LINE.
9. INSTALL 2" TYPE "K" COPPER FROM THE MAIN TO THE METER AND EITHER TYPE "K" OR POLYETHYLENE PLASTIC TUBING (PE 3608) FROM METER TO STOP AND WASTE VALVE INSIDE BUILDING.

DETAILS	
MS1	TRENCH AND BEDDING DETAILS
WAT-12	DCD VAULT
WAT-11	WATER SERVICE CONNECTION
WAT-7	FIRE HYDRANT
CO	CLEANOUT

NOTES

- 18A POINT OF CONNECTION - TELEPHONE SERVICE - COORDINATE WITH TELEPHONE COMPANY
- 18B UNDERGROUND TELEPHONE SERVICE PER LOCAL TELEPHONE COMPANY
- 18C 2-2" CONDUIT INSTALLED BY CONTRACTOR - TELEPHONE SERVICE
- 19A POINT OF CONNECTION - ELECTRICAL SERVICE
- 19B ELECTRICAL SERVICE (SEE NOTE 10)
- 19C 4" CONDUIT INSTALLED BY CONTRACTOR - ELECTRIC SERVICE
- 19D TRANSFORMER - PER EVERGY DETAIL 700-103
- 20A POINT OF CONNECTION - WATER SERVICE
- 20B 2-2" TAPS WITH WITH 4.0" SERVICE LINE AFTER METERS
- 20C 2-2" METERS
- 20D 6" FIRE LINE
- 60 6" SANITARY SEWER SERVICE LINE SDR-26 PVC CONNECTION SHALL BE A CUT-IN WYE
- 61 6" SANITARY SEWER SERVICE LINE SDR 26 PVC
- 20E INSTALL 8" BACKFLOW PREVENTION ASSEMBLY IN 8'X6' VAULT OR AS REQUIRED PER CLEARANCE SEE DETAIL WAT-12
- 20F 1" IRRIGATION METER & BFP
- 20H 1" WATER TAP & WATER METER
- 20G FIRE HYDRANT ASSEMBLY WITH 1-6" GATE VALVE
- 20K 5/8" TAP, METER AND BFP WITH 1" LINE AFTER METER FOR IRRIGATION

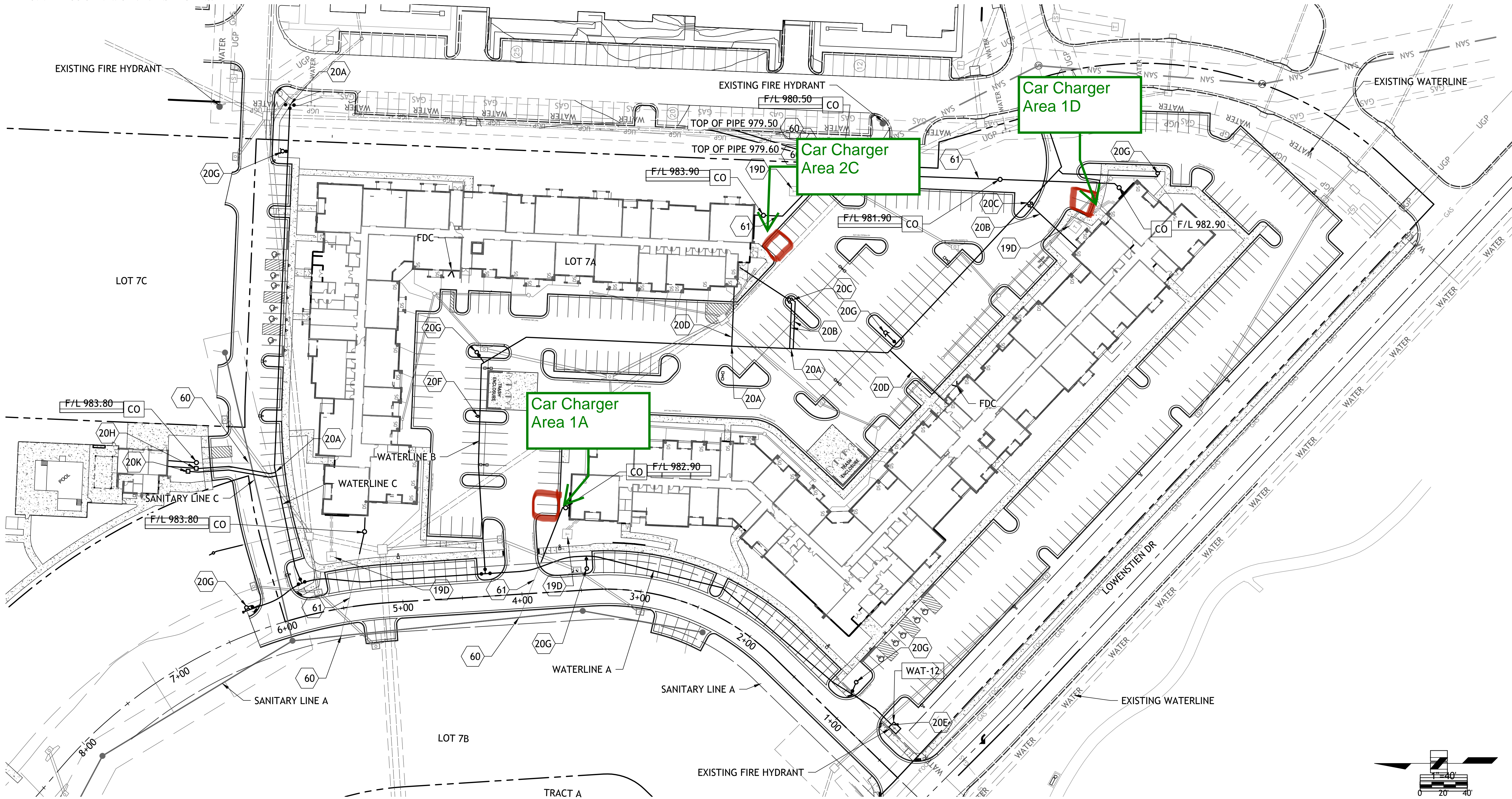

Drawings and/or Specifications are original proprietary work and property of the Engineer and intended specifically for this project. Use of items contained herein without consent of the Engineer is prohibited. Drawings illustrate best information available to the Engineer. Field verification of actual elements, conditions, and dimensions is required.



- Revisions
- 6-4-21 CITY COMMENTS
 - 6-22-21 CITY COMMENTS
 - 7-12-21 DOUBLE GRATES
 - 8-16-21 STORM SEWER
 - 10-20-21 STORM SEWER
 - 10-26-21 NE ADA RAMP
 - 11-23-21 REV. STORM LINE B
 - 1-3-22 ADA STALLS
 - 2-15-22 IRRIGATION TAP

STREETS OF W. PRYOR
LOT 7A
LEES SUMMIT, MO.