

## System Map

All replacements requests require a copy of the impacted map(s) with the location(s) of both the fault(s) and replacement(s) clearly identified.

If repair cannot be done, detail why on the Project Info tab in the "Detailed Description of Work Needed" field.

**Dig up and repair at 4 Port 17,  
move tap into easement. Pull  
in 240' UG feeder**

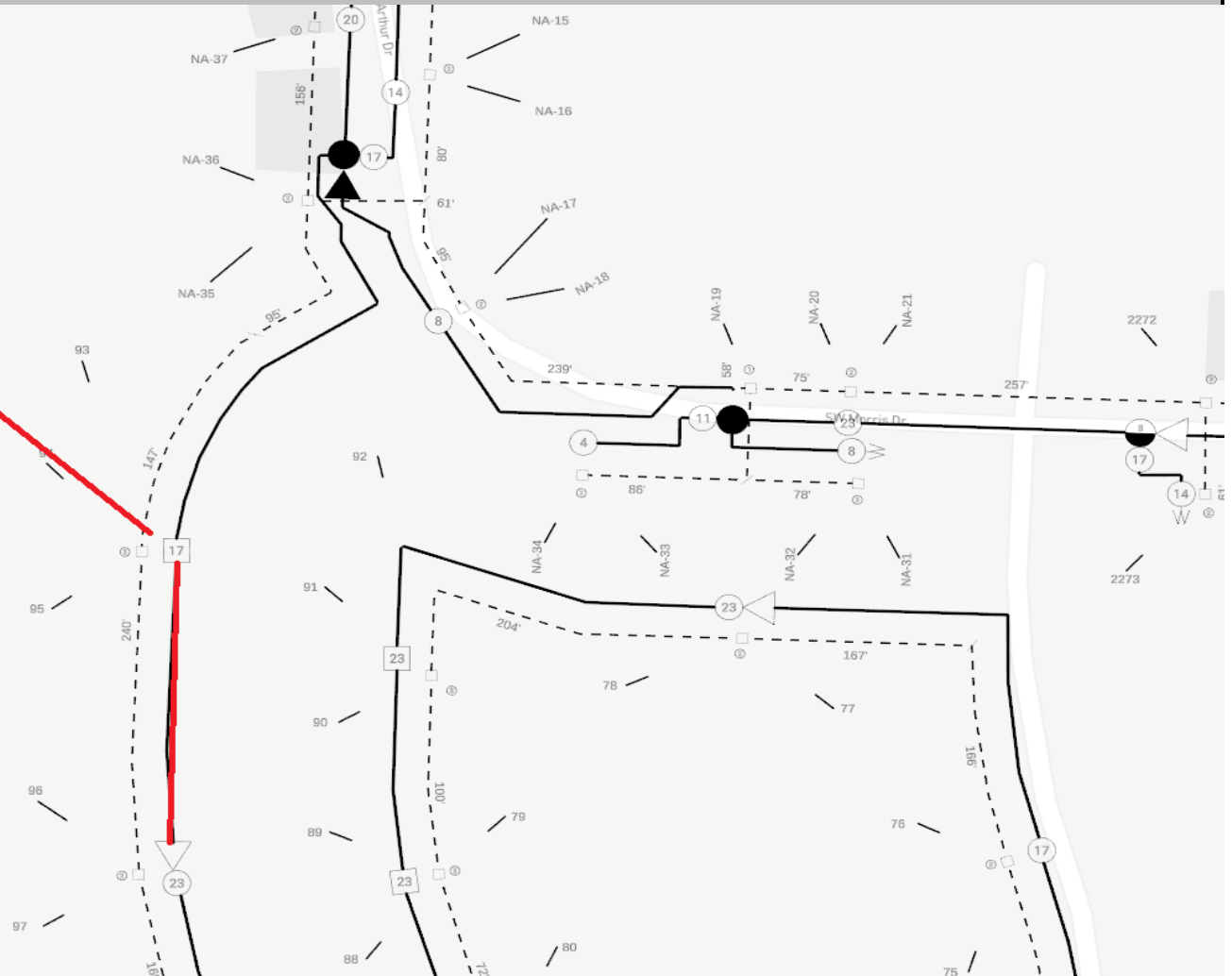

Comments for System Map