



# LEE'S SUMMIT MISSOURI

## Special Event Permit Application Form

PERMIT NUMBER: \_\_\_\_\_ RECEIPT NUMBER: \_\_\_\_\_

SPECIAL EVENT: Party in the Parking Lot

☐ Athletic Event ☐ Mobile Food Vendor ☐ Event Signage ☒ Other

EVENT DATE(S): September 10, 2023 EVENT TIME(S): 2pm to 7pm

EVENT LOCATION/ADDRESS: 354 SW BLUE PARKWAY,

LEE'S SUMMIT, MO ZONING OF PROPERTY: COMMERCIAL/  
PLANNED MIXED  
USE

APPLICANT: MARTIN CITY BREWING CO. PHONE: 816-853-0424

CONTACT PERSON: Lynne Pierce FAX: \_\_\_\_\_

ADDRESS: 354 SW BLUE PKWY CITY/STATE/ZIP: LEES SUMMIT, MO  
64063

EMAIL: Lynne.Pierce@martincitybrew.com

PROPERTY OWNER: Colliers PHONE: 816-206-8507

CONTACT PERSON: Christie Montague FAX: \_\_\_\_\_

ADDRESS: 4520 Main Street, Suite 1000 CITY/STATE/ZIP: Kansas City, MO  
64111

ATTACHED!

PROPERTY OWNER

Lynne Pierce  
APPLICANT

Print name: \_\_\_\_\_

Lynne Pierce

**Administrative Notes** (do not write below this line)

Approved Development Services Department

Development Services Department | 220 SE Green Street, Lee's Summit, MO 64063  
P: 816.969.1200 | F: 816. 969.1201 | [www.cityofls.net/Development](http://www.cityofls.net/Development)

7/21/2023

## PINE TREE PLAZA EVENT PROPOSAL

**SUNDAY, SEPTEMBER 10, 2023  
2-7PM**

On behalf of Martin City Brewing Company, Jazzy B's, Grains and Taps and additional partnering businesses in the Pine Tree Plaza development, we are proposing a block party style *Party in the Parking Lot* to take place on Sunday, September 10th from 2-7pm. This event would take place in the parking lot NW of the Martin City Brewing Company building.

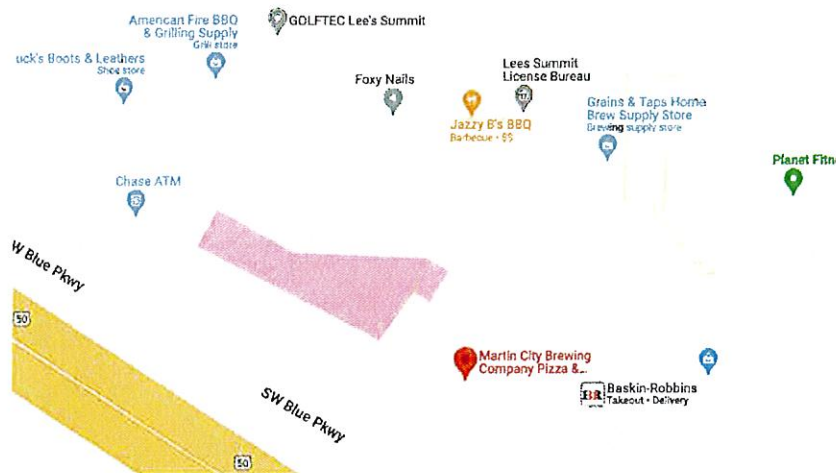

The portion of the parking lot highlighted above would be coned and roped off by 10am on the day of the event. The event would include live music, food and drink booths, carnival games and face painting for a fun, family friendly atmosphere. Expected traffic would be 200 guests at any given time throughout the day.

Banner signage to promote the event would go up on the exterior of the following buildings: Martin City Brewing Company, Grains & Taps and Jazzy B's.

*Christie W. Montague, Collins Title*  
*As Agent for Pine Tree Plaza, LLC*  
PROPERTY OWNER SIGNATURE

*Pine Tree Plaza, LLC*  
PROPERTY OWNER NAME

*7/24/23*  
DATE OF SIGNED ACKNOWLEDGMENT  
AND APPROVAL OF EVENT

Thank you,

Lynne Pierce | Creative Director | Martin City Brewing Company | 816-853-0424

# A PARTY IN THE PARKING LOT

**SUNDAY, SEPTEMBER 10, 2023 • 2-7PM**

**PINE TREE PLAZA** 354 SW Blue Pkwy, Lee's Summit, MO

**who:** Martin City Brewing Company (in partnership with Jazzy B's, Grains & Taps and other Pine Tree Plaza businesses).

**what:** Live music, food and drink booths, inflatables, face painting and a charity dunk tank will make for an afternoon of family fun and local love!

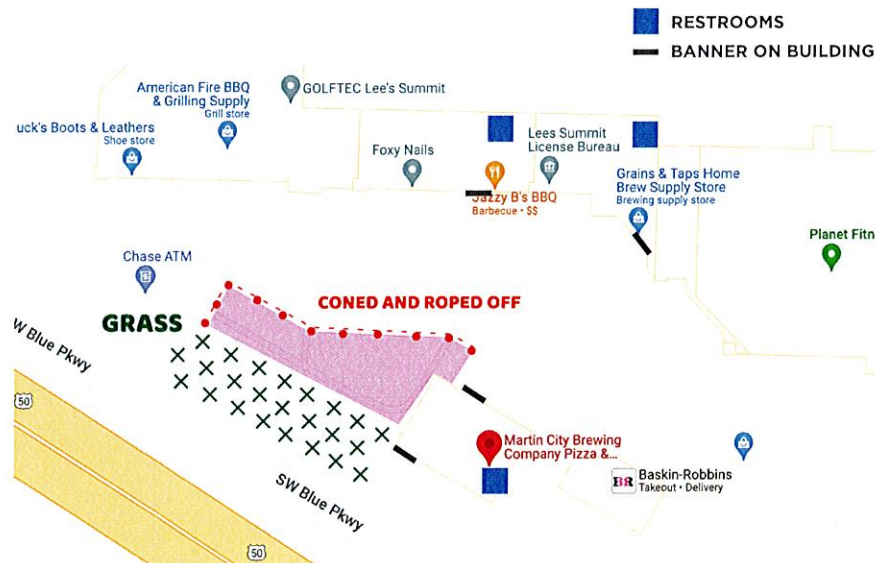

- This party will be open to the public.
- Tickets for food, drink and fun can be purchased online or at the event.
- Public restrooms will be open at 3 locations: Martin City Pizza & Taproom, Grains & Taps and Jazzy B's.
- Anticipated 200 guests throughout the event

## EVENT POINT OF CONTACT:

LYNNE PIERCE  
816-853-0424  
MARTIN CITY BREWING COMPANY  
354 SW BLUE PARKWAY, LEES SUMMIT, MO

## PROPERTY OWNER CONTACT:

CHRISTIE MONTAGUE  
816-206-8507  
COLLIERS  
4520 Main Street, Suite 1000 Kansas City, MO