

MH 1-3
 STA 12+53.49
 TOP 951.91
 FL 936.71
 FL 937.26

SAN STUB
 STA 13+40.18
 LENGTH 37.72
 RISER 3.0
 FL@MAIN 938.10
 FL@END 942.80
 MSFE 945.60

MH 1-4
 STA 15+93.47
 TOP 957.10
 FL 939.80
 FL 939.95

LEGEND

- Gas Meter
- Telephone or Fiber-Optic Pedestal
- Cable TV Pedestal
- Electric Pedestal
- Light Pole
- Mailbox
- Fire Hydrant
- Water Valve

PROPOSED HOUSE

TOP FOUNDATION = 957.00
 GARAGE FLOOR = 956.00
 TOP FOOTING = 948.00
 BASEMENT FLOOR = 948.33
 DRIVE SLOPE = 5.9%

E = EXISTING ELEVATION
 F = PROPOSED FINAL ELEVATION
 G = ADJACENT GRADE AT EGRESS
 U/E = UTILITY EASEMENT
 B/L = BUILDING LINE
 S/Y/S = SIDE YARD SETBACK
 R/Y/S = REAR YARD SETBACK

NOTES

1. BUILDER TO VERIFY ALL BUILDING ELEVATIONS AND DIMENSIONS.
2. THIS PLOT PLAN DOES NOT CONSTITUTE A BOUNDARY SURVEY.
3. THE EASEMENTS SHOWN ON THIS PLOT PLAN ARE TAKEN FROM THE FINAL PLAT. OTHER EASEMENTS MAY EXIST.

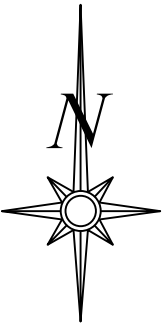

Scale 1"=30'

LOT INFORMATION

11,111 SQ. FT.
 MSFE= 945.60
 ADDRESS
 2747 SW HEARTLAND ROAD
LEGAL DESCRIPTION
 LOT 189, THE RETREAT AT HOOK FARMS SECOND PLAT, LEE'S SUMMIT, JACKSON COUNTY, MISSOURI.

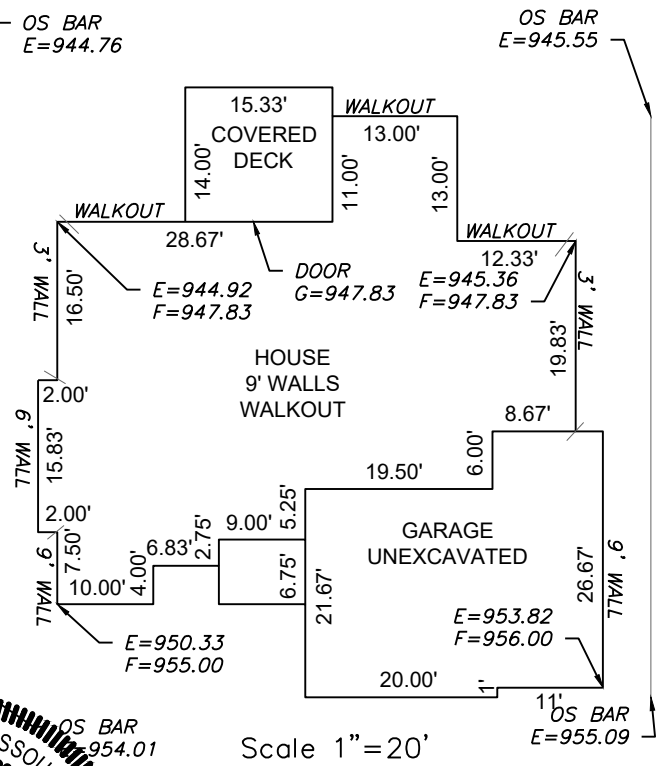

Scale 1"=20'

ENGINEERING & SURVEYING
SOLUTIONS
 50 SE 30TH STREET
 LEE'S SUMMIT, MO 64082
 P:(816) 623-9888 F:(816)623-9849
 WWW.ENGINEERINGSOLUTIONKCC.COM

STATE OF MISSOURI
 MATTHEW J. SCHLICHT
 NUMBER
 PE-2006019708
 PROFESSIONAL ENGINEER

PLOT PLAN - LOT 189
 THE RETREAT AT HOOK FARMS SECOND PLAT
 LEE'S SUMMIT, JACKSON COUNTY, MISSOURI

WALKER CUSTOM HOMES LLC
 P.O. BOX 3194
 INDEPENDENCE, MO 64064

| PROJECT NO. | FILE NAME | DATE | SHEET | OF |
|-------------|--------------------------------|--------|-------|----|
| 1 | LOT 189, RETREAT AT HOOK FARMS | 6/8/23 | 1 | 1 |

THIS DRAWING IS NOT VALID UNLESS THE SIGNATURE, DATE AND SEAL OF THE ENGINEER WHO SUPERVISED THE PREPARATION OF THIS DRAWING HAS BEEN AFFIXED HERETO.