

Amerex Pre-Engineered Fire Suppression System

Dry Chemical - Industrial System

Installation Location:

CarStar Lees Summit
2509 NE Independence
Kansas City , MO 64064

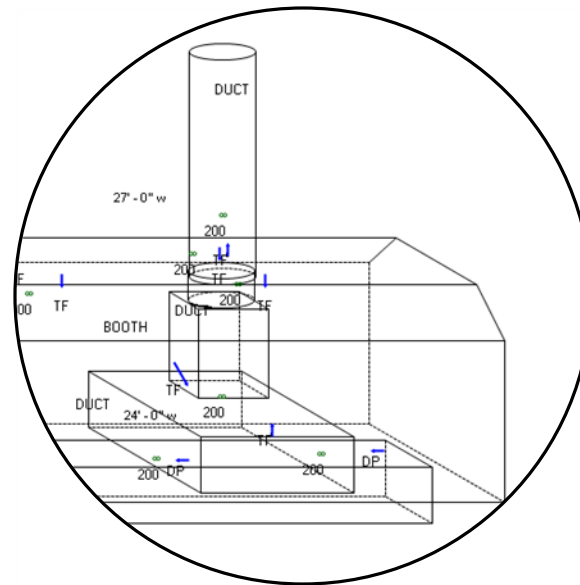

Allstate Fire Company
1030 W 23rd Suite G
Independence, MO 64055
816-463-2672
toddtompson@allstatefireco.com

Amerex Pre-Engineered Fire Suppression System

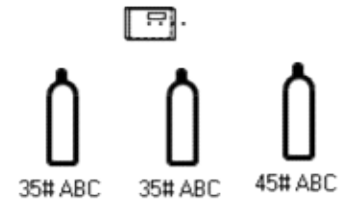
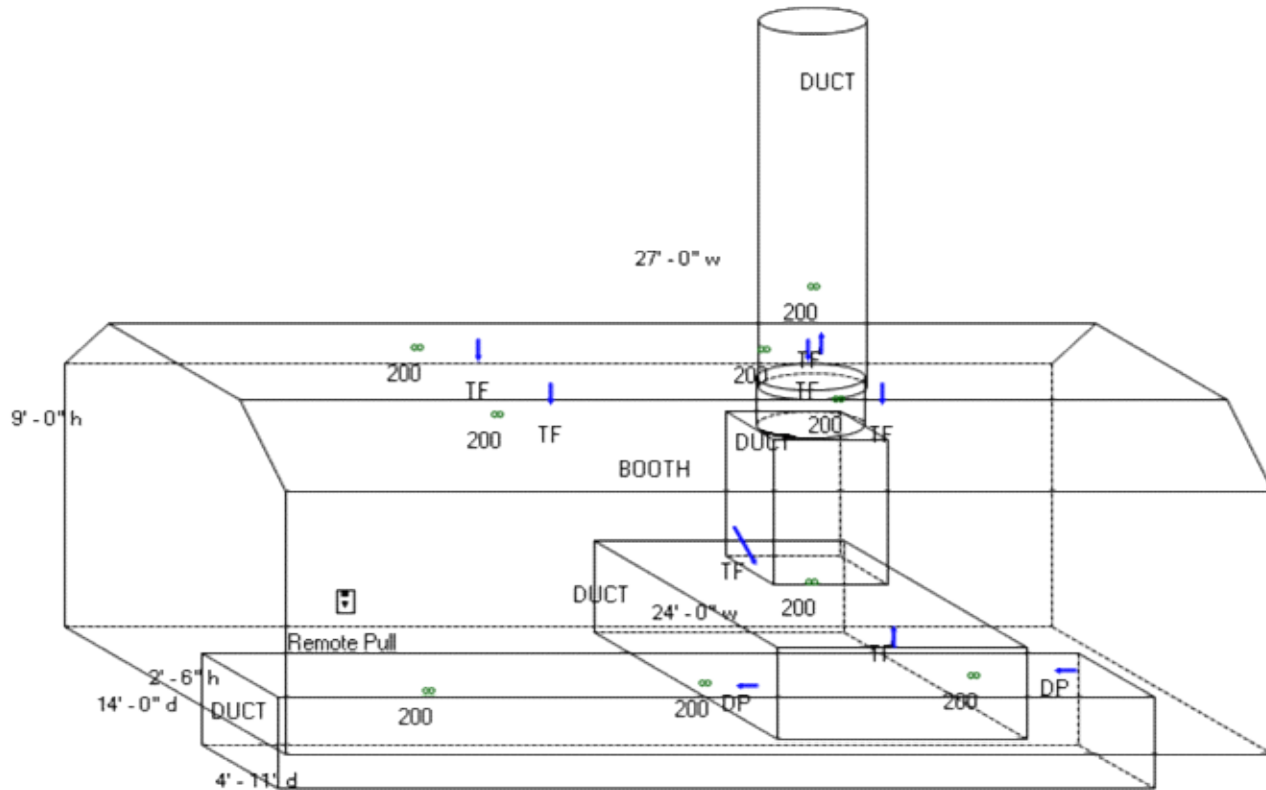

Designed & Installed by:
 Allstate Fire Company
 1030 W 23rd Suite G
 Independence, MO 64055
 816-463-2672

For:
 CarStar Lees Summit
 2509 NE Independence
 Kansas City, MO 64064

Job: Paint Booth

Date: 5/24/2023

Amerex Pre-Engineered Fire Suppression System

Notes

System Materials

Item Number	Description	Flow	Qty
16172	Total Flood (TF)	7.0	7
16190	Duct and Plenum (DP)	2.0	2
16225	JOB LINK QUICK RESPONSE (200 F / 93 C)		9
16208	AGENT CYLINDER ASY 1/2" IS45ABC		1
16207	AGENT CYLINDER ASY 1/2" IS35ABC		2
18001	MRM - Mechanical Release Module		1
11993	Manual Pull Station - English - Rectangular		1
12856	Nitrogen Cylinder - 10 in(3)		1
10180	Heavy Duty Agent Cylinder Bracket - Model IS 18		1
10181	Heavy Duty Agent Cylinder Bracket - Model IS 35/ IS 45		2
10147	Pneumatic Control Head		3
12508	Detector Bracket Assembly - Includes Bracket, Linkage & Con		9
16235	Compression Seal - 3/4" EMT		8
22279	Quick Seal Corner Pulley Adapter - Fits CP5		25
10173	Vent Check (Required on Actuation Line)		1
16444	Corner Pulley - Brooks Model CP5		25
22278	Actuation Copper Tubing - 50		15
12553	Cable, 1/16" - 500 Foot Spool		125
16386	Alarm Bell 6" 115 VAC		1
15765	Mechanical Time Delay		1

Total Flow Points: 9.0



Designed & Installed by:
 Allstate Fire Company
 1030 W 23rd Suite G
 Independence, MO 64055

For:
 CarStar Lees Summit
 2509 NE Independence
 Kansas City, MO 64064

Amerex Pre-Engineered Fire Suppression System

MECHANICAL RELEASE MODULE

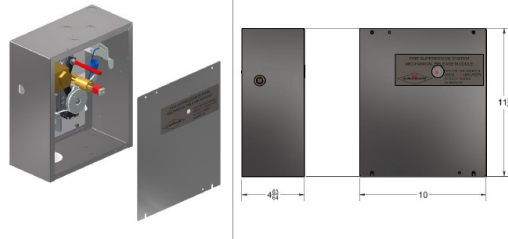

P/N: 18001

The new MRM combines the same features and functionality as the original MRM along with increased detection capabilities and far simpler means of setting the detection cable tension. The slide plate and collapsible column are now Teflon coated. The MRM is available in the above configurations, now preinstalled in its own enclosure.

Setting the detection cable tension does not require the use of any tools (once the cable is locked down into the large, knurled ratchet wheel). A large lever to the right of the ratchet wheel is used to increase the cable tension. Alignment of the bottom edge of the lever with markings on a label indicates when the proper tension has been achieved. Lowering cable tension to change out detection links is now also much simpler.

There is also a MRM available without the enclosure, P/N 11977. This has the same purpose and functionality as the MRM (P/N 18001). It is often used in conjunction with the Single

JOB LINKS

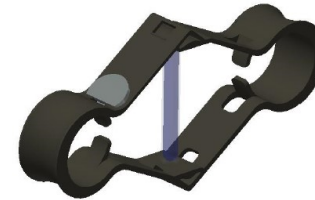

Part No.	Response	Link Rating	Max. Ambient
16225	Quick	200 F / 93 C	150 F / 66 C
16226	Quick	286 F / 141 C	225 F / 107 C
16227	Quick	360 F / 182 C	300 F / 149 C
16445	Quick	450 F / 232 C	375 F / 191 C
16446	Quick	500 F / 260 C	425 F / 218 C

Multiple temperature ratings of the Job Links are available. They are constructed of two metal struts held in tension by a small, glass bulb that ruptures at the appropriate temperature rating. The detector bracket (P/N 12508) will support either the Globe Type "K" fusible links or the Job links, and the same detector limitations apply for both types of detector.

KP600 PNEUMATIC ACTUATOR

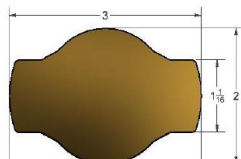

P/N: 10147

The Pneumatic Actuator is required for every pneumatically actuated. KP600 Agent Cylinder Assembly. The actuator is bolted directly to the top of the agent cylinder discharge valve. When actuation occurs at the MRM or PRM, the pneumatic pressure from the nitrogen cylinder enters the actuator through 1/2" NPT threaded ports on either side. The actuation pressure forces the piston inside to extend and depress the valve stem of the discharge valve. Resetting is easier than the previous discontinued

Vehicle Spray Booth Nozzles

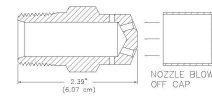

Total Flood (TF) Nozzle (P/N 16172)
This nozzle is designed for Total Flooding Application of Dry Chemical Agent into an enclosure with no more than 5% total unobscure openings. It is also used in Vehicle Paint Spray Booth and Open Front Spray Booth applications.

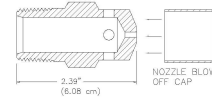

Three-Way Nozzle (P/N 16174)
This nozzle is specifically tailored for certain Vehicle Paint Spray Booth Plenum hazards.

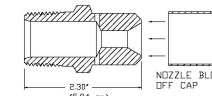

Duct and Plenum (D/P) Nozzle (P/N 16190)
This nozzle is designed to protect exhaust ducts and certain plenums in Vehicle and Open Front Spray Booths.

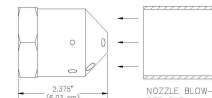

Total Flood, Perimeter, TFP (P/N 17809)
This nozzle is designed to protect the Work Area in a Vehicle Paint Spray Booth. It is also used in Total Flood applications. It is to be installed at the upper perimeter of the module being protected. The TFP nozzle contains a 1" FFF as opposed to the 1/2" MPT as found on all the other 15 nozzles.



Designed & Installed by:
Allstate Fire Company
1030 W 23rd Suite G
Independence, MO 64055

For:
CarStar Lees Summit
2509 NE Independence
Kansas City, MO 64064

Amerex Pre-Engineered Fire Suppression System

MANUAL PULL STATION

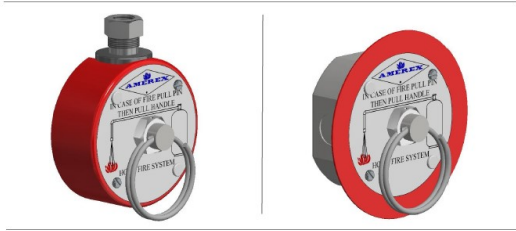

P/N: 21481

This Manual Pull Station may either be surface or recess mounted. The oversized cover is large enough to cover the sheetrock access hole for the standard 4" octagonal box and remain attractive and functional. Manual Pull Stations should be located in the path of egress and mounted at a height conforming to the local code requirements.

The surface and recess mounted pull stations are also available in French



Designed & Installed by:
Allstate Fire Company
1030 W 23rd Suite G
Independence, MO 64055

For:
CarStar Lees Summit
2509 NE Independence
Kansas City, MO 64064