

FILEPATH: C:\Users\ross\OneDrive - Schwerdt Design Group\Documents\230117 SOWP Lot 5 Core - Shell_jscZHKC2.rvt
DATE: 6/13/2023 12:50:51 PM
DRAWN BY: Author

A1 FIRST FLOOR
SCALE: 1/8" = 1'-0"

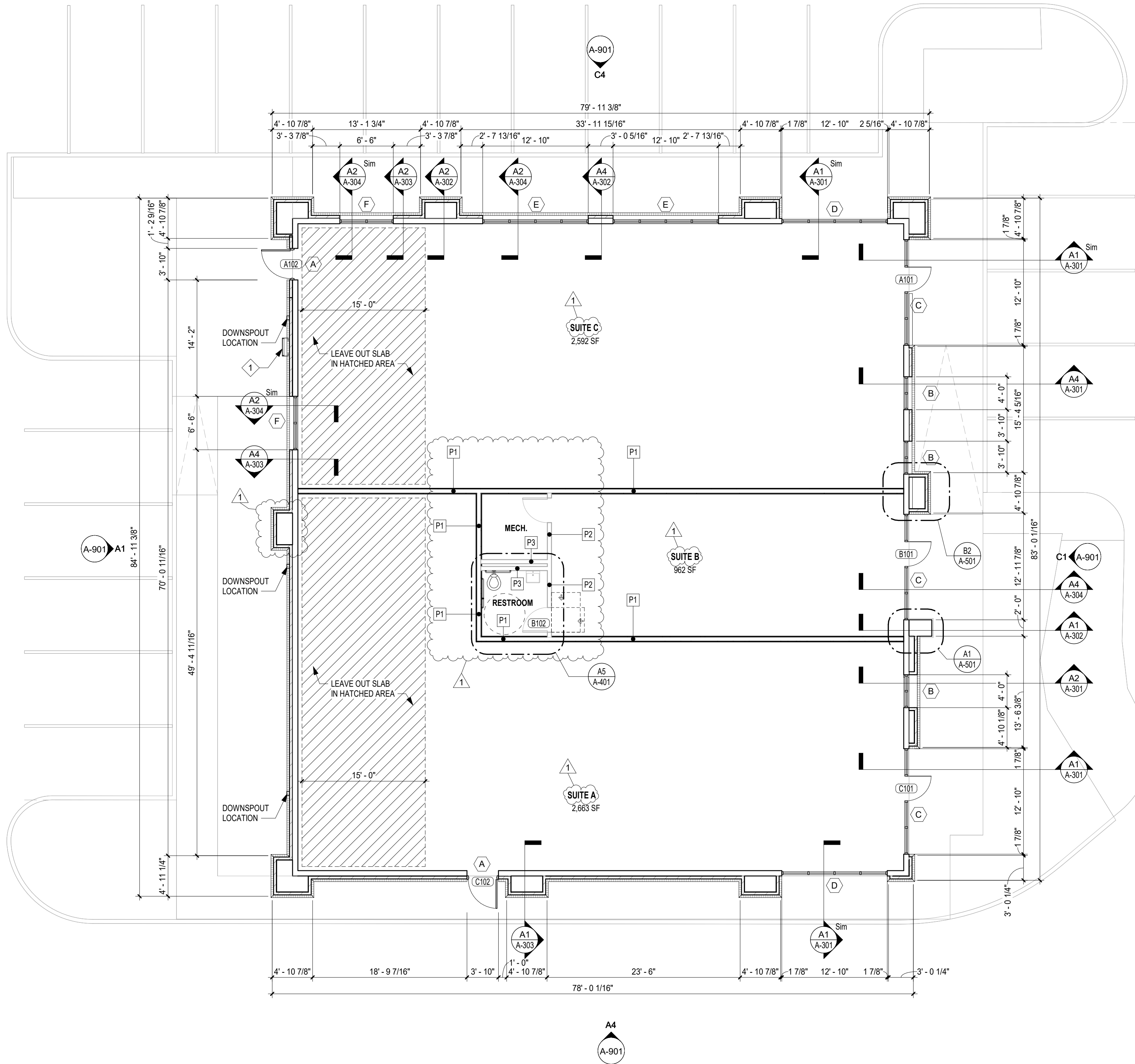

KEYED PLAN NOTES

1. LANDLORD TO PROVIDE PADLOCK FOR ROOF ACCESS LADDER AND 5 KEYS TO PADLOCK

PARTITION TYPES

2 HR WALL ASSEMBLY PER UL DESIGN NO. U301

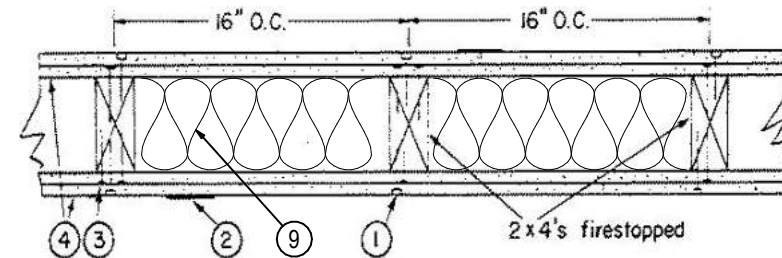

1. Nailheads — Exposed or covered with joint compound.
2. Joints — Exposed joints covered with joint compound and paper tape. Joint compound and paper tape may be omitted when square edge boards are used. As an alternate, nom 3/32 in. thick gypsum veneer plaster may be applied to the entire surface of Classified veneer baseboard with the joints reinforced with paper tape.
3. Nails — 6d cement coated nails 1-7/8 in. long, 0.0915 in. shank diam, 1/4 in. diam heads, and 8d cement coated nails 2-3/8 in. long, 0.113 in. shank diam, 9/32 in. diam heads.
4. Gypsum Board* — 5/8 in. thick, two layers applied either horizontally or vertically. Inner layer attached to studs with the 1-7/8 in. nails spaced 6 in. O.C. Outer layer attached to studs over inner layer with the 2-3/8 in. long nails spaced 8 in. O.C. Vertical joints located over studs. All joints in face layers staggered with joints in base layers. Joints of each base layer offset with joints of base layer on opposite side. When used in widths other than 48 in., gypsum board to be installed horizontally.
5. NOT USED
6. NOT USED
7. NOT USED
8. NOT USED
9. Batts and Blankets — Min. 3 in. thick glass fiber batts bearing the UL Classification Marking as to Surface Burning and/or Fire Resistance, friction-fitted to fill the stud cavities. See Batts and Blankets (BKNV or BZJZ) Categories for names of Classified companies.
10. NOT USED
11. NOT USED

NOTE: ALL PENETRATIONS THRU DEMISING WALLS MUST BE FIRESTOPPED.

P1 2HR RATED PARTITION

- NON-RATED GYPSUM BOARD PARTITION
1. 5/8" Gypsum board on each side of 3 1/2" wood studs @ 16" O.C.
 2. Water resist gyp on restroom side.

P2 NON-RATED PARTITION

PLUMBING CHASE PARTITION

1. 5/8" Gypsum board on one side only of 3 1/2" wood studs @ 16" O.C.
2. Water resist gyp on restroom side.

P3 PLUMBING CHASE PARTITION



schwerdt design group
architecture | interiors | planning
2231 sw warramaker rd suite 303
topeka, kansas 66614-4276
phone: 785.273.7540
fax: 785.273.7579

500 north broadway suite 200
oklahoma city, ok 73102
phone: 405.231.3105
fax: 405.231.3115



SCHWERDT DESIGN GROUP INC.
MO CERTIFICATE OF AUTH. #F0033876

CORE & SHELL BUILDING
STREETS OF WEST PRYOR LOT 5
2070 NW LOWENSTEIN DR, LEES SUMMIT, JACKSON COUNTY, MISSOURI 64081

SUBMISSION DATES
PROGRESS PRINT ONLY
1 ADD-1 06-02-2023

SHEET TITLE
FIRST FLOOR PLAN

PROJECT NUMBER
230117

SHEET NUMBER
A-101