

**ALL INTERIOR NON-LOAD BEARING, NON-BRACED, NON-CABINET WALLS ARE ALLOWED AT 24" OC.

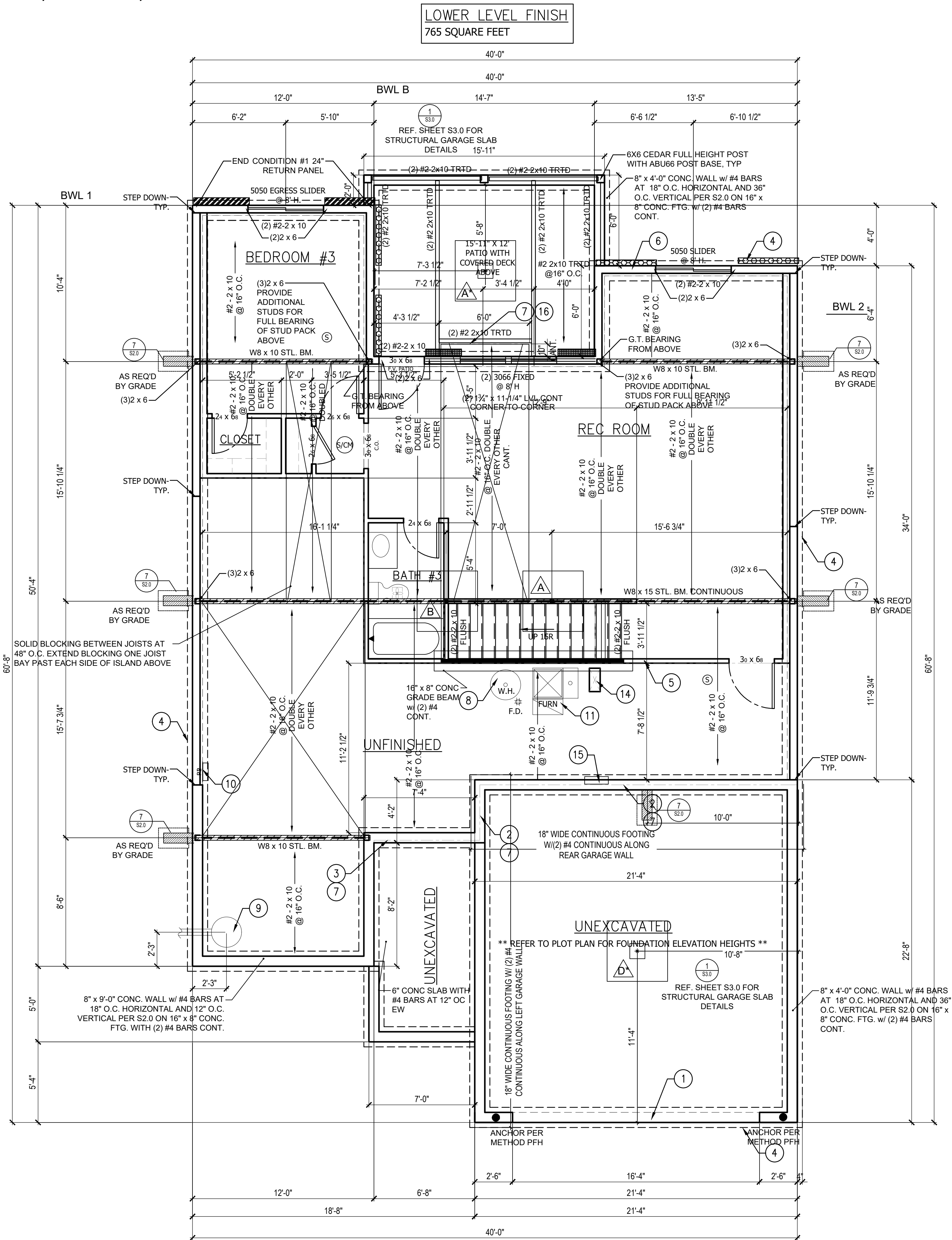

RELEASE FOR CONSTRUCTION
AS NOTED ON PLANS REVIEW
DEVELOPMENT SERVICES
LEE'S SUMMIT, MISSOURI
06/13/2023 2:40:09

FOUNDATION PLAN NOTES

1. RECESS TOP OF FOUNDATION WALL
2. HOLD SILL PLATE BACK 4"
3. HOLD SILL PLATE BACK 2"
4. CONTINUOUS CONCRETE FOOTING
5. 2X4 STUD WALL WITH TREATED SILL PLATE
6. 2X6 STUD WALL WITH TREATED SILL PLATE
7. LINE OF FLOOR ABOVE
8. THERMAL EXPANSION CONTROL DEVICE FOR WATER HEATER
9. SUMP PIT AND PUMP. PROVIDE ELECTRICAL GFCI PROTECTION. PROVIDE SLEEVE THROUGH FOOTING.
10. 200 AMP ELECTRICAL PANEL. LOCATION TO BE DETERMINED ON SITE.
11. DIRECT FURNACE. FUEL BURNING APPLIANCES SHALL BE DIRECT VENTED TO EXTERIOR FOR COMBUSTION AIR.
13. CONCRETE WINDOW WELL WITH LADDER. PROVIDE SLEEVE THROUGH WALL FOR FOUNDATION DRAIN. TOP OF WELL TO BE 3" BELOW TOP OF FOUNDATION WALL.
14. HVAC CHASE ABOVE
15. 'UFER' GROUND. VERIFY LOCATION WITH PROJECT MANAGER.
16. INSULATE CANTILEVER AS REQUIRED PRIOR TO BLOCKING.

GENERAL NOTES:

BACK WATER VALVES REQUIRED ON ALL BASMENT PLUMBING FIXTURES. PROVIDE MEANS OF CONTROLLING PRESSURE CAUSED BY THERMAL EXPANSION.

SUMP PIT SHALL BE EQUIPPED WITH A PUMP AND RECEPTACLE. IN UNFINISHED PORTIONS OF BASEMENT, RECEPTACLES SHALL HAVE GFI PROTECTION.

ALL SILLS & SLEEPERS SUPPORTED ON CONCRETE OR MASONRY SHALL B OF DECAY-RESISTANT MATERIALS.

DIMENSIONAL LUMBER IS LABELED PER INDUSTRY STANDARD TERMINOLOGY. ACTUAL LUMBER SIZING IS EXPECTED TO VARY PER VENDOR.

NON-BEARING WALLS TO BE BUILT WITH 1" GAP BETWEEN TOP PLATE AND FLOOR JOISTS TO PREVENT HEAVING.

SMOKE AND CARBON MONOXIDE DETECTORS SHOWN ON PLANS ARE TO BE CONSIDERED RECOMMENDATIONS ONLY. FINAL PLACEMENT IS TO BE DETERMINED BY MUNICIPAL REQUIREMENTS.

WINDOW SIZES ARE WRITTEN IN FEET AND INCHES PER INDUSTRY STANDARDS. EX: 3050 SH = 3'-0" X 5'-0" SINGLE HUNG, 3066 FIX = 3'-0" X 6'-6" FIXED.

CPG DBA



120 SE 30TH ST.
LEE'S SUMMIT, MO 64082
816-246-6700

COPYRIGHT 2017

THIS DRAWING HAS BEEN PREPARED BY SUMMIT HOMES, OR UNDER THEIR DIRECT SUPERVISION AS AN INSTRUMENT OF SERVICE AND IS INTENDED FOR USE ONLY ON THIS PROJECT. ALL DRAWINGS, SPECIFICATIONS, AND DESIGNS, INCLUDING THE OVERALL LAYOUT, FORM, AND COMPOSITION OF SPACES ARE PROTECTED BY COPYRIGHT REGISTERED TO CPG, INC. ANY REPRODUCTION, USE, OR DISCLOSURE OF THE INFORMATION CONTAINED HEREIN WITHOUT THE WRITTEN CONSENT FROM CPG, INC. DBA SUMMIT HOMES EXCEPT AS REQUIRED FOR BIDDING AND CONSTRUCTION OF THIS PROJECT IS STRICTLY PROHIBITED.

PALERMO
MEDITERRANEAN
WOODSIDE RIDGE #37
2125 NW ASHURST DR
LEE'S SUMMIT, MO

PROFESSIONAL SEAL:

ISSUE DATE:
06.13.23

SHEET NUMBER:

A3

FOUNDATION PLAN 1
SCALE: 1/4" = 1'-0"