



LEE'S SUMMIT, MISSOURI FIRE DEPARTMENT

Hazardous Material Permit Application

Name of Business: Westlake Ace Hardware Phone: 913-336-3511
Address/Location: 3511 SW Market St. Lees Summit, MO 64082 Apt/Suite: _____
Applicant's Name: Jeremy Romig Phone: 816-716-9365
Mailing Address: 14000 Marshall Dr. Title: Construction Manager
City, State, Zip: Lenexa, KS 66215
Type of Business: Hardware Store

TYPE OF MATERIAL(S)

- | | |
|---|---|
| <input type="checkbox"/> Explosives/Blasting Agents | <input type="checkbox"/> Reactive Materials |
| <input type="checkbox"/> Compressed Gases | <input type="checkbox"/> Cryogenics |
| <input checked="" type="checkbox"/> Flammable/Combustible Liquids | <input type="checkbox"/> Highly Toxic |
| <input type="checkbox"/> Flammable Solids | <input type="checkbox"/> Radioactive |
| <input type="checkbox"/> Organic Peroxides | <input type="checkbox"/> Corrosive |
| <input type="checkbox"/> Oxidizers | <input type="checkbox"/> Carcinogens |
| <input type="checkbox"/> Pyrophoric Materials | <input type="checkbox"/> Other (List) |

QUANTITIES OF MATERIAL(S):			Quantity	Extremely Hazardous
Substance (Name)	CAS#	UN#	(pounds)	Substances
Propane	74-98-6	1978	2100	<input type="checkbox"/>
				<input type="checkbox"/>
				<input type="checkbox"/>
				<input type="checkbox"/>
				<input type="checkbox"/>
				<input type="checkbox"/>

* Submit Material Safety Data Sheets (MSDS) with application

* Submit sight plan with application

For Questions Contact Assistant Chief Jim Eden at (816) 969-1303



**LEE'S SUMMIT, MISSOURI
FIRE DEPARTMENT**

Hazardous Material Permit Application

CONDITIONS OF USAGE: Explain the use(s) of the substance.

Propane fill station

CONTAINMENT: Explain (if any) the containment measures that are used.

Contained in 500 gallon tank on 4" slab protected by schedule 40 steel bollards.

Jeremy Romig

Signature (owner/agent)

2023May11

Date

Jeremy Romig

PRINT NAME

For Questions Contact Assistant Chief Jim Eden at (816) 969-1303



**LEE'S SUMMIT, MISSOURI
FIRE DEPARTMENT**

Hazardous Material Permit Application

FOR OFFICE USE ONLY

Hazard Assessment Required: Yes ☐ No ☐

Shift _____

Sent to LEPC: Yes ☐

PFA Assigned: ☐

Plans Required: Yes ☐ No ☐

Application: Approved ☐ Denied ☐

Date: _____

By: _____

PFA Number: _____

Date Issued: _____

Comments:

Reviewed by: _____ Rank: _____

For Questions Contact Assistant Chief Jim Eden at (816) 969-1303

Ferrellgas Material Safety Data Sheet - Propane

Ferrellgas

One Liberty Plaza

Liberty, MO 64068

Section 1: Emergency Information

24 Hour Emergency Number

Call 1-800-424-9300 (Chemtrec) in case of emergencies involving propane.

Warning!

Extremely flammable compressed gas.

- Asphyxiant in high concentrations.
 - Skin contact with liquid causes burns similar to frostbite.
 - Ethyl mercaptan used as a warning agent may not be entirely effective in all situations.
- Read the warnings in section 9.

NFPA hazard rating

Hazard ratings are in the following table

Health hazard = 1

Fire hazard = 4

Reactivity = 0

Where:

0 = Least

1 = Slight

2 = Moderate

3 = High

4 = Extreme



General MSDS assistance

Call 816-792-1600 and ask to speak with the Safety Department for general assistance with questions about this MSDS.

Section 2: Hazardous Components/Identity Information

Product

Propane (odorized)

Chemical name

Propane

Chemical family

Liquefied Petroleum Gas (Paraffinic Hydrocarbons)

Hazardous components

Propane may contain various percentages of these hazardous components, depending on the source of supply.

Component	CAS Number	Percentage
Propane	74-98-6	85 - 100
Propylene	115-07-1	0 - 15
Butane and heavier	106-97-8	0 - 2.5
Ethane	74-84-0	0 - 5
Ethyl Mercaptan (Odorant)	75-08-1	<0.0025

Section 3: Health Information

Purpose The health effects are consistent with requirements of the OSHA Hazard Communication Standard (29 CFR 1910.1200).

Eye contact Direct contact with liquid propane can result in eye burns.

Skin contact Direct contact with liquid propane can result in skin burns (frostbite).

Inhalation This product is classified as a simple asphyxiant.
High vapor concentrations may produce a reversible central nervous system depression (anesthesia).
Higher concentrations may produce asphyxiation.

Ingestion Ingestion is not likely.

Signs and symptoms Eye or skin burns (frostbite) as noted previously.
Early to moderate central nervous system depression may be evidenced by giddiness, headache, dizziness and nausea. In extreme cases, unconsciousness may occur.
Asphyxiation may be noted by a sudden loss of consciousness. Death may quickly follow.

Aggravated medical conditions Caution is recommended for personnel with pre-existing central nervous system or chronic respiratory diseases.

Acute toxicity data Acute toxicity data is not applicable to this product.

Carcinogenicity This product is not classified as a carcinogen.

Occupational exposure limits Use this table to determine the allowable exposure limits for personnel.

OSHA		ACGIH	
PEL/TWA	PEL/Ceiling	TLV/TWA	TLV/STEL
Propane: 1,000 PPM Butane: 800 PPM	Not established	Butane: 800 PPM	Not established

Cardiac effects While there is no evidence that exposure to industrially acceptable levels of hydrocarbons have produced cardiac effects in humans, animal studies have shown that inhalation of high vapor levels of the components of this product have produced cardiac sensitization. Such sensitization may cause fatal changes in heart rhythms. This latter effect was shown to be enhanced by hypoxia or the injection of adrenaline-like agents.

Effects of propylene Laboratory animals exposed to high levels of propylene for prolonged periods of time showed evidence of effects in the liver, kidneys, and nasal cavity.

Section 4: Emergency and First Aid Procedures

Purpose	Follow these procedures in case of personal injuries resulting from use of this product.
Eye contact with liquid	Flush eyes with water. Get medical attention.
Skin contact with liquid	Flush with water. If frostbite or burn occurs, get medical attention.
Inhalation	Remove victim to fresh air and provide oxygen if breathing is difficult. Seek immediate medical attention if victim is not breathing. Give artificial respiration.
Ingestion	Not applicable to this product.

Section 5: Physical Data

Physical properties	Refer to this table for the physical properties of this product.
----------------------------	--

Property	Value
Appearance and odor	Colorless gas, liquid under pressure. Mercaptan "rotten cabbage" odor
Boiling point	-44 degrees F.
Evaporation rate (Butyl Acetate = 1)	<1 (diffuses readily)
Flash point	-156 degrees F.
Liquid to vapor expansion ratio	1:270
Molecular weight	44.096
Solubility in water	Slight
Specific gravity (liquid)	0.500 - 0.510 (Water = 1)
Specific gravity (vapor)	1.52 (Air = 1)
Vapor pressure (maximum)	208 PSIG @ 100 degrees F.

Section 6: Fire and Explosion Hazards

Flammability limits	Flammability limits by volume in air. <ul style="list-style-type: none">• Lower 2.15 percent• Upper 9.6 percent
Ignition temperature	Auto Ignition temperature is 940 degrees, F.
Extinguishing media	Allow product to burn if source cannot be shut off safely. <ul style="list-style-type: none">• Class B-C or A-B-C dry chemical or halon extinguishers can be used on small fires.• Apply water from a safe distance to cool containers, surrounding equipment, and structures.

4

Continued on next page

Section 6: Fire and Explosion Hazards, Continued

Special fire fighting procedures and precautions	Extremely flammable. Containers may explode if not sufficiently cooled with water spray. Evacuate surrounding area of unprotected personnel and isolate. Do not enter confined fire space without full bunker gear (helmet with face shield, bunker coats, gloves, and rubber boots) and a positive pressure NIOSH approved self-contained breathing apparatus.
---	--

Section 7: Reactivity

Stability and hazardous polymerization	This product is stable. Hazardous polymerization will not occur.
Conditions and materials to avoid	Avoid heat, sparks, flame and contact with strong oxidizing agents. Avoid buildups of static electricity. <ul style="list-style-type: none">• Prevent vapor accumulation.
Hazardous decomposition products	Carbon monoxide and unidentified organic products may be formed during combustion.

Section 8: Employee Protection

Respiratory protection	Use a NIOSH approved respirator as required when airborne exposure limits are exceeded. <ul style="list-style-type: none">• In accord with 29 CFR 1910.134, use either an atmosphere supplying respirator or an air purifying respirator for organic vapors.
Protective clothing	Avoid liquid contact with eyes or skin. <ul style="list-style-type: none">• Wear safety glasses or goggles as appropriate.• Wear protective clothing as appropriate.
Additional protective measures	Use explosion-proof ventilation as required to control vapor concentrations.

Section 9: Precautions For Safe Handling and Use

Release, spill or leak procedures	Warning! Extremely flammable. <ul style="list-style-type: none">• Eliminate sources of ignition.• Isolate hazard area and deny entry to unnecessary or unprotected personnel.• Stay upwind and keep out of low areas.• Notify local fire department.• Disperse vapor clouds with water spray.• Shut off source of leak only if it can be done safely.
--	---

Continued on next page

Section 9: Precautions For Safe Handling and Use, Continued

Training	<p>Train all personnel involved in handling propane in proper handling and operating procedures.</p> <ul style="list-style-type: none">• Document all training.
Handling and storing	<p>Handle and store propane in accordance with NFPA 58 and local fire codes.</p> <ul style="list-style-type: none">• Keep containers away from heat sources or temperatures exceeding 130 degrees F.• Do not drop or roll any container.• Store and transport containers with relief valves in vapor space.• Keep all container valves closed when not in use.• Keep protective caps (if applicable) on containers when not in use.
DOT cylinders	<p>Take these precautions when using DOT cylinders.</p> <ul style="list-style-type: none">• Periodically inspect and requalify DOT cylinders in accordance with DOT and NFPA 58 codes and Compressed Gas Association Pamphlets C-6 and C-6a.• Store and use cylinders with valves off and the relief valves in the container vapor space.• Shut all valves and follow recommended procedures before exchanging cylinders.
Special precautions	<p>Containers, even those that have been emptied, can contain explosive vapors.</p> <ul style="list-style-type: none">• Do not cut, drill, grind, weld or perform similar operations on or near containers.
Propane odorization	<p>Warning! Any smell of odorant, even a faint one, may indicate a dangerous situation.</p> <p>Ethyl mercaptan is the preferred warning agent for propane. Although ethyl mercaptan has excellent warning properties, "It is recognized that no odorant will be completely effective as a warning agent in every circumstance" (NFPA 58 A-1-4.1, 1992 edition).</p> <p>Instances in which odorants may lose their effectiveness include, but are not limited to:</p> <ul style="list-style-type: none">• Odor may fade due to chemical oxidation in improperly prepared new tanks and cylinders or from rust, air, and water in used containers that have been allowed to stand open to the atmosphere.• Odor may be absorbed and adsorbed by the walls of containers and distribution systems.• Odor in the gas escaping from underground leaks may be absorbed by certain types of soils.• Effectiveness of the odorant may be reduced by cold temperatures.• Other odors, such as from cooking or from a musty basement, may mask or cover up the mercaptan odor in propane.• Exposure to the mercaptan odor of propane for extended periods of time may affect a person's ability to detect the odorant.• Physical disabilities or the use of alcohol, tobacco, or drugs may decrease a person's ability to detect the odorant.

Section 10: Transportation Requirements

DOT shipping name	Liquefied Petroleum Gas
DOT classification	Division 2.1 (Flammable Gas)
Other transportation requirements	UN 1075, Hazardous Materials Guide Number 115. North American Industrial Classification System (NAICS) Number 454312

Section 11: Other Regulatory Controls

EPA/TSCA The components of this product are listed on the EPA/TSCA inventory of chemical substances.

EPA Hazard Classification This product is classified by 40 CFR 372 (SARA Section 313) as:

Acute Hazard	Chronic Hazard	Fire Hazard	Pressure Hazard	Reactive Hazard
XXX		XXX	XXX	

Ozone depleting substances This product does not contain, nor was it directly manufactured with, any class I or class II ozone depleting substances.

RCRA Information This product is not subject to 40CFR 268.30 ban on the disposal of hazardous wastes. If this product becomes a waste material, it would be an ignitable hazardous waste, having a waste code number D0001. Refer to latest EPA or state regulations regarding proper disposal. Under EPA-RCRA, containers are considered hazardous unless depressurized to a pressure approaching atmospheric. Depressurize containers at a controlled rate to a flare.

State regulatory information The ingredients in this product are specifically listed by individual states; other product specific health and safety data in other sections of the MSDS may also be applicable for state requirements.

- Contact the appropriate agency in your state for details on your regulatory requirements.

California Proposition 65 warning Chemicals known to the State of California to cause cancer, birth defects, or other reproductive harm are created by the combustion of propane.

Section 12: Supplemental Information

Disclaimer of liability The information in this MSDS was obtained from sources which we believe are reliable. **However, the information is provided without any warranty, express or implied, regarding its correctness.**

The conditions or methods of handling, storage, use and disposal of this product are beyond our control and may be beyond our knowledge. **For this and other reasons, we do not assume responsibility and expressly disclaim liability for loss, damage, or expense arising out of or in any way connected with the handling, storage, use, or disposal of this product.**

Issue information This MSDS supersedes all previous editions.

- Issued May, 2011
- Issued by: Scott Fenimore, Manager of Safety
Ferrellgas
One Liberty Plaza
Liberty, MO 64068

LEGAL DESCRIPTION:

LOT 2, MARKET STREET CENTER SECOND PLAT, A PLATTED SUBDIVISION OF LAND IN THE CITY OF LEE'S SUMMIT, JACKSON COUNTY, MISSOURI
AREA = ±2.58 ACRES / ± 112,481 SQ.FT.

SITE PLAN NOTES:

- All construction materials and procedures on this project shall conform to the latest revision of the following governing requirements, incorporated herein by reference:
A) City ordinances & O.S.H.A. Regulations.
B) The City of Lee's Summit Technical Specifications and Municipal Code.
- The contractor shall have one (1) signed copy of the plans (approved by the City) and one (1) copy of the appropriate Design and Construction Standards and Specifications at the job site at all times.
- The contractor will be responsible for securing all permits, bonds and insurance required by the contract documents, City of Lee's Summit, Missouri, and all other governing agencies (including local, county, state and federal authorities) having jurisdiction over the work proposed by these construction documents. The cost for all permits, bonds and insurance shall be the contractors' responsibility and shall be included in the bid for the work.
- The contractor is responsible for coordination of his and his sub-contractor's work. The contractor shall assume all responsibility for protecting and maintaining his work during the construction period and between the various trades/sub-contractors constructing the work.
- The demolition and removal (or relocation) of existing pavement, curbs, structures, utilities, and all other features necessary to construct the proposed improvements, shall be performed by the contractor. All waste material removed during construction shall be disposed off the project site. The contractor shall be responsible for all permits for hauling and disposing of waste material. The disposal of waste material shall be in accordance with all local, state and federal regulations.
- Contractor shall be responsible for all relocations, including but not limited to, all utilities, storm drainage, sanitary sewer services, signs, traffic signals & poles, etc. as required. All work shall be in accordance with governing authorities specifications and shall be approved by such. All cost shall be included in base bid.
- All existing utilities indicated on the drawings are according to the best information available to the Engineer; however, all utilities actually existing may not be shown. The contractor shall be responsible for contacting all utility companies for an exact field location of each utility prior to any construction. All underground utilities shall be protected at the contractor's expense. All utilities, shown and unshown, damaged through the negligence of the contractor shall be repaired or replaced by the contractor at his expense.
- The contractor will be responsible for all damage to existing utilities, pavement, fences, structures and other features not designated for removal. The contractor shall repair all damages at his expense.
- The contractor shall verify the flow lines of all existing storm or sanitary sewer connections and utility crossings prior to the start of construction. Notify the engineer of any discrepancies.
- SAFETY NOTICE TO CONTRACTOR:** In accordance with generally accepted construction practices, the contractor shall be solely and completely responsible for conditions of the job site, including safety of all persons and property during performance of the work. This requirement will apply continuously and not be limited to normal working hours. Any construction observation by the engineer of the contractor's performance is not intended to include review of the adequacy of the contractor's safety measures, in, on or near the construction site.
- Refer to the building plans for site lighting electrical requirements, including conduits, pole bases, pull boxes, etc.

SITE DIMENSION NOTES:

- BUILDING TIES SHOWN ARE TO THE OUTSIDE FACE OF PROPOSED WALLS. THE SUBCONTRACTOR SHALL REFER TO THE ARCHITECTURAL PLANS FOR SPECIFIC DIMENSIONS AND LAYOUT INFORMATION FOR THE BUILDINGS.
- ALL DIMENSIONS SHOWN FOR THE PARKING LOT AND CURBS ARE MEASURED FROM BACK OF CURB TO BACK OF CURB.

PAVEMENT MARKING AND SIGNAGE NOTES:

- PARKING STALL MARKING STRIPES SHALL BE FOUR INCH (4") WIDE, WHITE STRIPES. DIRECTIONAL ARROW AND HANDICAP STALL MARKINGS SHALL BE FURNISHED AT LOCATIONS SHOWN ON PLANS.
- HANDICAP PAVEMENT MARKINGS AND SIGNS SHALL CONFORM TO ALL FEDERAL (AMERICANS WITH DISABILITIES ACT) AND STATE LAWS AND REGULATIONS.
- TRAFFIC CONTROL DEVICES AND PAVEMENT MARKINGS SHALL CONFORM TO THE REQUIREMENTS OF THE "MANUAL OF UNIFORM TRAFFIC CONTROL DEVICES".
- STOP SIGNS SHALL BE PROVIDED AT ALL LOCATIONS AS SHOWN ON PLANS AND SHALL CONFORM TO THE "MANUAL OF UNIFORM TRAFFIC CONTROL DEVICES". SIGNS SHALL BE 18" X 12", 18 GAUGE STEEL AND SHALL BE ENGINEER GRADE REFLECTIVE.
- TRAFFIC CONTROL AND PAVEMENT MARKINGS SHALL BE PAINTED WITH A WHITE SHERWIN WILLIAMS S-W TRAFFIC MARKING SERIES B-2912 OR APPROVED EQUAL. THE PAVEMENT MARKING SHALL BE APPLIED IN ACCORDANCE WITH MANUFACTURERS RECOMMENDATIONS. APPLY ON A CLEAN, DRY SURFACE AND AT A SURFACE TEMPERATURE OF NOT LESS THAN 70°F AND THE AMBIENT AIR TEMPERATURE SHALL NOT BE LESS THAN 60°F AND RISING. TWO COATS SHALL BE APPLIED.

ZONING:

THIS PROPERTY IS ZONED CP-2, DEFINED AS PLANNED COMMUNITY COMMERCIAL DISTRICT.

OIL-GAS WELLS:

ACCORDING TO THE MISSOURI DEPARTMENT OF NATURAL RESOURCES STATE OIL & GAS COUNCIL WELLS, LOCATED AT www.dnr.mo.gov/geology/geosurv/oilandgas.htm, THERE ARE NO OIL OR GAS WELLS ON THE PROPERTY SHOWN HEREON.

PRE-CONSTRUCTION MEETING NOTE:

THE CONTRACTOR SHALL CONTACT THE CITY'S DEVELOPMENT SERVICES ENGINEERING INSPECTION TO SCHEDULE A PRE-CONSTRUCTION MEETING WITH A FIELD ENGINEERING INSPECTOR PRIOR TO ANY LAND DISTURBANCE WORK AT (816) 969-1200.

FIRE ACCESS ROAD NOTE:

ALL FIRE ACCESS LANES SHALL BE HEAVY DUTY ASPHALT CAPABLE OF SUPPORTING 75,000-POUNDS.

SITE KEY NOTES:

- CONSTRUCT PRIVATE TYPE CO-1 CONCRETE CURB & GUTTER, TYP. SEE DETAIL GEN-4 ON SHEET C7.
- CONSTRUCT 4" PRIVATE CONCRETE SIDEWALK, TYP. SEE "PRIVATE CONCRETE SIDEWALKS (NON-REINFORCED)" DETAIL ON SHEET C7.1.
- CONSTRUCT PRIVATE SIDEWALK CURB RAMP (OMIT DETECTABLE WARNING). SEE "PRIVATE SIDEWALK RAMP" DETAIL ON SHEET C7.1.
- CONSTRUCT TRANSFORMER PAD (RE: ENERGY WORKORDER).
- INSTALL ACCESSIBLE PAVEMENT MARKINGS AND CONCRETE WHEEL STOPS PER ADA SPECIFICATIONS. SEE "ACCESSIBLE PARKING SPACE DETAIL" DETAIL ON SHEET C7.1.
- INSTALL ACCESSIBLE PARKING SIGN. SEE "ACCESSIBLE SIGN" DETAILS ON SHEET C7.1.
- INSTALL VAN ACCESSIBLE PARKING SIGN. SEE "ACCESSIBLE SIGN" DETAILS ON SHEET C7.1.
- CONSTRUCT PRIVATE TURN DOWN SIDEWALK AT ALL LOCATIONS WHERE SIDEWALK IS ADJACENT TO PAVED AREA. SEE "TURN DOWN SIDEWALK DETAIL" ON SHEET C7. SEE GRADING PLAN FOR SIDEWALK AND PAVEMENT ELEVATIONS.
- INSTALL SCORED CONCRETE CROSSWALK. SEE "CROSSWALK DETAIL" ON SHEET C7.1.
- INSTALL TRASH ENCLOSURE (RE: ARCH PLANS).
- INSTALL MONUMENT SIGN (RE: ARCH PLANS).
- INSTALL STANDARD ASPHALT PAVEMENT. SEE "STANDARD ASPHALT PAVING" DETAIL ON SHEET C7.
- INSTALL HEAVY DUTY ASPHALT PAVEMENT. SEE "HEAVY DUTY ASPHALT PAVING" DETAIL ON SHEET C7.
- INSTALL CONCRETE PAVEMENT. SEE "CONCRETE PAVING" DETAIL ON SHEET C7.
- INSTALL LANDSCAPE RETAINING WALL. SEE "LANDSCAPE RETAINING WALL" DETAIL ON SHEET C7.2.
- PROPOSED PROPANE TANK AND FILLING AREA (RE: BUILDING PLANS)
- PROPOSED CONTAINER STORAGE (RE: BUILDING PLANS)
- CONSTRUCT CONCRETE FLUME. SEE "CONCRETE FLUME" DETAIL ON SHEET C7.
- PROPOSED PARKING LOT LIGHT POLE (RE: MEP PLANS).
- CONSTRUCT 6" PRIVATE CONCRETE SIDEWALK UNDER FRONT CANOPY, TYP. SEE "PRIVATE CONCRETE SIDEWALKS (NON-REINFORCED)" DETAIL ON SHEET C7.1.

BUILDING & LOT DATA

Zoning	CP-2
Lot 2	
Site Area	2.58 Ac.
Retail Building	
No. of Stories	1 Story
Building S.F.	15,455 S.F.
Building Footprint	15,455 S.F.
FAR / Building Coverage	0.1374
Impervious Area	1.64 Ac. (64%)
Open Space	0.94 Ac. (36%)

PARKING SUMMARY

Lot 2A	
Parking Required:	
Retail Sales (5 / 1,000 S.F.)	
Total Required Parking	78 Spaces
Parking Provided:	
Standard Parking Provided	86 Spaces
Accessible Parking Spaces Provided	4 Spaces
Total Provided Parking	90 Spaces
Parking Lot, Aisles, and Drives Area	48,292 SF
Parking Lot Landscape Islands, Strips, Planting Areas	32,538 SF (67%)

LEGEND

PL	PROPERTY LINE
LL	LOT LINE
R/W	RIGHT-OF-WAY
2' CURB & GUTTER	
6" CURB	
B/L	BUILDING SETBACK LINE
P/S	PARKING SETBACK LINE
HEAVY DUTY ASPHALT PAVEMENT	
STANDARD DUTY ASPHALT PAVEMENT	
PROPOSED BUILDING	
CONCRETE PAVEMENT	
CONCRETE SIDEWALK	

UTILITY NOTES:
VISUAL INDICATIONS OF UTILITIES ARE AS SHOWN. UNDERGROUND LOCATIONS SHOWN, AS FURNISHED BY THEIR LESSORS, ARE APPROXIMATE AND SHOULD BE VERIFIED IN THE FIELD AT THE TIME OF CONSTRUCTION. FOR ACTUAL FIELD LOCATIONS OF UNDERGROUND UTILITIES CALL 811.

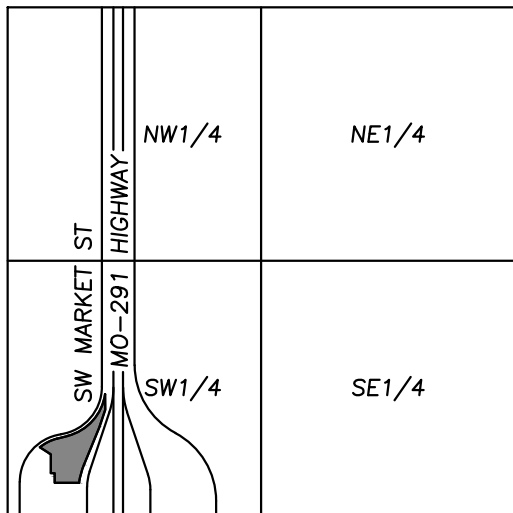

VICINITY MAP
SEC. 29-47-31



Know what's below.
Call before you dig.

4301 Indian Creek Parkway
Overland Park, KS 66207
phone: 813.451.9390
fax: 813.451.9391
www.davidsonae.com

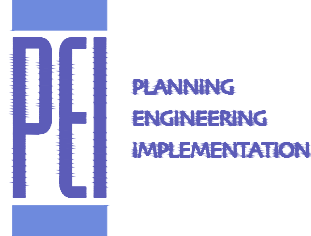

PHILIPS ENGINEERING, INC.
1320 N. Winchester
Olathe, Kansas 66061
(913) 399-1155
Fax (913) 399-1666
www.philipsengineering.com

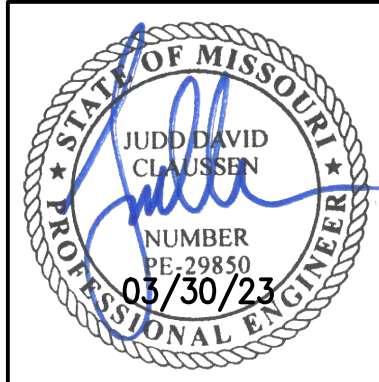

a new store for
Westlake ACE Hardware
3511 SW Market Street
Lee's Summit, Missouri 64082

date

drawn by

checked by

revisions



SITE PLAN

sheet number

C1

drawing type

PDP

project number

22185

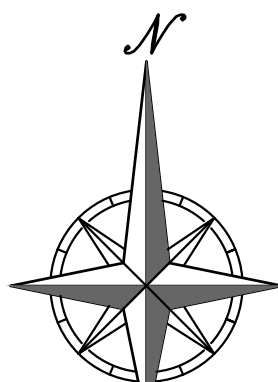

SCALE: 1"=30'
0' 30' 60'