

PROP CNR  
E-F=1009.79  
1009.83

SAN STUB  
STA 3+56  
FL@MAIN 997.20  
LENGTH 10  
FL@END 998.73  
MSFE 1000.70

--- PROPOSED  
CONTOURS  
--- AS-GRADED  
CONTOURS

X#### = Actual asbuilt ground shots  
taken on April 25, 2023.

Contours shown are asbuilt.

RELEASE FOR CONSTRUCTION  
AS NOTED FOR PLAN REVIEW  
DEVELOPMENT SERVICES  
LEE'S SUMMIT, MISSOURI  
04/26/2023

MH 4-C1  
STA 3+01.70  
TOP 1009.75  
FL 996.45  
FL 996.65

MH 4-C2  
STA 4+29.37  
TOP 1011.00  
FL 997.95  
FL 998.15  
(NOT FIELD VERIFIED)

LOT 90

LOT 78

LOT 89

LOT 79

LOT 88

LOT 80

PROP CNR  
E-F=1004.16  
1003.71  
MLO=1006.16

PROP CNR  
E-F=1001.41  
1001.00

PROP CNR  
E-F=1000.64  
1000.32

AS-GRADED PLOT PLAN IS  
REQUIRED PRIOR TO SODDING

**LEGEND**

- Gas Meter
- Telephone or Fiber-Optic Pedestal
- Cable TV Pedestal
- Electric Pedestal
- Light Pole
- Mailbox
- Fire Hydrant
- Water Valve

**PROPOSED HOUSE**

TOP FOUNDATION = 1015.75  
GARAGE FLOOR = 1014.75  
TOP FOOTING = 1006.75  
BASEMENT FLOOR = 1007.08  
DRIVE SLOPE = 3.5%

E = EXISTING ELEVATION  
F = PROPOSED FINAL ELEVATION  
G = ADJACENT GRADE AT EGRESS  
U/E = UTILITY EASEMENT  
B/L = BUILDING LINE  
S/Y/S = SIDE YARD SETBACK  
R/Y/S = REAR YARD SETBACK

**NOTES**

1. BUILDER TO VERIFY ALL BUILDING ELEVATIONS AND DIMENSIONS.
2. THIS PLOT PLAN DOES NOT CONSTITUTE A BOUNDARY SURVEY.
3. THE EASEMENTS SHOWN ON THIS PLOT PLAN ARE TAKEN FROM THE FINAL PLAT. OTHER EASEMENTS MAY EXIST.

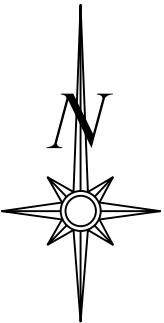

Scale 1"=30'

**LOT INFORMATION**

17,038 SQ. FT.  
MBOE (NW) = 1010.75  
MBOE (SW) = 1002.00  
MSFE = 1000.70  
ADDRESS  
2323 SW SERENA PLACE  
**LEGAL DESCRIPTION**  
LOT 79, SUMMIT VIEW FARMS 4TH  
PLAT, A SUBDIVISION AS  
RECORDED IN LEE'S SUMMIT,  
JACKSON COUNTY, MISSOURI.

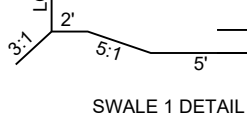

SLOPE 6.6%  
FLOW 2.22 CFS  
DEPTH OF FLOW 0.14'  
VELOCITY 2.78 FPS

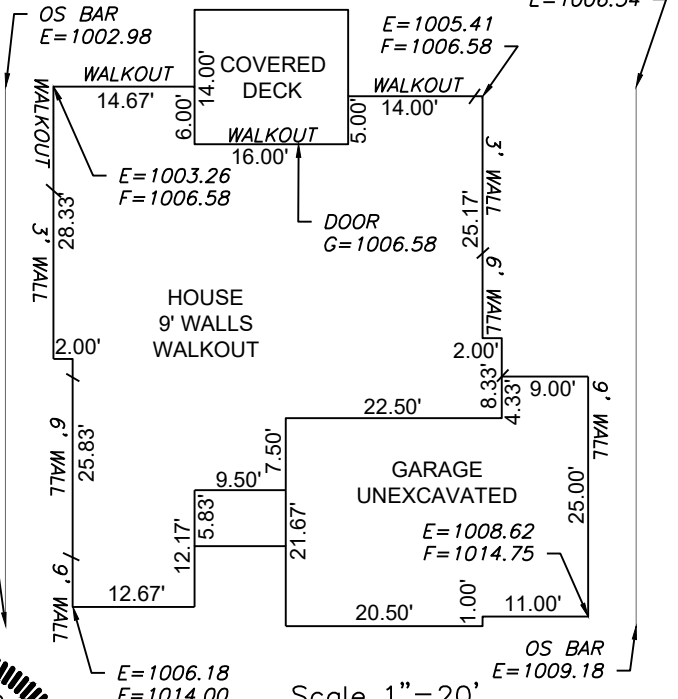

Scale 1"=20'

**E** ENGINEERING & SURVEYING  
**SOLUTIONS**  
50 SE 30TH STREET  
LEE'S SUMMIT, MO 64082  
P:(816) 623-9888 F:(816) 623-9849  
WWW.ENGINEERINGANDSURVEYSOLUTIONS.COM

STATE OF MISSOURI  
MATTHEW J. SCHLICK  
PROFESSIONAL ENGINEER  
PE-2006019708  
4/26/2023

**AS-GRADED PLOT PLAN - LOT 79**  
**SUMMIT VIEW FARMS 4TH PLAT**  
LEE'S SUMMIT, JACKSON COUNTY, MISSOURI  
**WALKER CUSTOM HOMES LLC**  
P.O. BOX 3194  
INDEPENDENCE, MO 64064

PROJECT NO.	FILE NAME	DATE	SHEET	OF
1	LOT 79, SUMMIT VIEW FARMS	1/18/22	1	1

THIS DRAWING IS NOT VALID UNLESS THE SIGNATURE, DATE AND SEAL OF THE ENGINEER WHO SUPERVISED THE PREPARATION OF THIS DRAWING HAS BEEN AFFIXED HERETO.