

RELEASE FOR CONSTRUCTION  
 AS NOTED FOR PLAN REVIEW  
 DEVELOPMENT SERVICES  
 LEE'S SUMMIT, MISSOURI  
**11/30/2021**

E 947.59 F 947.59 **N70°49'21" W** **80.00'** E 948.74 F 948.74

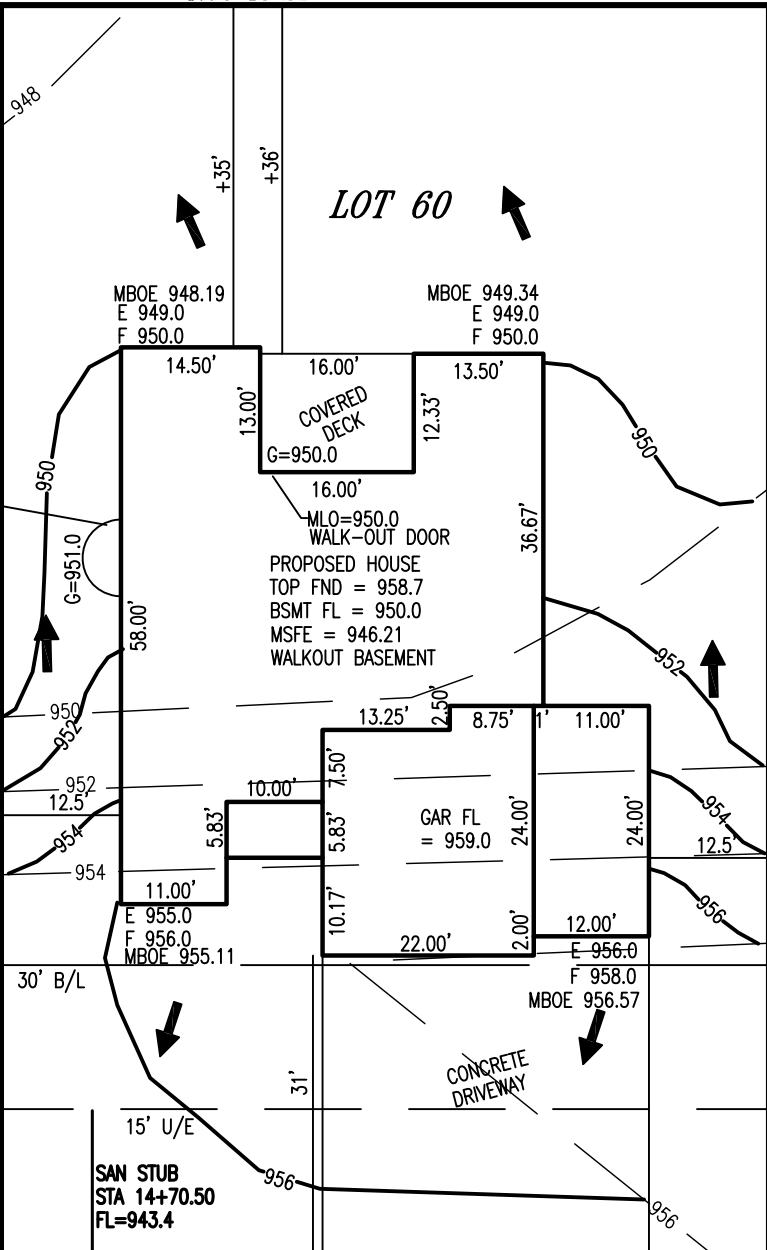

E 955.5 F 955.5 E 956.2 F 956.2 E 956.10 F 956.10

E 954.74 F 954.74 E 954.74 F 954.74

CI 1-4 TOP=954.34 STM MH 1-5 TOP=955.77 TC 955.8

**N70°49'21" W** **80.00'**



**KEY:**  
 U/E = UTILITY EASEMENT  
 TC = TOP OF CURB  
 B/L = BUILDING LINE  
 E = EXISTING GRADE  
 F = FINISH GRADE  
 G = LOWEST ADJACENT GRADE

**NOTES:**  
 ALL GRADES TAKEN FROM SUBDIVISION  
 GRADING PLANS  
 ADDRESS: 2114 SW RED BARN LANE

- NOTES:** NOV. 22, 2021
- LEGAL DESCRIPTION OF PROPERTY PROVIDED BY CONTRACTOR. THIS PLOT PLAN DOES NOT CONSTITUTE OR REPRESENT A BOUNDARY SURVEY. THE CONTRACTOR AND/OR OWNER SHALL BE RESPONSIBLE FOR VERIFICATION OF PROPERTY BOUNDARY, PROPERTY CORNERS, DEED DESCRIPTIONS AND LOCATIONS OF PROPOSED HOUSE WITH RESPECT TO PROPERTY LINES.
  - EASEMENTS, BUILDING LINES AND SET-BACKS TAKEN FROM RECORDED PLAT ONLY.
  - CONTRACTOR TO VERIFY LOCATION AND DEPTH OF SANITARY SEWER SERVICE PRIOR TO CONSTRUCTION.
  - CONTRACTOR TO VERIFY ALL DIMENSIONS, ELEVATIONS AND LOCATIONS PRIOR TO CONSTRUCTION
  - CONTRACTOR TO VERIFY CONDITION OF ALL FILL PRIOR TO CONSTRUCTION.
  - GRADES ARE PROPOSED GRADES ONLY. FINAL GRADING AND ELEVATIONS SHALL BE CONTRACTORS RESPONSIBILITY.

JFE CONSTRUCTION

**PLOT PLAN**

LOT 60  
**THE RETREAT AT HOOK FARMS**  
 LEE'S SUMMIT MISSOURI

**LADWIG and ASSOCIATES, L.L.C.**  
 LAND SURVEYORS  
 816-309-6621

DRAWN BY: JDH SCALE: 1" = 20'  
 DATE: 11/21/21 DRAWING NO. HF-60