

CONSTRUCTION STAKE PLOT PLAN

ORDERED BY: PFEIFER HOMES

DESCRIPTION: LOT 184 WOODSIDE RIDGE 2ND PLAT
LOTS 144-198 AND TRACTS I, J, AND K.

RELEASE FOR CONSTRUCTION
AS NOTED ON PLANS REVIEW
DEVELOPMENT SERVICES
LEE'S SUMMIT, MISSOURI
01/24/2023 1:02:17

2206 NW KILLARNEY LEE'S SUMMIT, JACKSON COUNTY, MISSOURI
NO DECK CONSTRUCTION WITHOUT A PERMIT

* UPDATED 1-24-2023

RAISED 1"
1' BLOCKOUT
OK TROY

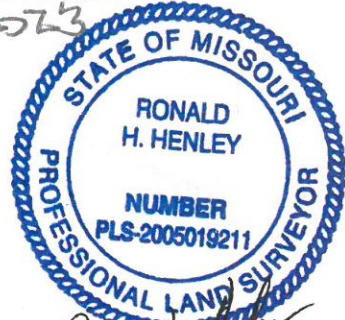

NOTE: FOR HOUSE
DIMENSIONS SEE HOUSE
PLANS.

TOF 965.98
GAR 965.48
BFE 957.31

TOF 965.48
GAR. 964.98
BFE 956.81
EGRESS
WALKOUT BASEMENT
LAG 956.31

E 959.00
F 956.31
956.81

E 964.35
F 964.98
965.48

E 963.95
F 963.95

E 963.97
F 963.97

E 964.48
F 964.48

CTRLINE NW KILLARNEY
DRIVE 50' ROW

L=74.27'
R=275.00'

E 965.95
F 965.95
E 965.73
F 965.73

E 964.79
F 964.98
965.48

EGRESS
LAG 958.8
959.30
RETAINING WALL
TOP 963.0
BOTTOM 959.0

E 958.32
F 956.31
956.81

E 958.2
F 958.2

— = EXISTING CONTOURS

• = 6' O/S BAR (TYP)

HENLEY SURVEY CO.

PHONE: (816) 716-3254



1" = 30' DATE: 11/10/22

ATTENTION: This plot plan was prepared for use before and during foundation construction only. House staked as shown on plot plan. Contractor to check and verify house dimensions and elevations at job site. We are not responsible for unknown or platted easements of any kind unless we are furnished the description of said easements before the field work is performed. NOTE: Cuts shown hereon for excavation are a guide only. Final decision as to cuts and foundation height are to be made by builder on job site.

DIRECTION OF DRAINAGE →