

# LEE'S SUMMIT MISSOURI

## RELEASE FOR LAWN SPRINKLER SYSTEM IN CITY OF LEE'S SUMMIT RIGHT OF WAY (RESIDENTIAL)

In consideration for the City of Lee's Summit's permission to extend a Lawn Irrigation System into the City's right of way at (legal description of the property):

Lot No. 132 Plat Title The Manor at Stony Creek Address: 1921 SW Merryman Dr  
County: Jackson State: Missouri

I, Zalman Kohen, the undersigned, successors, and assigns do hereby release and forever discharge the City of Lee's Summit, its employees and/or agents from and against any and all liability, claims and demands for any use arising out of, relating to, or being in any way connected with work or service by the City, its employees or agents within the City's right of way for any purpose whatsoever.

NOW THEREFORE, the Undersigned hereby declares that said property described above shall be held, sold and conveyed subject to the release herein and said release shall run with the real property and be binding on all parties having any part thereof, their heirs, successors and assigns.

IN WITNESS WHEREOF, this release has been read, signed and sealed this 13<sup>th</sup> day of December, 2022

By:

Zalman Kohen V.P.  
Printed or Typed Name

## INDIVIDUAL ACKNOWLEDGMENT

STATE OF MISSOURI  
COUNTY OF JACKSON

ON THIS, The 13<sup>th</sup> day of December, 2022 before me, a Notary Public, personally appeared:  
Zalman Kohen

proved to me on the basis of satisfactory evidence to be the person(s) whose name(s) subscribed to the within instrument, and acknowledged that he he/she/they executed the same for the purposes stated therein and no other.

WITNESS my hand and official seal in the County and State aforesaid, the day and year first above written.

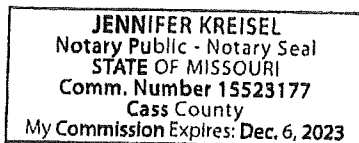

/s/ Jennifer Kreisel  
Notary Public Signature  
Jennifer Kreisel  
Printed or Typed Name

(Seal)

My Commission Expires:

December 6, 2023

Revised 10/23/14

06/09/2022







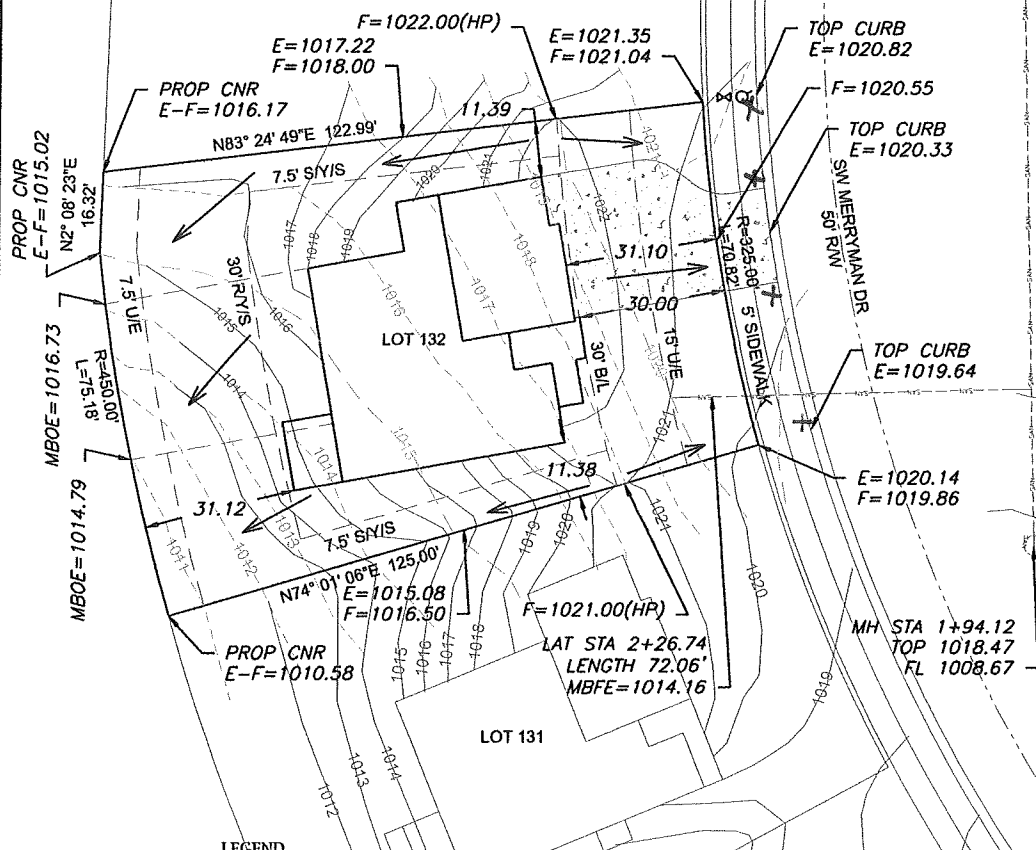

Brandon Kaiwei Kaiwei,  
OU=Development,  
OU=LS Users,  
DC=COLS, DC=LOC  
Date: 2022.06.09  
18:42:48-0500

LOT 133

MH STA 5+50.89  
TOP 1030.85  
FL 1022.15



### LEGEND

- |   |                                   |           |
|---|-----------------------------------|-----------|
|  | Gas Meter                         |           |
|  | Telephone or Fiber-Optic Pedestal |           |
|  | Cable TV Pedestal                 |           |
|  | Electric Pedestal                 |           |
|  | Light Pole                        |           |
|  | Mailbox                           |           |
|  | Fire Hydrant                      | 05 BAR    |
|  | Water Valve                       | 5-101.4/4 |

EXTENDED LOT AREA = 10,885 SF  
DRIVE AREA = 887 SF  
APPROACH AREA = 214 SF  
SIDEWALK AREA = 254 SF

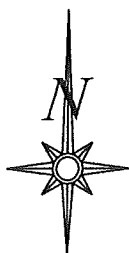

Scale 1"=30'

### LOT INFORMATION

10,115.57 SQ. FT.  
MBFE = 1014.16  
MBOE (LEFT) = 1012.82  
MBOE (RIGHT) = 1018.35  
ADDRESS  
1921 SW MERRYMAN DR

## LEGAL DESCRIPTION

**LEGAL DESCRIPTION**  
LOT 132, THE MANOR AT STONEY  
CREEK 4TH PLAT, A SUBDIVISION  
AS RECORDED IN LEE'S SUMMIT,  
JACKSON COUNTY, MISSOURI.

### PROPOSED HOUSE

TOP FOUNDATION = 1024.75  
GARAGE FLOOR = 1022.75  
TOP FOOTING = 1015.75  
BASEMENT FLOOR = 1016.08  
DRIVE SLOPE = 7.1%

E = EXISTING ELEVATION  
F = PROPOSED FINAL ELEVATION  
G = ADJACENT GRADE AT EGRESS  
U/E = UTILITY EASEMENT  
B/L = BUILDING LINE  
S/Y/S = SIDE YARD SETBACK  
R/Y/S = REAR YARD SETBACK

## NOTES

1. BUILDER TO VERIFY ALL BUILDING ELEVATIONS AND DIMENSIONS.
2. THIS PLOT PLAN DOES NOT CONSTITUTE A BOUNDARY SURVEY.
3. THE EASEMENTS SHOWN ON THIS PLOT PLAN ARE TAKEN FROM THE FINAL PLAT. OTHER EASEMENTS MAY EXIST.

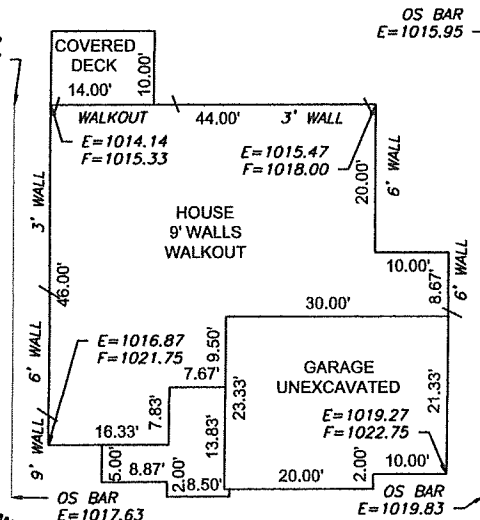

PLAN: CARBONDALE

Scale 1"=20'

**PLOT PLAN - LOT 132**

**THE MANOR AT STONEY CREEK 4TH PLAT  
LEE'S SUMMIT, JACKSON COUNTY, MISSOURI**

**SUMMIT HOMES**  
120 SE 30TH STREET  
LEE'S SUMMIT, MO 64062

PROJECT NO. 1	FILE NAME LOT 132, MAHAR AT STONEY CREEK	DATE 8/5/72	SHEET 1	OF 1
------------------	---	----------------	------------	---------

THIS DRAWING IS NOT VALID UNLESS THE SIGNATURE, DATE AND SEAL OF THE ENGINEER WHO SUPERVISED THE PREPARATION OF THIS DRAWING HAS BEEN AFFIXED HERETO.

# ENGINEERING SOLUTIONS

ENGINEERING & SURVEYING

50 SE 30TH STREET  
LEE'S SUMMIT, MO 64082  
P:(816) 623-9888 F:(816) 623-9849  
TW.ENGINEERINGSSOLUTIONKC.COM

STATE OF MISSOURI  
MATTHEW V. SCHLICHT  
NUMBER  
PE-2006019708  
3/1/08  
PROFESSIONAL ENGINEER