

The Amerhart logo features a stylized graphic on the left consisting of a dark grey triangle pointing right, a green triangle pointing left, and a small dark grey triangle pointing right, all meeting at a central point. To the right of this graphic, the word "Amerhart" is written in a large, bold, black serif font.

Created	November 29, 2021
Designer	Thomas Hamrick
Layout Name	BAICH - LOT FF 36
Dealer	TEAGUE LUMBER
Revised	November 29, 2021

Project

1. ALWAYS READ PRODUCT BROCHURE BEFORE INSTALLATION OF EWP PRODUCTS.
2. REFER TO HOLE CHARTS PRIOR TO DRILLING PRODUCT.
3. THIS DOCUMENT IS INTENDED SOLELY AS A PLACEMENT PLAN. IT IS TO BE REVIEWED BY THE ENGINEER OF RECORD AND MUST MEET HIS/HER APPROVAL PRIOR TO INSTALLATION OF OUR PRODUCT.
4. THIS DOCUMENT IS NOT TO BE USED AS A REPLACEMENT FOR YOUR ORIGINAL STRUCTURAL PLANS.
5. LAYOUT, QUANTITY AND LENGTH TO BE VERIFIED BY CONTRACTOR.
6. IF WALLS ARE SPECIFIED IN THIS QUOTE, CONTRACTOR MUST VERIFY ALL DIMENSIONS AND ROUGH OPENING SIZES PRIOR TO CONSTRUCTION OF WALL. ROUGH OPENING SIZES ARE ESTIMATES ONLY. TALL WALL IS DESIGNED FOR VERTICAL LOADS AND DIRECT WIND LOADS ONLY. INLINE LATERAL BRACING OF THE BUILDING DIAPHRAGM IS TO BE ACCOUNTED FOR BY THE BUILDING DESIGNER/ENGINEER.

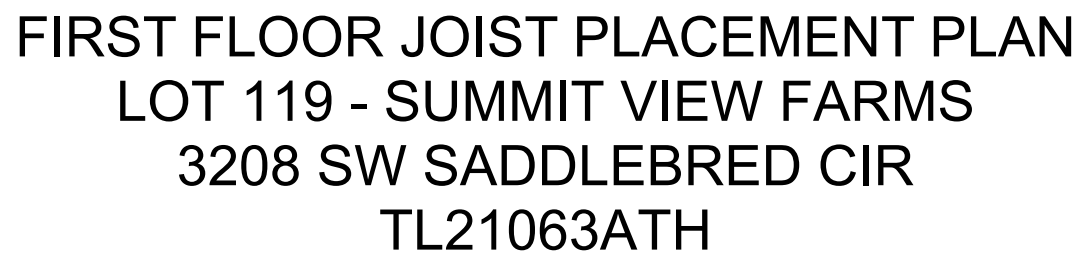

Ground Floor							
I Joist							
Label	Description	Width	Depth	Qty	Plies	Pcs	Length
J14	LPI 20 Plus	2.5	9.5			2	48-0-0
J13	LPI 20 Plus	2.5	9.5			2	46-0-0
J12	LPI 20 Plus	2.5	9.5			2	42-0-0
J11	LPI 20 Plus	2.5	9.5			4	38-0-0
J1	LPI 20 Plus	2.5	9.5			10	32-0-0
J2	LPI 20 Plus	2.5	9.5			3	30-0-0
J16	LPI 20 Plus	2.5	9.5			8	28-0-0
J15	LPI 20 Plus	2.5	9.5			3	24-0-0
J9	LPI 20 Plus	2.5	9.5			8	18-0-0
J5	LPI 20 Plus	2.5	9.5	1	2	2	18-0-0
J8	LPI 20 Plus	2.5	9.5			2	16-0-0
J7	LPI 20 Plus	2.5	9.5			8	14-0-0
J10	LPI 20 Plus	2.5	9.5			2	10-0-0
J6	LPI 20 Plus	2.5	9.5			3	8-0-0
J4	LPI 20 Plus	2.5	9.5	1	2	2	8-0-0
Blocking							
Label	Description	Width	Depth	Qty	Plies	Pcs	Length
BLK1	LPI 20 Plus	2.5	9.5			88	2-0-0
Rim Board							
Label	Description	Width	Depth	Qty	Plies	Pcs	Length
R1	LP APA Rated OSB 1.125 X 9.5	1.125	9.5			20	12-0-0
LVL/LSL							
Label	Description	Width	Depth	Qty	Plies	Pcs	Length
FB4	LP-LVL 2900Fb-2.0E	1.75	9.5	1	2	2	20-0-0
FB3	LP-LVL 2900Fb-2.0E	1.75	9.5	3	2	6	14-0-0
FB2	LP-LVL 2900Fb-2.0E	1.75	9.5	1	2	2	8-0-0
FB1	LP-LVL 2900Fb-2.0E	1.75	9.5	1	2	2	6-0-0

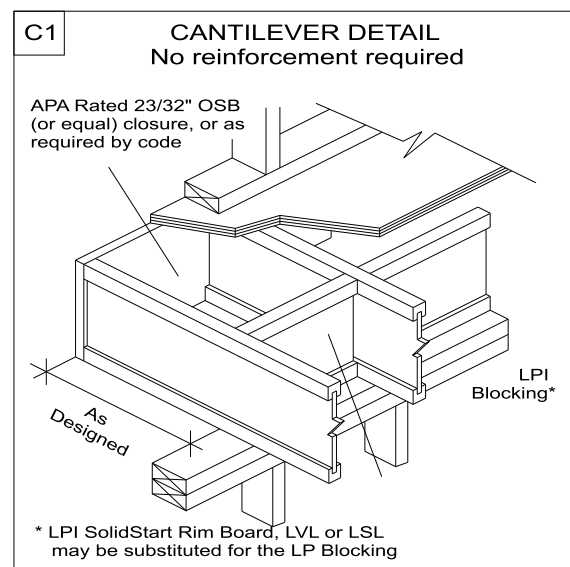
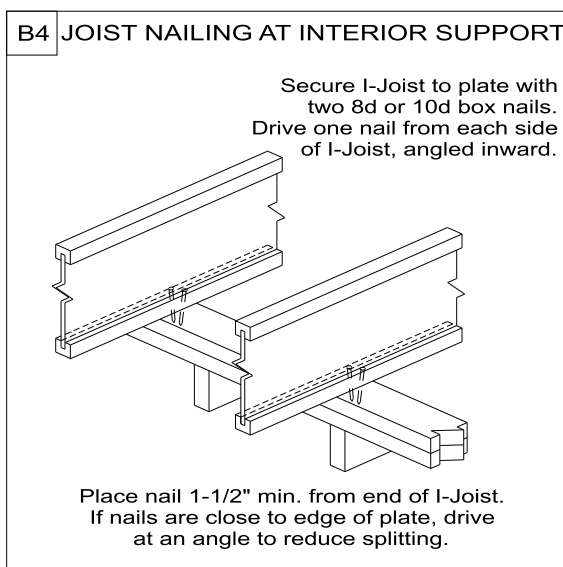
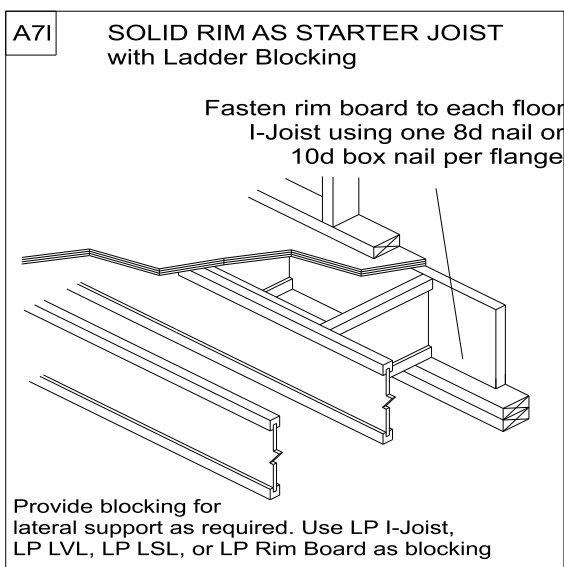
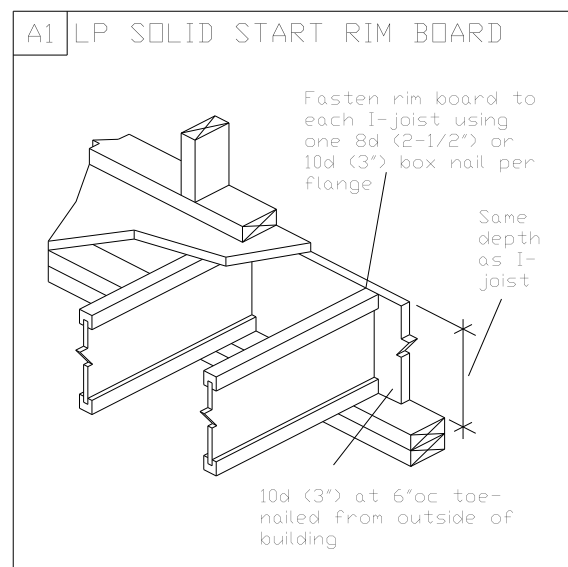

1 JOIST LAYOUT/SUBMITTAL REVIEW	
<input type="checkbox"/>	REVIEWED & FOUND TO BE IN CONFORMANCE WITH REFERENCED PLAN
<input type="checkbox"/>	FURNISH AS CORRECTED
<input checked="" type="checkbox"/>	REVIEWED WITH CHANGES TO REFERENCED DRAWINGS
<input type="checkbox"/>	REVISE AS NOTED & RESUBMIT
<p>THIS REVIEW IS TO VERIFY GENERAL CONFORMANCE WITH THE DESIGN AND CONSTRUCTION REQUIREMENTS OF THE REFERENCED IN AN AND/OR CONSTRUCTION DOCUMENTS. REVIEW DOES NOT RELY ON THE CONTRACTOR FOR ROOM CONFORMANCE, DIMENSIONS, MATERIAL, METHODS, TECHNIQUES, SEQUENCES, PROCEDURES, SAFETY AND COORDINATION OF ALL WORK TO BE PERFORMED.</p>	
<p>HD ENGINEERING & DESIGN</p> <p>11656 W. 75TH ST. SHAWNEE, KS 66214</p> <p>PH: 913-643-2222 WWW.HIDENGINEERINGEBS.COM</p>	
<p>SIGNED: _____</p> <p><i>[Signature]</i></p> <p>DATE: 08/02/2022</p>	