



December 6, 2022

Walker Custom Homes  
Attn: Pete Pine

Re: Inspection Letter: SVF079 Spec Lot 79 Summit – 2323 SW Serena Pl., Lee's Summit, MO

Vista Structural Engineering, LLC was asked to address the following rough-in inspection items for the project located at above referenced address. Please see the following response w/ attached detail sketch.

- 1) **Inspection comment:** "Address rafters landing on blocks throughout"

**Vista Structural's response:** *Please see attached detail sketch, 1/SK1. GC to provide 2x kicker w/ (3) 16d to each rafter & ceiling joist. GC to also provide Simpson H1 clip to each ceiling joist to wall double top plate.*

Our firm appreciates the opportunity to serve you. If you have any questions or if you need anything further, please feel free to contact us.

Sincerely,  
Vista Structural Engineering, LLC  
Dennis Heier, P.E.

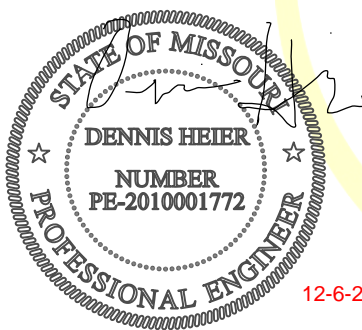

12-6-22

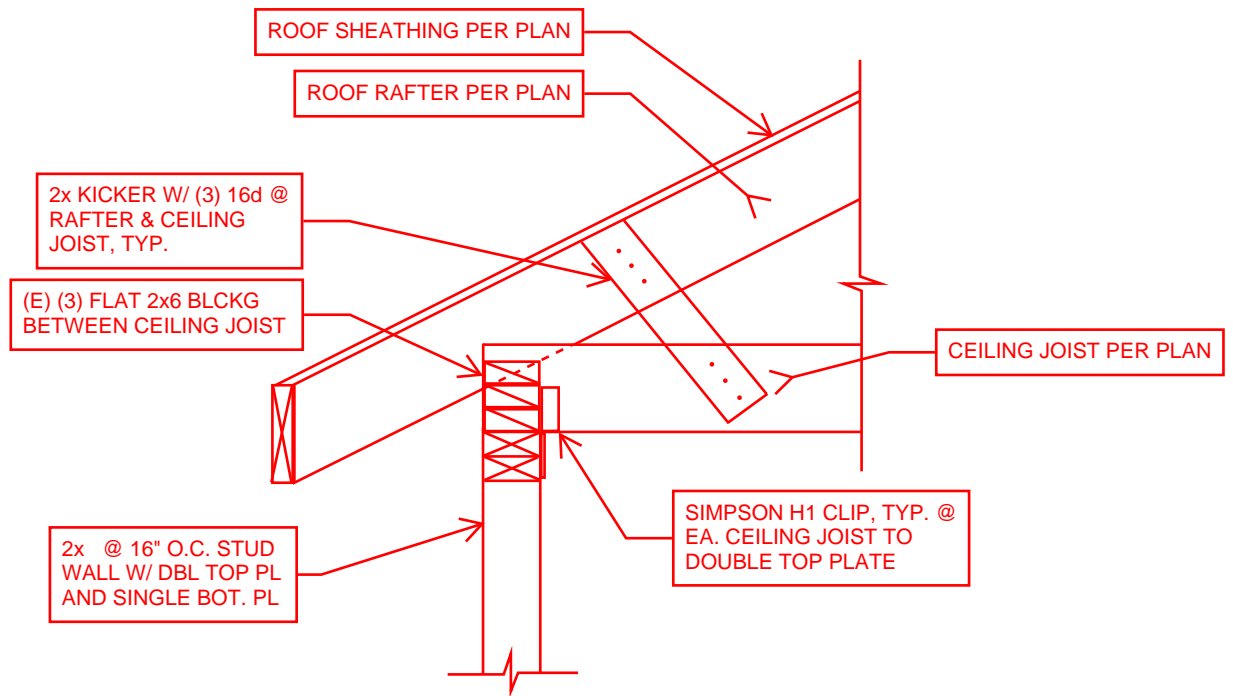

1  
SK1

RAFTER TO WALL CONNECTION

N.T.S.