

BORE NEEDED

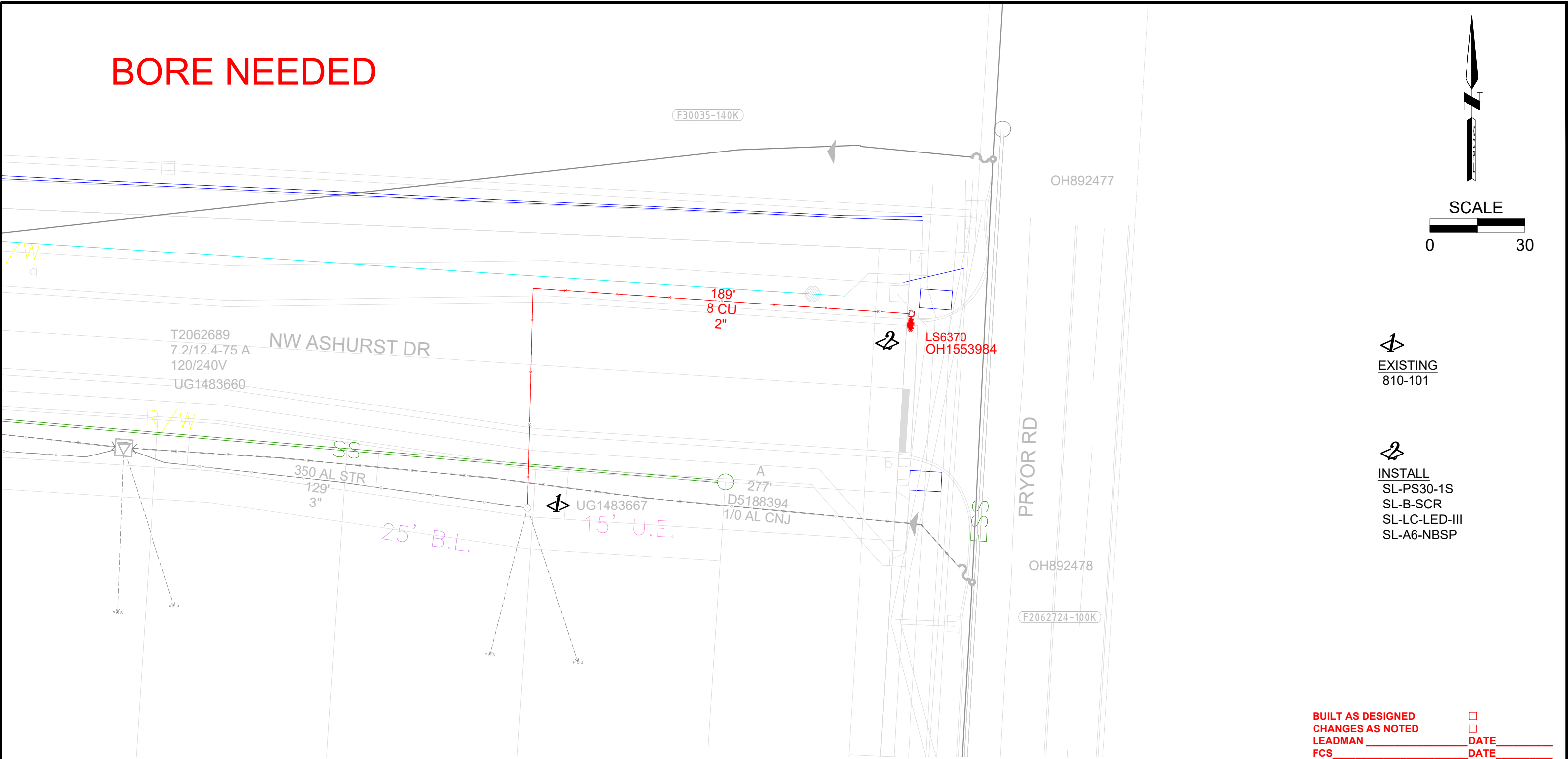

EXISTING  
810-101

INSTALL  
SL-PS30-1S  
SL-B-SCR  
SL-LC-LED-III  
SL-A6-NBSP

BUILT AS DESIGNED  
CHANGES AS NOTED  
LEADMAN \_\_\_\_\_ DATE \_\_\_\_\_  
FCS \_\_\_\_\_ DATE \_\_\_\_\_

SEC. 2 TWP. 47N RANGE 32W TAX DIST. 49

REV.	DATE	BY	CHECKED	APPROVED
------	------	----	---------	----------

DISCLAIMER AND COPYRIGHT NOTICE

The information contained on this drawing/map is used to locate, identify and/or inventory Evergy Inc. electrical facilities located on parcels of land in the Evergy Inc. service area. It is intended for reference purposes only and is NOT to be construed or used as a "legal description." Map information is believed to be accurate but accuracy is not guaranteed. This information should not be relied upon as a substitute for an actual field survey. This drawing/map is not to be used as a substitute for using the ONE-CALL system for purposes of digging and excavation. You must call ONE-CALL (811) to notify operators of underground facilities of proposed excavation or digging to request that member companies mark their underground facilities before they dig! In no event will Evergy Inc. be liable for any damages, including loss of data, lost profits, business interruption, loss of business information or other pecuniary loss that might arise from the inaccuracy, use or misuse of this map or the information it contains. You are prohibited from reproducing or distributing this drawing/map or any portion of it without written permission of Evergy Inc. © Evergy Inc. All rights reserved.

EXISTING -----  
INSTALL - - - - -  
REMOVE - - - / / / - - -  
MODIFY - - - - -



Know what's below.  
Call before you dig.

CONTACTS

PROJECT DESIGNER: HEATH LENAHA  
PHONE #: 816-392-3272

CUSTOMER: BRAD COOLEY  
PHONE #: 816-969-1800

TITLE WOODSIDE RIDGE

ADDRESS ASHURST & PRYOR RD

CITY LEES SUMMIT

COUNTY JA STATE MO

PRJ# 50034497

WR# 1067833

SEC. DIST.

CIRCUIT c28311s03

12.47 KV JOB TYPE: 1STLT SHEET 1 OF 1



LEE'S SUMMIT SERVICE CENTER

DESIGNED BY: HLENAHAN

REVIEWED BY: DDAVIN

DATE: 9/16/2022

DWG FILE # 1067833-1