



August 17, 2022

New Mark Homes

Re: 1620 SW 27<sup>th</sup> St  
Lot 44, Whispering Woods  
Lee's Summit, MO 64082  
Permit: PRRES20215563

Apex Engineers Inc. observed the house under construction at the above-referenced address. Our firm has been retained to address comments from the city rough-in inspection. For the purposes of this report, the house will be referred to as facing south.

1. *Address over notched joist above single car garage for dwv.*
  - A 3.5" x 2.5" square notch was observed in the top edge of a double 2x10 floor joist above the single car garage and located approximately 2 ft from the steel support beam.
    - After computations, our firm has determined that the joist is adequate to resist the service loads of the structure as installed. No repair is recommended.
2. *Address notch for HVAC above the master bathroom*
  - A 2.5" diameter hole was observed within 2" of the top edge in a single 2x10 joist above the master bathroom and located approximately from load-bearing wall support.
    - After computations, our firm has determined that the HVAC must be re-routed, and the notched joist shall be repaired per the following detail:

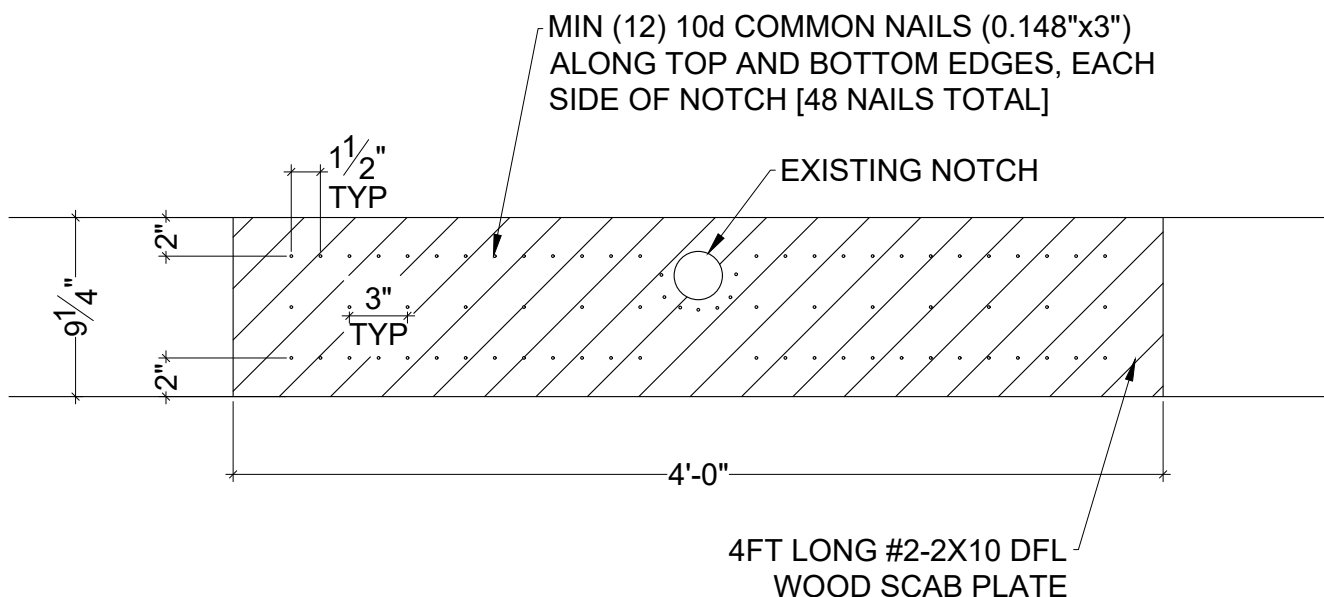

Figure 1.0 – Notch Joist Repair Detail

Contingent upon the repairs outline above, our firm recommends approval of these items.

Please call if our firm can of further assistance.

---

#### **LIMITATIONS**

The scope of our services includes only those items specifically addressed herein. All other items are outside the scope of this inspection; including any environmental assessment (such as but not limited to mold, mildew, or presence of any other toxic substance or environmental risks).

In addition, the scope of our services does not include any evaluation of the building or site for job-site safety and/or hazardous conditions. All construction shall be performed in compliance with IRC and OSHA standards at all times. Our firm has not been retained to examine the site or building for any of these conditions. In addition, the contractor shall retain sole responsibility for the quality of work, for adhering to plans, specifications, and appropriate codes, and, for repairing defects, deficiencies or omissions, regardless of when they are found. By the use of this report, it is understood the above conditions are agreed to.

Best Regards,  
Apex Engineers, Inc.



Nick A. Shifflett  
Project Engineer

Clayton J. Hess,  
Principal

