

7/21/2022 5:07:32 PM

PR 2021.03.11

1/4" = 1'-0"

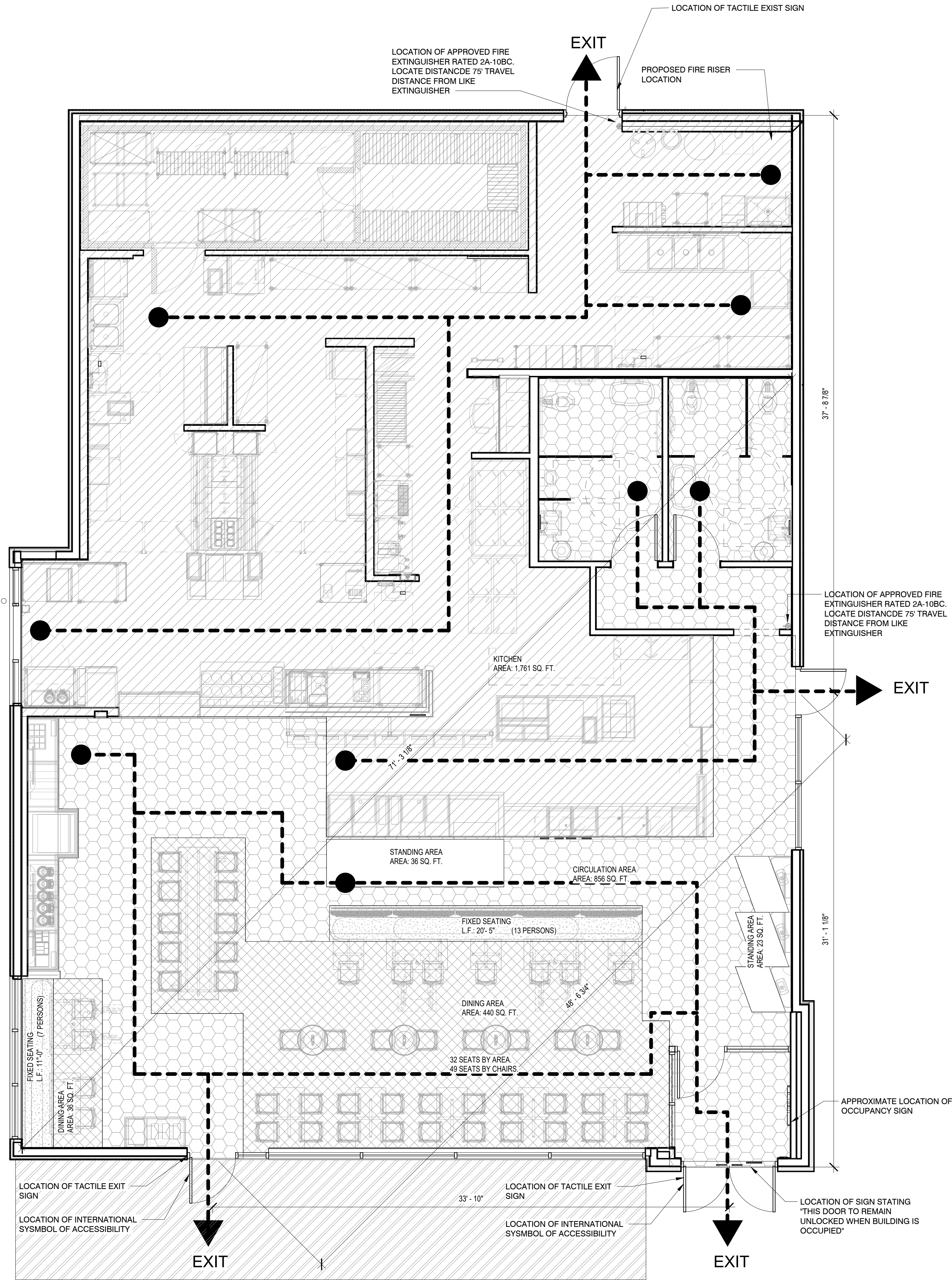

## GENERAL NOTES

- TACTILE EXIT SIGNS TO BE MOUNTED BETWEEN 4'-6" AND 5'-0" AFF. ON HINGE SIDE OF ALL EXTERIOR EXIT DOORS.
- ONE 2A10BC DRY CHEMICAL FIRE EXTINGUISHER IS REQUIRED FOR EACH 3,000 SQ. FT. OF FLOOR AREA WITH THE TRAVEL DISTANCE NOT TO EXCEED 75 FEET.
- ALL EGRESS DOORS SHALL BE READILY OPENABLE FROM THE EGRESS SIDE WITHOUT USE OF KEY OR SPECIAL KNOWLEDGE OR EFFORT.
- AT LEAST 5%, BUT NO LESS THAN ONE OF THE SEATING SPACES IN EACH FUNCTIONAL AREA SHALL BE ACCESSIBLE.  
CALCULATION FOR NUMBER OF ACCESSIBLE SEATS:  
(INTERIOR SEATS) 100 x 5% = 5  
(EXTERIOR SEATS) 26 x 5% = 2
- ACCESS TO ACCESSIBLE SEATING SPACES SHALL BE PROVIDED BY MAIN AISLES (ACCESSIBLE ROUTE) A MINIMUM WIDTH OF 36".
- A MINIMUM OF 30" BY 48" CLEAR FLOOR SPACE SHALL BE PROVIDED AND SHALL NOT OVERLAP THE KNEE SPACE MORE THAN 14".
- FIXED TABLES AND COUNTERS: HEIGHT OF TABLES NAD COUNTERS SHALL BE 28" MINIMUM AND 34" MAXIMUM.
- MANEUVERING CLEARANCE: A MINIMUM OF 36" x 48" CLEAR FLOOR SPACE SHALL BE PROVIDED, KNEE CLEARANCE SHALL BE AT LEAST 27" HIGH, 30" WIDE AND 10" DEEP.
- FINAL EXTINGUISHER LOCATIONS TO BE APPROVED BY FIRE MARSHAL.

## APPLICABLE BUILDING CODES

BUILDING CODE	2018 IBC
PLUMBING CODE	2018 IPC
ELECTRICAL CODE	2017 NATIONAL ELECTRICAL CODE
MECHANICAL CODE	2018 INTERNATIONAL MECHANICAL CODE
ENERGY CODE	
FIRE CODE	2018 INTERNATIONAL FIRE CODE
ACCESSIBILITY CODE	2009 AMERICANS WITH DISABILITIES ACT, ICC/ANSI A117.1

## BUILDING INFORMATION

CONSTRUCTION TYPE	TYPE V - B
SPRINKLERED	BUILDING IS NON-SPRINKLERED

## LEGEND

	CIRCULATION AREA: 855 SQ. FT.		DINING AREA & CAFE AREA: 475 SQ. FT.
	FIXED SEATING AREA: 70 SQ. FT.		KITCHEN AREA: 1,761 SQ. FT.
	STANDING ROOM AREA: 59 SQ. FT.		PATIO AREA: 325 SQ. FT.

INTERIOR AREA (NET): 3,220 SQ. FT.  
PATIO AREA: 325 SQ. FT.

## ALLOWABLE AREA

PER 2018 IBC	
PRIMARY OCCUPANCY	A-2   ASSEMBLY
MAXIMUM ALLOWABLE BUILDING AREA	6000 SF, ACTUAL 3,493
TRAVEL DISTANCE (PER 2018 IBC TABLE 1016.2)	150FT ALLOWED

## OCCUPANT LOAD

OCCUPANT LOAD COUNT TABLE PER 2018 IBC TABLE 1004.1.2

	FUNCTION OF SPACE	OCCUPANT LOAD FACTOR	AREA (SQFT)	OCCUPANTS
DINING AREA	UNCONCENTRATED	15	475	32 (49 SEATS)
CIRCULATION	UNCONCENTRATED	0	855	0
KITCHEN	KITCHEN: COMMERCIAL	200	1761	9
STANDING AREA	STANDING AREA	5	59	12

FIXED SEATING		
TOTAL LINEAL LENGTH	LINEAL IN. PER OCC.	PERSONS
20'-5"	18	13
11'-0"	18	7

TOTAL INTERIOR OCCUPANTS:	90
PATIO:	SEAT COUNT: 22
TOTAL OCCUPANTS (INCLUDING PATIO):	112

## EXIT REQUIREMENTS

PER 2018 IBC SECTION 1015.2.1	
LONGEST INTERIOR DIAGONAL DIMENSION	71'-3 1/8"
MIN. DISTANCE BETWEEN DOORWAYS (SPRINKLED)	71'-3 1/8" = 35'-7 1/2"
ACTUAL DISTANCE BETWEEN CLOSEST DOORWAYS	48' - 6 3/4"

## ALLOWABLE EGRESS WIDTH

PER 2018 IBC SECTION 1005.3.2

	OCCUPANTS	FACTOR (IN.)	(IN.)
INTERIOR	90	0.20	18
EXTERIOR PATIO SPACE W/OUT SPRINKLER	22	0.20	4.4
MINIMUM EGRESS OPENING WIDTH REQUIRED			22.2
MINIMUM DOOR SIZE (PER 1008.1.1) [CLEAR OPENING]			32.00
	MAIN EXIT (IN.)	SECONDARY (IN.)	TOTAL (IN.)
ACTUAL EGRESS OPENING WIDTH PROVIDED	34	34	68.0

## PLUMBING CALCULATIONS

PER 2018 IPC					
BUILDING OCCUPANCY (TOTAL)	112				
				TOTAL MEN/WOMEN	112
				LAVATORIES	
				OTHER	
BUILDING ASSEMBLY	MALE	FEMALE	MALE	FEMALE	
A-2	1:100	1:100	1:200	1:200	1 SERVICE SINK
REQUIRED	2	2	1	1	1
PROVIDED	1+1 URNIAL	2	1	1	1

Bakery-Cafe:

22169

SYSTEM: G4 (ARIA)

Project Team:



LK ARCHITECTURE, INC.

345 RIVERVIEW,  
WICHITA, KS 67203  
T 316.268.0230  
F 316.268.0205

Architecture · Engineering ·  
Planning · Interior Design ·  
Landscape Architecture

Professional Seal:

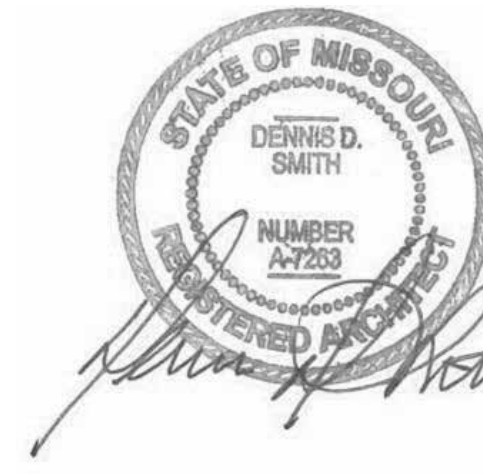

Project Title:

**Bakery Cafe#2406**  
1410 NE DOUGLAS ST  
LEES SUMMIT, MO 64086

PROTOTYPE - NEW CONSTRUCTION - SHELL



Consultant Copyright Placeholder

No.	Description	Date
1	PERMIT SET - TI	7/18/2022

## LIFE SAFETY PLAN

Project Number:

Sheet Number:

22169

Drawn By:

Author:

Issue Date:

07/05/2022

DFM:

DPM

DM:

DM

CPM:

CPM

G132