

August 10, 2022

Summit Homes
 120 SE 30th St.
 Lee's Summit, MO 64082

RE: Field Issue of blocking omission under kitchen island for Lot #73 Reserve at Stoney Creek – 1533 SW Georgetown Dr. Lee's Summit, MO 64082 – Permit # PRES20215093

Inspector Comments:

- Address holes drilled in floor joist above great room for PEX closer than 2" to one another.
- Address holes drilled for PEX in floor joist above foyer and office closer than 2" from one another.

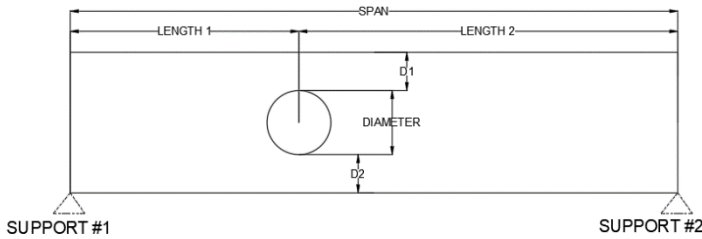

- D1 – at least 2"
- D2 – at least 2"
- Holes are within 2" of another hole
- Length 1 – varies
- Length 2 – varies
- Span – varies
- Support #1 – varies
- Support #2 – varies
- Location – above foyer, flex/office and in great room

Model No.	Total L	Ca.	DFSP		SPFH/F		Allowable Tension Loads (lbs)	Code Ref.
			Fasteners	End Length	Fasteners	End Length		
CMST12	40	12	(7/8) 16d (8/8) 16d	15" 30"	(8/8) 16d (8/8) 16d	36" 44"	9,215 9,215	1/2, 1/3, FL
CMST14	52	14	(8/8) 16d (8/8) 16d	26" 32"	(8/8) 16d (7/8) 16d	30" 34"	6,490 6,490	
CMST16	64	16	(8/8) 16d 16d spacer	20" 20"	(8/8) 16d 16d spacer	25" 25"	4,585	
CS14	100	14	(2/8) 16d (3/8) 8d	15" 16"	(3/8) 16d (3/8) 8d	16" 19"	2,490 2,490	
CS16	150	16	(2/8) 16d (2/8) 8d	11" 13"	(2/8) 16d (2/8) 8d	13" 14"	1,795 1,795	
CS18	200	18	(1/8) 16d (1/8) 8d	9" 11"	(1/8) 16d (1/8) 8d	11" 11"	1,570 1,570	
CS20	250	20	(1/2) 16d (1/2) 8d	6" 9"	(1/2) 16d (1/2) 8d	9" 9"	1,030 1,030	
CS22	300	22	(1/2) 16d (1/2) 8d	7" 9"	(1/2) 16d (1/2) 8d	7" 9"	845 845	

1. Fastener quantities and lengths are calculated using an increase for wind or seismic loading.
 2. Use half of the required nails in each member being connected to achieve the listed loads.
 3. Calculate the connector value for a reduced number of nails as follows:
 Allowable Load = (No. of Nails Used / No. of Nails in Table) x Table Load
 Example: CMST16 in DFSP with 40 nails total.
 Pair of the nails in each member being connected.
 Allowable Load = (40 Nails / 80) x 4,585 lb. = 2,292 lb.
 Allowable Load = 50 Nails / 80 x 4,585 lb. = 2,891 lb.
 4. Tension loads apply for length when installed vertically.
 5. Nails: 16d = 0.162" dia. x 2 1/2" long; 18d spacer = 0.141" dia. x 3 1/4" long;
 10d = 0.141" dia. x 2" long; (see pp. 26-27 for other nail sizes and information).

Recommended modifications:

- Install a 24" length of CS-16 strap on bottom of floor joist centered underneath holes per manufacturer's spec's.

Sincerely,



Bradley Huxol, PE

