

RELEASE FOR CONSTRUCTION
 AS NOTED FOR PLAN REVIEW
 DEVELOPMENT SERVICES
 LEE'S SUMMIT, MISSOURI
 08/01/2022

--- PROPOSED CONTOURS
 — AS-GRADED CONTOURS
 X=###.## = Actual asbuilt ground shots taken on July 29, 2022.
 Contours shown are asbuilt.

EXTENDED LOT AREA = 13,075.3 SF
 DRIVE AREA = 920.7 SF
 APPROACH AREA = 230.2 SF
 SIDEWALK AREA = 247.0 SF

- LEGEND**
- Gas Meter
 - Telephone or Fiber-Optic Pedestal
 - Cable TV Pedestal
 - Electric Pedestal
 - Light Pole
 - Mailbox
 - Fire Hydrant
 - Water Valve

PROPOSED HOUSE
 TOP FOUNDATION = 967.00
 GARAGE FLOOR = 966.00
 TOP FOOTING = 958.00
 BASEMENT FLOOR = 958.33
 DRIVE SLOPE = 5.8%

E = EXISTING ELEVATION
 F = PROPOSED FINAL ELEVATION
 G = ADJACENT GRADE AT EGRESS
 U/E = UTILITY EASEMENT
 B/L = BUILDING LINE
 S/Y/S = SIDE YARD SETBACK
 R/Y/S = REAR YARD SETBACK

- NOTES**
- BUILDER TO VERIFY ALL BUILDING ELEVATIONS AND DIMENSIONS.
 - THIS PLOT PLAN DOES NOT CONSTITUTE A BOUNDARY SURVEY.
 - THE EASEMENTS SHOWN ON THIS PLOT PLAN ARE TAKEN FROM THE FINAL PLAT. OTHER EASEMENTS MAY EXIST.

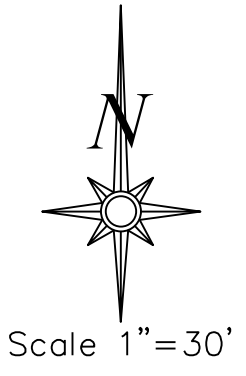

LOT INFORMATION

12,317 SQ. FT.
 MLO(REAR LEFT)=958.69
 MLO(REAR RIGHT)=949.84
 MSFE = 955.80
 ADDRESS
 2107 NW KILLARNEY LANE

LEGAL DESCRIPTION
 LOT 124, WOODSIDE RIDGE 1ST PLAT A SUBDIVISION AS RECORDED IN LEE'S SUMMIT, JACKSON COUNTY, MISSOURI.

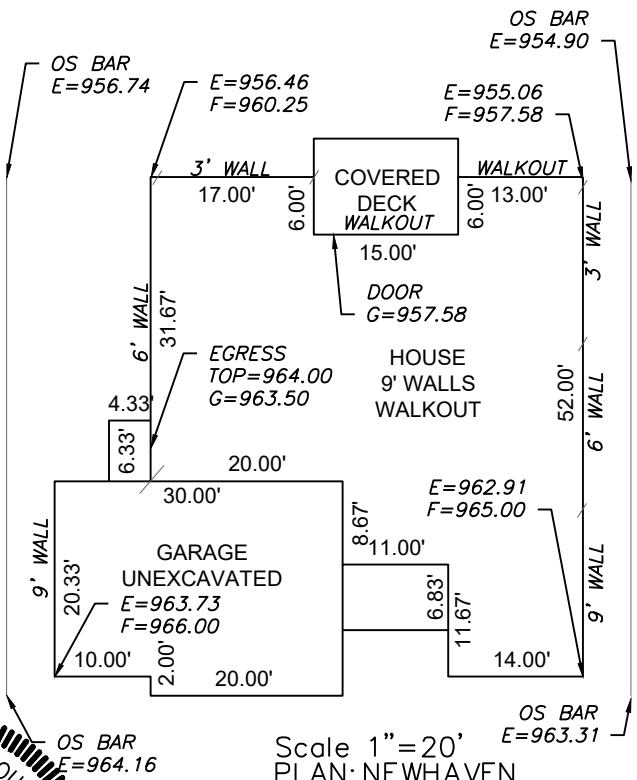

Scale 1"=20'
 PLAN: NEWHAVEN

ENGINEERING SOLUTIONS
 ENGINEERING & SURVEYING
 50 SE 30TH STREET
 LEE'S SUMMIT, MO 64082
 P:(816) 623-9888 F:(816)623-9849
 WWW.ENGINEERINGSSOLUTIONKCC.COM

STATE OF MISSOURI
 MATTHEW W. SCHLICH
 NUMBER
 PE-2006019708
 PROFESSIONAL ENGINEER

AS-GRADED PLOT PLAN - LOT 124

WOODSIDE RIDGE 1ST PLAT
 LEE'S SUMMIT, JACKSON COUNTY, MISSOURI

SUMMIT HOMES
 120 SE 30TH STREET
 LEE'S SUMMIT, MO 64082

PROJECT NO. 1	FILE NAME LOT 123, 124, WOODSIDE RIDGE	DATE 9/24/21	SHEET 1	OF 1
------------------	---	-----------------	------------	---------

THIS DRAWING IS NOT VALID UNLESS THE SIGNATURE, DATE AND SEAL OF THE ENGINEER WHO SUPERVISED THE PREPARATION OF THIS DRAWING HAS BEEN AFFIXED HERETO.