



July 18, 2022

Clover & Hive  
120 SE 30<sup>th</sup> St.  
Lee's Summit, MO 64082

**RE: Field Issue of CS-PF bracing for Lot #33 Osage - 2105 SW Rutherford Dr, Lee's Summit, MO 64082 – Permit # PRRES20213811**

Findings:

- 2x12 continuous header was installed above top plate in bed #1.
- Bed #1 requires CS-PF bracing per plans.
- Header spans approximately 13.5' and is supporting roof loads.
- Required strapping per CS-PF detail was attached to 2x members.

Recommendations:

- Install 3/8" minimum OSB on the interior side of the wall where CS-PF is required in bed #1.
  - Sheathing is only required in bracing locations indicated by hatching.
  - Existing exterior sheathing requires no modification.
- Sheathing shall extend from the bottom plate to the top edge of the 2x12 header.
- Sheathing shall be nailed at 6" OC field and 3" OC edge with 8d nails.
  - Nail pattern shall extend up to top of header.
- Install CS-16 straps on jack studs between windows to 2x12 header.
- See image below.

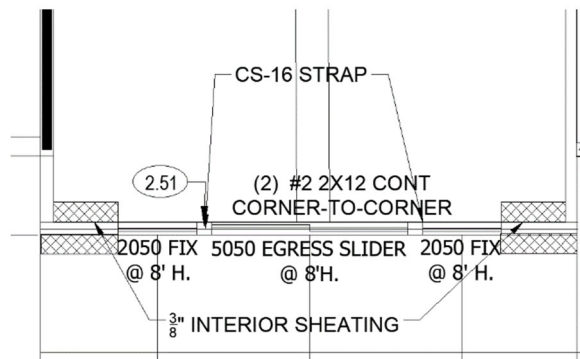

Sincerely,

Bradley Huxol, PE

