

Ordered by: TRUMARK HOMES
Description: LOT 152 HIGHLAND MEADOWS - 5th plat, LEES SUMMIT, MO.
Address: 2758 SW 12TH ST

Address: 2758 SW 12TH ST

Diagram illustrating a drainage swale cross-section and plan view. The cross-section shows a 20' wide swale with 6:1 side slopes and an 8' wide bottom. The bottom is labeled "DRAINAGE SWALE 100YR DEPTH 1.3" GRASSED". The plan view shows a 64.7' long swale with a 6:1 slope.

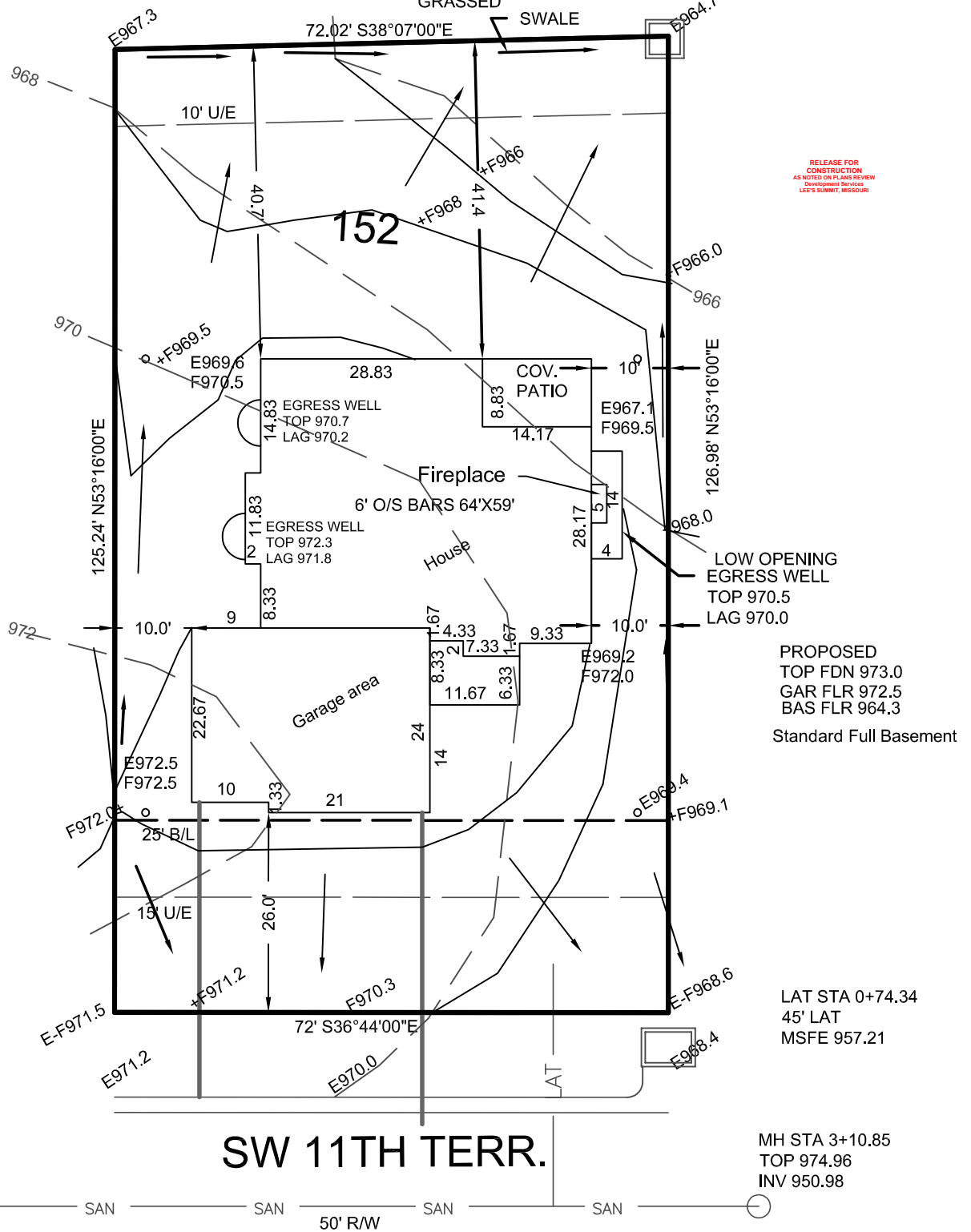

This plot plan is not an "as-built" survey as the house was staked prior to being built and cannot be used in place of a "Surveyors Real Property Report". This plot plan was prepared for use before and during foundation construction only and should not be used to establish property lines for fences or other structures. House staked as shown on this plot plan. House dimensions may have been assumed and contractor must check house dimensions shown and compare to the final house plans. Contractor to verify all elevations at job site. Builder must make final decision as to cuts and foundation heights at the job site, any floor elevations shown are shown as a guide only. Sanitary sewer and lateral elevations cannot be verified at time of staking, and it may be necessary to expose sanitary sewer service connection prior to excavation for foundation. Underground utilities and un-platted easements may not be shown. This does not constitute a boundary survey and builder must check to make sure description shown is correct with the deed for the property. It is recommended that no work be done until building permits are obtained and plot plan has been verified by local building codes authorities to comply with all setback and other restrictions.

= DRAINAGE PATTERN

CONSTRUCTION ENGINEERING SERVICES, INC.

16810-C East 40 Highway
Independence, MO 64055
(816)478-2323
lee@engineeringkc.com
SCALE: 1" = 20'
DATE: 06-28-2022
JOB NO: 18434

LEE BODENHEIMER, L.S.
Land Surveyor

