

HD Engineering & Design

Solutions for all your engineering and design needs

FRAMING INSPECTION ITEM RESPONSE

7/15/2022
SAB HOMES
RE: Solaia Plan (HF047)
2023 SW Wheatfield Ct
Lee's Summit, Mo

Our firm has been asked to address two rough framing inspection item for the home being built at the location listed above. At the time of inspection the home was in a rough framed state. Please find below our firms response and recommendations for the item.

Over-cut Hip at Dining Area

The framer has over-cut the seat cut of the hip rafter at the dining room and set it on top of the box vault. The location of the hip landing on the box vault will not prevent the box vault from transferring load as intended. The unsupported portion of the seat cut will require reinforcing the hip rafter, see below.

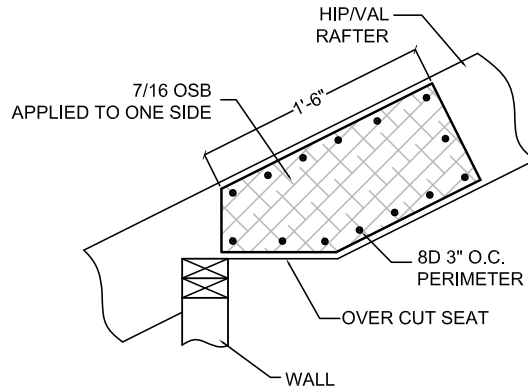

HIP/VAL OVER CUT SEAT REINFORCING DETAIL

1" = 1'-0"

Rafters Bearing on 2x4 on Edge

The rafters are bearing on a 2X4 on end, which is placed at the outside edge of the ceiling joists. Our firm recommends installing 2X6 blocking between each ceiling joist fastened with (2) #8X2 1/2" screws at each block. The screws shall be fastened through the 2X6 block to the 2X4 rim/rafter support. The blocking shall also be fastened to the ceiling joist with (2) 8d toenails.

This report has been prepared for the exclusive use of our client for specific application to the project discussed and has been prepared in accordance with generally accepted engineering practices. No warranties, either express or implied, are intended or made.

We appreciate the opportunity to be of service to you on this project. If you have any questions regarding this report, please contact us.

Very truly yours,
HD ENGINEERING & DESIGN, INC.

John Hulse, Principal



STRUCTURAL REVIEW
HD ENGINEERING & DESIGN
HD: 43055 DATE: 7/15/2022