

LEGEND

- Gas Meter
- Telephone or Fiber-Optic Pedestal
- Cable TV Pedestal
- Electric Pedestal
- Light Pole
- Mailbox
- Fire Hydrant
- Water Valve

PROPOSED HOUSE

TOP FOUNDATION = 969.25
GARAGE FLOOR = 968.25
TOP FOOTING = 960.25
BASEMENT FLOOR = 960.58
DRIVE SLOPE = 6.5%

E = EXISTING ELEVATION
F = PROPOSED FINAL ELEVATION
G = ADJACENT GRADE AT EGRESS
U/E = UTILITY EASEMENT
B/L = BUILDING LINE
S/Y/S = SIDE YARD SETBACK
R/Y/S = REAR YARD SETBACK

NOTES

1. BUILDER TO VERIFY ALL BUILDING ELEVATIONS AND DIMENSIONS.
2. THIS PLOT PLAN DOES NOT CONSTITUTE A BOUNDARY SURVEY.
3. THE EASEMENTS SHOWN ON THIS PLOT PLAN ARE TAKEN FROM THE FINAL PLAT. OTHER EASEMENTS MAY EXIST.

EXTENDED LOT AREA = 11,811.20 SF
DRIVE AREA = 906.46 SF
APPROACH AREA = 221.37 SF
SIDEWALK AREA = 252.02 SF

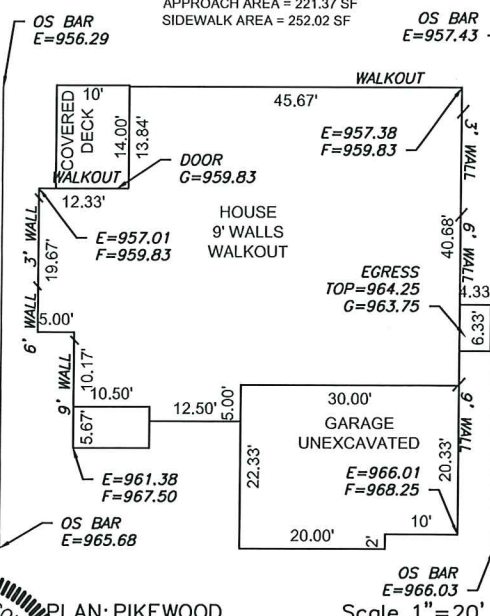

Scale 1"=30'

LOT INFORMATION

11,038 SQ. FT.
MSFE = 957.29
MLO (REAR LEFT) = 954.29
MLO (REAR RIGHT) = 956.37
ADDRESS
142 NW AMBERSHAM DRIVE

LEGAL DESCRIPTION

LOT 97, WOODSIDE RIDGE 1ST PLAT A SUBDIVISION AS RECORDED IN LEE'S SUMMIT, JACKSON COUNTY, MISSOURI.

PLOT PLAN - LOT 97

WOODSIDE RIDGE 1ST PLAT
LEE'S SUMMIT, JACKSON COUNTY, MISSOURI

SUMMIT HOMES
120 SE 30TH STREET
LEE'S SUMMIT, MO 64082

PROJECT NO.	FILE NAME	DATE	SHEET	OF
1	LOT 97, WOODSIDE RIDGE	8/24/2021	1	1

ENGINEERING SOLUTIONS
ENGINEERING & SURVEYING
50 SE 30TH STREET
LEE'S SUMMIT, MO 64082
P: (816) 623-9888 F: (816) 623-9849
WWW.ENGINEERINGSOLUTIONSKC.COM



THIS DRAWING IS NOT VALID UNLESS THE SIGNATURE, DATE AND SEAL OF THE ENGINEER WHO SUPERVISED THE PREPARATION OF THIS DRAWING HAS BEEN AFFIXED HERETO.