

June 21, 2022

Clover & Hive
120 SE 30th St.
Lee's Summit, MO 64082

RE: Field Issue of CS-PF bracing for Lot #33 Osage - 2105 SW Rutherford Dr, Lee's Summit, MO 64082 – Permit #
PRRES [REDACTED] 20213805

Findings:

- 2x12 continuous header was installed per plans in Bed #1.
- Header spans approximately 13.5' and is supporting roof loads.
- Required strapping per CS-PF detail was attached to 2x nailers.

Recommendations:

- Install a top plate for continuous 2x12 header.
- Fasten top plate to header per CS-PF detail.
- Re-attach required straps for CS-PF to top plate.
- See detail for more information.

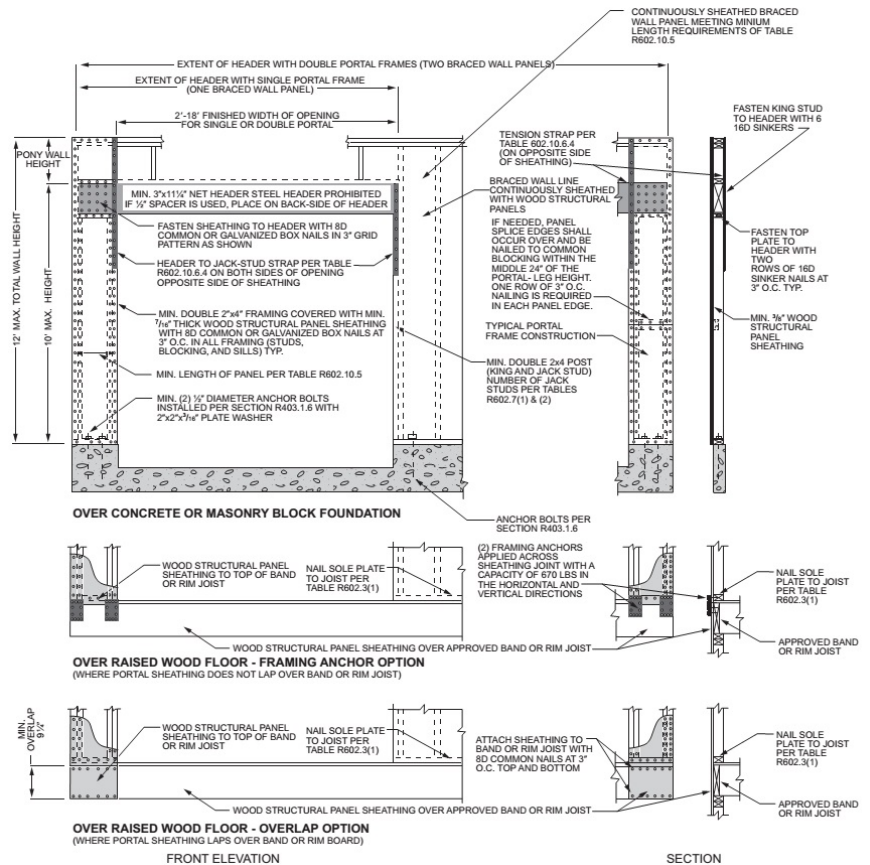

Sincerely,



Bradley Huxol, PE

