

Job Description: Chapel Ridge Townhomes Phase 5 - MEXTE - S

Maximo Work Order: 23891888

Region: SOUTH

TownCode: 09-01

Sector: 2408

Project #: 804952



SYSTEM PLANNING:
• FLOW ARROWS REFLECT GAS FEED PRIOR TO THIS WO
GAS CONTROL
• THERE ARE NO GAS CONTROL CONCERNS ON THIS WORK ORDER

CONSTRUCTION ENGINEERING:
• MAIN TO BE INSTALLED IN UTILITY EASEMENTS
• COORDINATE WITH RIGHT OF WAY FOR STAKING (SR # 5601563) AT LEAST 3 WEEKS PRIOR TO CONSTRUCTION

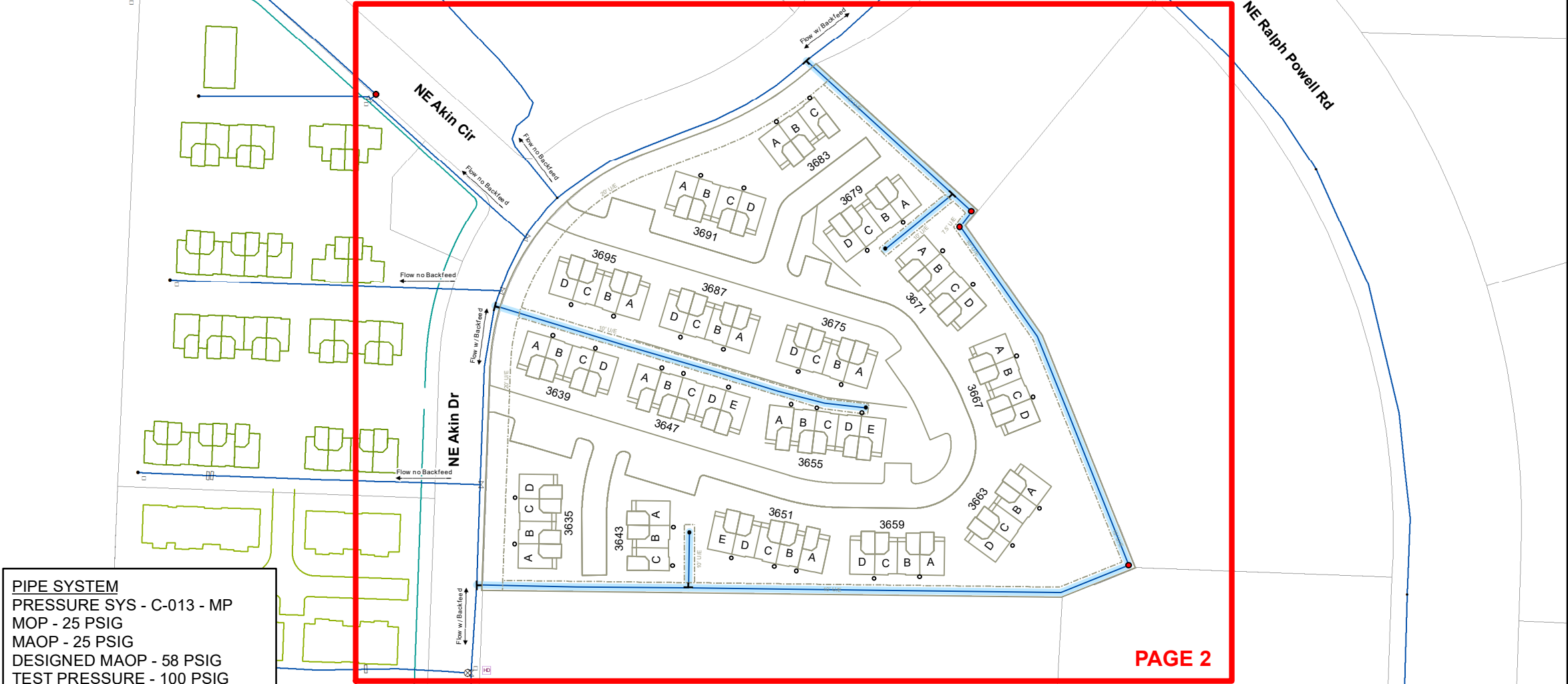

PIPE SYSTEM
PRESSURE SYS - C-013 - MP
MOP - 25 PSIG
MAOP - 25 PSIG
DESIGNED MAOP - 58 PSIG
TEST PRESSURE - 100 PSIG

ENVIRONMENTAL:
• THERE ARE NO ENVIRONMENTAL CONCERNS WITH THIS WORK ORDER

PIPELINE SAFETY AND COMPLIANCE/ CP:
• THERE ARE NO PIPELINE SAFETY AND COMPLIANCE CONCERNS FOR THIS WORK ORDER

1. INSTALL STEEL MAIN PER STD. 2310, 2320, AND 2350.
2. INSTALL PLASTIC MAIN PER STD. 2310 AND 2350.
3. FOR INCREASES IN MAXIMUM OPERATING PRESSURE SEE UPRATING SOP
4. SEE STD. 2310.3 FOR TRACE WIRE AND TEST STATION INFORMATION.
5. CONTRACTOR OR INTERNAL FOREMAN TO CHECK CATHODIC PROTECTION OF ALL EXISTING CATHODICALLY PROTECTED FACILITIES EXPOSED AND DIRECT STEPS NECESSARY TO MAINTAIN PROPER ISOLATION AND CATHODIC PROTECTION AS REQUIRED.
6. INSTALL ANODES AND/OR TEST STATIONS PER STD. 3680 PER INSTRUCTIONS FROM CORROSION PROTECTION INSPECTOR.
7. CREATE A PIPE OBSERVATION IN MAXIMO TO DOCUMENT EXPOSED PIPE CONDITIONS PER STD. 3610.5.4.
8. FOR UTILITY LOCATES, CALL ONE-CALL SYSTEM "811" OR (1-800-344-7483), AREA CATV AND ALL OTHER AFFECTED UTILITIES.
9. CONTACT ROW TO SECURE NECESSARY EASEMENTS AND FOR ANY SURVEY WORK @ 314-658-5497 OR 314-349-2933.
10. SQUEEZE-OFF PROCEDURE - STD. 2510.
11. SHUTDOWN PROCEDURE - STD. 10000. CONTACT SYSTEM CONTROL AT 314-658-5486
12. CONDUCT INITIAL CATHODIC PROTECTION SURVEY FOR NEW STEEL INSTALLATION PER STD. 3610
13. RADIOGRAPH PER STD.W 100.4
14. PRESSURE TEST PER STD. 2410 DOCUMENT ON PRESSURE TEST PAGE.
15. ABANDON GAS MAIN PER STD. 2620.
16. INSERT PLASTIC MAIN PER STD. 2320.
17. ANY QUESTIONS CONCERNING CONVERSION OF EXISTING MAINS CONTACT PIPELINE SAFETY AND COMPLIANCE @ 314-349-2932.
18. SPIRE PERSONNEL SHOULD FOLLOW STANDARD PRECAUTIONS REGARDING THE POTENTIAL FOR DRIP OIL TO BE PRESENT IN ACTIVE GAS MAINS AND ADHERE TO APPROVED PROCEDURES FOR MANAGEMENT/DISPOSAL OF ANY PIECES OF PIPE GENERATED IN THE COURSE OF ABANDONMENT. ANY DOCUMENTED DRIPS SHOULD BE CLEARED AND DRAINED BEFORE ABANDONMENT.
19. ALL PLASTIC MAIN TO BE TERMINATED PER STD 2310.2.4.
20. INSTALL EFV OR MANUAL SHUT-OFF VALVE PER STD 2385

Main & Service	Gas Valve	Take Point	Electronic Marker	End Cap	Vertical Ell	Street Car Tracks
Existing	Ball	Drip	Service Tee	Flange	Bend	RCP Reinforced Concrete Pipe
Install	Butterfly	Test Station	Stopper / Bottom Outlet	Insulated Flange	Exposed Pipe	CMP Corrugated Metal Pipe
Proposed	Gate	Regulator Station	Coupling	Cross	Rectifier	Contamination
Abandon	Plug	Meter Setting	Insulated Coupling	Reducer	Rectifier Cable	DNR Tanks
Gas Pipe Casing	Blow Down	Marker Post	Trace Wire Box	Tee	SteamLines	DNR Remediation

Check for
Work Order Authorization

Designer :	Revision Date(s):
KND	
Original Date:	
4/12/2022	

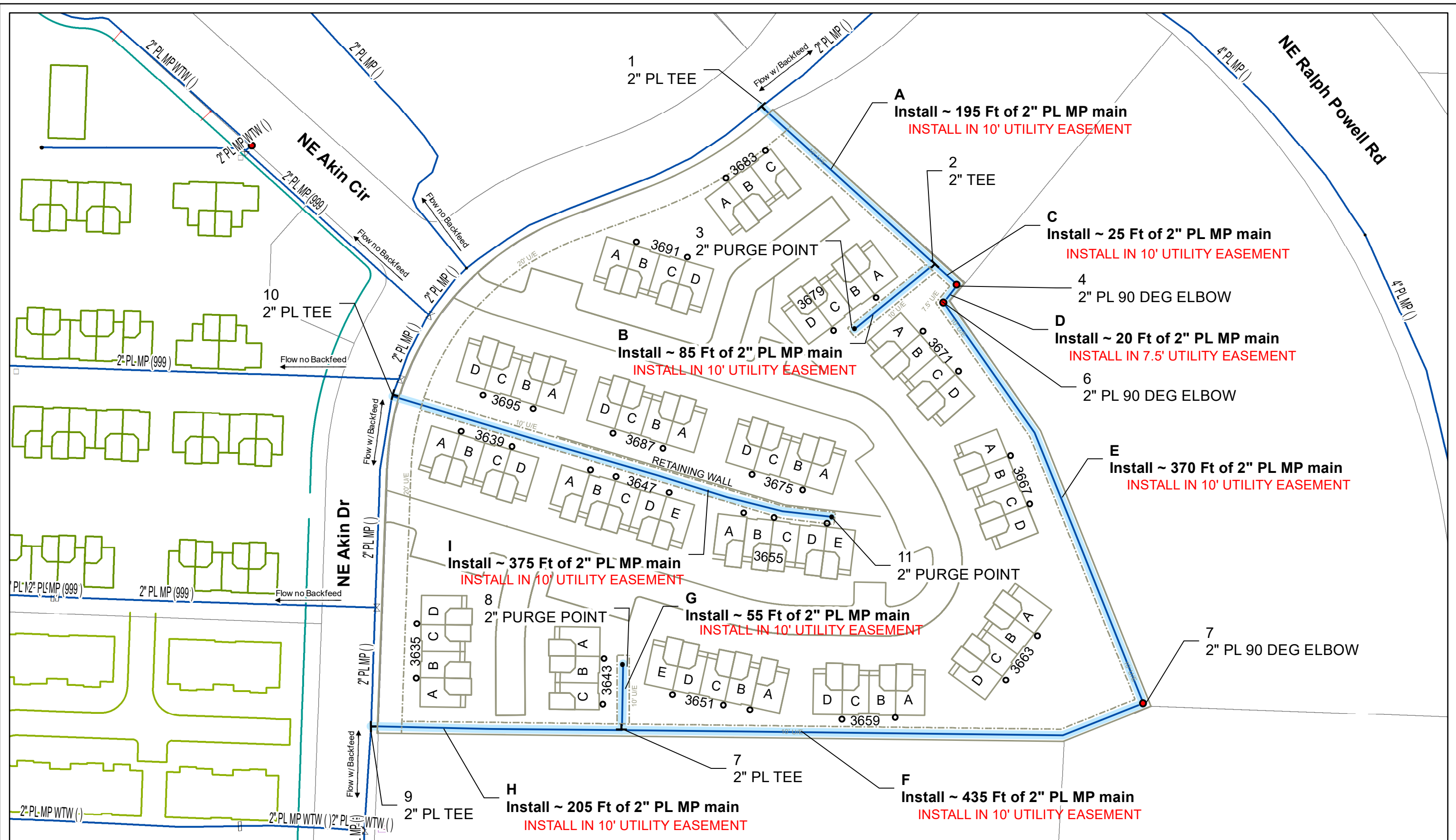

Job Description: Chapel Ridge Townhomes Phase 5 - MEXTE - S

Region: SOUTH

Sector: 2408

Maximo Work Order: 23891888

TownCode: 09-01

Project #: 804952



PRESSURE TEST OF GAS MAINS
(One Test Per Sheet)

Tie-in Number _____
Soap Test ☐ Yes ☐ No
Date: _____
Time: _____
System Gauge Pressure: _____
Signature: _____

Tie-in Number _____
Soap Test ☐ Yes ☐ No
Date: _____
Time: _____
System Gauge Pressure: _____
Signature: _____

Tie-in Number _____
Soap Test ☐ Yes ☐ No
Date: _____
Time: _____
System Gauge Pressure: _____
Signature: _____

Tie-in Number _____
Soap Test ☐ Yes ☐ No
Date: _____
Time: _____
System Gauge Pressure: _____
Signature: _____

Tie-in Number _____
Soap Test ☐ Yes ☐ No
Date: _____
Time: _____
System Gauge Pressure: _____
Signature: _____

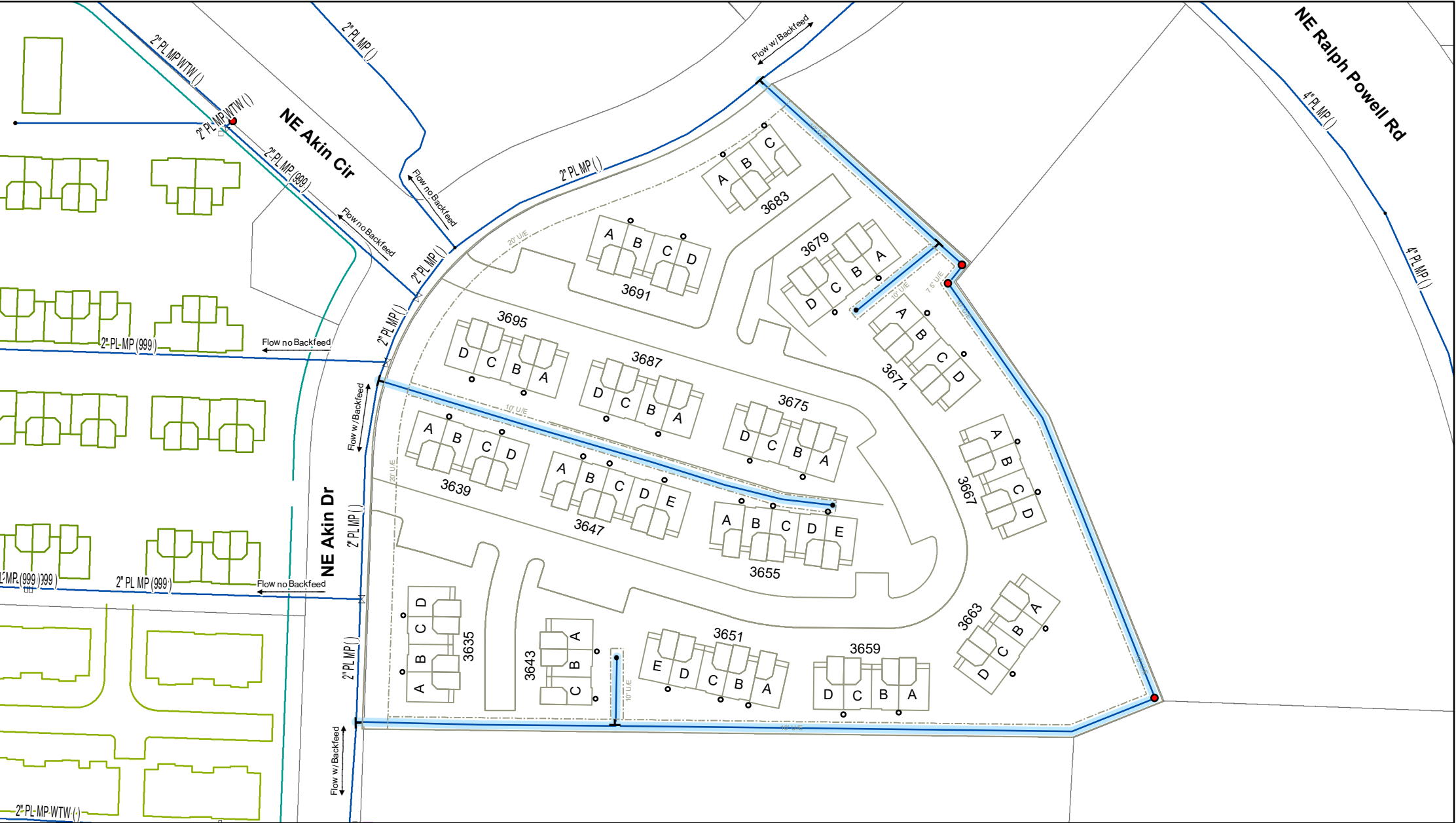

Pipe Size: _____ Length (ft): _____

Pipe Size: _____ Length (ft): _____

Pipe Size: _____ Length (ft): _____

Pressure System: TF \ SF \ FP \ HP \ IP \ MP \ LP

Test Medium: Water \ Air \ Gas Other: _____

Gauge Type:	Recording	Indicating	Dead Weight
Gauge I.D. :	_____	_____	_____
Calib. Date :	_____	_____	_____
Test Date:	_____		
Start Time:	_____	End Time:	_____
Start Press.:	_____	End Press. :	_____
Start Temp.*:	_____	End Temp.*:	_____

* Water or Pipe temperature, not ambient

If Discharge volume is over 1,000 gallons - Contact Lab for sample collection.

Note all leaks or failures, including cause, and corrective action taken in comments below.

SEE STD#2410 FOR PRESSURE TESTING.
SEE STD #3265 FOR LEAK SURVEY.
FOR ANY QUESTIONS REGARDING THE STANDARDS, PLEASE CONTACT PIPELINE SAFETY AND COMPLIANCE AT 314-349-2932 OR 314-354-6533

Conducted By:

Signature: _____

Date: _____

Printed Name: _____

Comments: _____