

**NEW WORK PLAN NOTES**

- CONNECT TO EXISTING COLD & HOT WATER, AND VENT PIPING IN THIS LOCATION. CONTRACTOR TO FIELD VERIFY EXACT LOCATION PRIOR TO CONSTRUCTION.
- ROUTE 1/2" COLD AND HOT WATER & 3" WASTE TO OWNER PROVIDED BLENDER STATION. COORDINATE FINAL EQUIPMENT TYPE, LOCATION AND WATER & WASTE PIPE SIZE REQUIREMENTS WITH OWNER AND EQUIPMENT PRIOR TO INSTALLATION. SAWCUT EXISTING FLOORING AS REQUIRED FOR CONNECTION. COORDINATE SAWCUTTING SCHEDULE AND PATHWAY WITH OWNER AND ARCHITECT PRIOR TO CUTTING. PATCHING OF FLOOR BY OTHERS. ALL BELOW GRADE PIPING TO BE PRE-SLEEVED FLEX PIPING, NO FITTINGS OR JOINTS ALLOWED BELOW GRADE. PROVIDE SHUTOFF VALVES FOR BELOW GRADE PIPING IN ACCESSIBLE LOCATION. PROVIDE HUB DRAIN FOR BLENDER STATION, COORDINATE FINAL LOCATION AND SIZE WITH OWNER.
- CONNECT TO EXISTING COLD WATER PIPING IN THIS LOCATION, CONTRACTOR TO FIELD VERIFY EXACT LOCATION PRIOR TO CONSTRUCTION. COORDINATE REMOVAL AND PUTBACK OF CEILING WITH ARCHITECT AND GENERAL CONTRACTOR.
- 1/2" COLD WATER DOWN TO ICE MAKER BOX NEAR OWNER FURNISHED BLENDERS. MAKE FINAL CONNECTION TO BLENDERS. PROVIDE SHUTOFF VALVE IN ACCESSIBLE LOCATION. COORDINATE FINAL LOCATION WITH OWNER AND GENERAL CONTRACTOR.
- PROVIDE 2" WASTE & 1-1/2" VENT FROM THREE OWNER PROVIDED BLENDER STATIONS, COORDINATE FINAL QUANTITIES AND LOCATION WITH OWNER.
- ROUTE WASTE AND VENT PIPING CONCEALED IN WALL OR CASEWORK TO SINK WASTE & VENT PIPING AND CONNECT INTO, CONTRACTOR TO FIELD VERIFY EXACT LOCATION.
- PROVIDE ELECTRIC UNIT HEATER INSTALLED UNDER SINK PER MANUFACTURER'S REQUIREMENTS AND DETAIL.
- CONNECT TO EXISTING FLOOR DRAIN IN THIS LOCATION, FIELD VERIFY EXACT LOCATION PRIOR TO CONSTRUCTION. COORDINATE SAW CUTTING AND FLOOR PUT BACK WITH OWNER AND GENERAL CONTRACTOR.
- CONNECT TO EXISTING VENT PIPING ABOVE RESTROOMS, FIELD VERIFY EXACT LOCATION PRIOR TO CONSTRUCTION.

**NEW WORK PLAN NOTES**

- REMOVE EXISTING SUPPLY DIFFUSER AND FLEX DUCT BACK TO HARD DUCT, SUPPLY DUCTWORK TO BE REUSED.
- REINSTALL EXISTING RETURN GRILLE WHERE INDICATED, CLEAN PRIOR TO REINSTALLATION.
- REINSTALL EXISTING THERMOSTAT IN LOCATION SHOWN, EXTEND CONTROL WIRING AS REQUIRED. COORDINATE FINAL LOCATION WITH OWNER AND EXISTING FURNITURE.
- CONNECT TO EXISTING SUPPLY DUCTWORK FOR NEW DIFFUSER, CONTRACTOR TO FIELD VERIFY PRIOR TO CONSTRUCTION.
- REMOVE EXISTING RETURN GRILLE FOR REINSTALLATION.

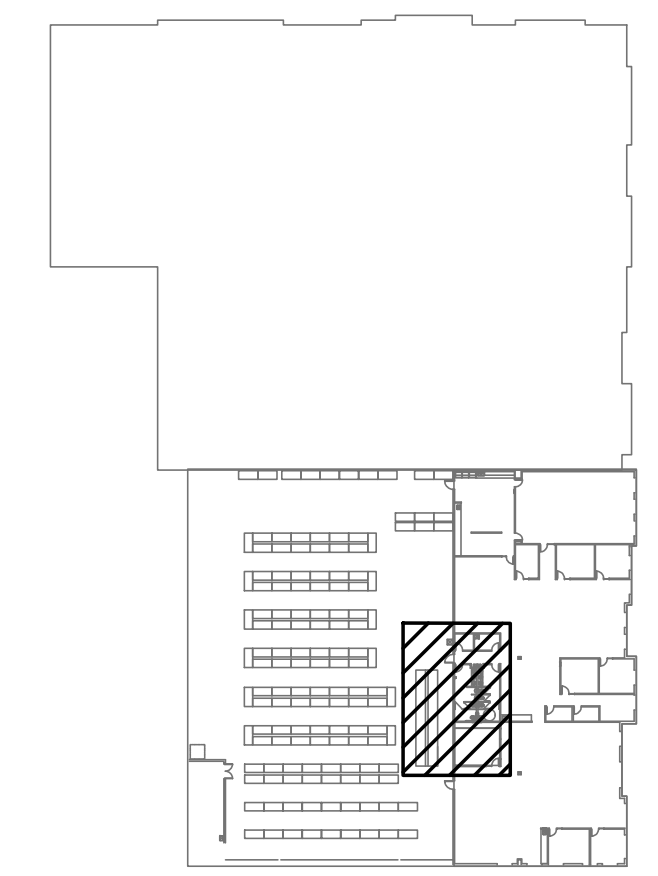

**KEY PLAN**

a proposal tenant finish for  
**F'Real Foods**  
2884 NE Independence Ave.  
Lee's Summit, MO 64064

date 03.21.22  
drawn by BHE  
checked by BHE  
revisions 5/16/22

△ CITY COMMENTS

sheet number  
**MP1**  
drawing type for permit  
project number 10079D

**1** floor plan - plumbing  
scale: 1/4" = 1'-0"

