



HD Engineering & Design

Solutions for all your engineering and design needs

FRAMING ADDENDUM

5/11/2022

SAB HOMES

RE: REDBUD PLAN (HF02)
2034 SW FARMFIELD LANE
LEE'S SUMMIT, MO.

-Address notched valley rafter and bearing

There are several locations where the hip and valley seat cuts are in need of additional reinforcing to ensure proper transfer of roof loads. The hip/valley rafters will be reinforced with a layer of 7/16 OSB attached as shown in the detail below.

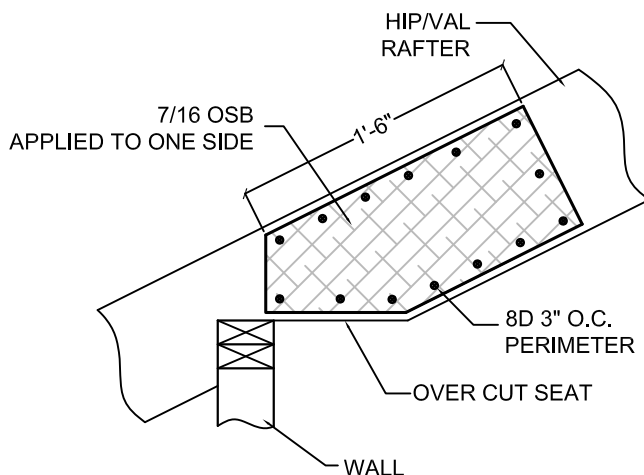

HIP/VAL OVER CUT SEAT REINFORCING DETAIL

1" = 1'-0"

This report has been prepared for the exclusive use of our client for specific application to the project discussed and has been prepared in accordance with generally accepted engineering practices. No warranties, either express or implied, are intended or made.

We appreciate the opportunity to be of service to you on this project. If you have any questions regarding this report, please contact us.

Very truly yours,
HD ENGINEERING & DESIGN, INC.

John Hulse, Principal

