

May 9, 2022

Summit Homes
120 SE 30th St.
Lee's Summit, MO 64082

RE: Field Issue of interior bracing behind fireplace and covered porch rafter connection for Lot #75 Manor at Stoney Creek – 1406 SW Georgetown Dr Lee's Summit, MO 64082 – Permit # PRRES20212067

Rafter connection at covered porch:

- Rafters are bearing on stacked top plate varying between (5-6) 2x4's.
- Rafters are 2x6 @ 24" OC spanning approximately 3.25'.

Recommended modifications:

Option 1

- Install CS-16 strap vertically connecting stacked top plates centered between each rafter.
- Install 2' length of CS-16 horizontally connecting each top plate splice.
- Strap shall be fastened to each 2x4 top plate member.
- Strap shall start at upper top plate and end at bottom top plate (see image below).
- Install with 8D nails or 2.5" structural screws.

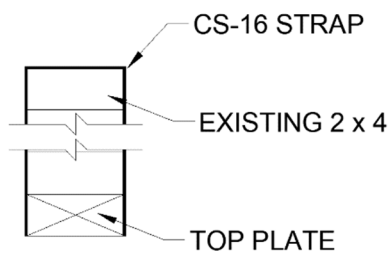

Option 2

- Install 6" SDWC truss screws alternating fastening direction between rafters to ensure stacked plates are connected.

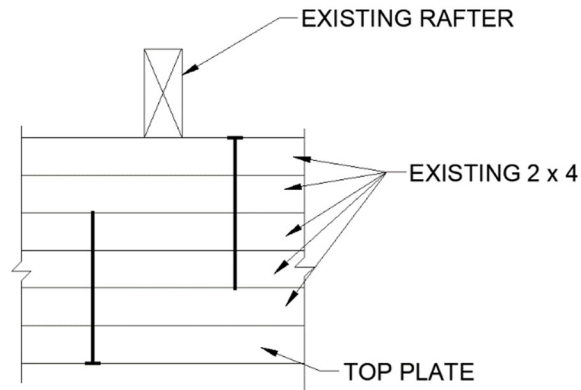

Interior bracing recommended modifications:

- Bracing shall be replaced with nail pattern on continuous 2x10 header:
 - 3" grid pattern at header to braced wall panel connection
 - Nail king and jack studs 12" OC
 - Attach with 10D nails.
- Fasten SDWC truss screws to band/rim joist below.
 - Install 1 truss screw at end king & jack stud of the cont. 2 x 10 header.
 - Truss screw is not required at king/jack stud behind fireplace.
 - Install screw at 30-degree max per manufacturers specs.

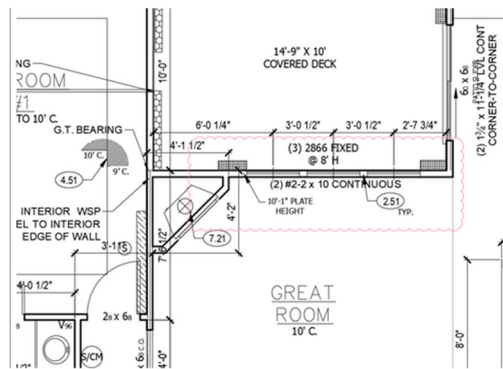

Sincerely,

BL 44

Bradley Huxol, PE

