

CONSTRUCTION STAKE PLOT PLAN

ACCU-SURV SURVEY COMPANY
 300 S. SUNSET LANE
 RAYMORE, MO. 64083
 (816) 322-1973 FAX (816)322-9522

ORDERED BY: Stewart Builders, LLC
 ADDRESS: 3208 S.W. Saddlebred Terrace
 DESCRIPTION: Lot 119, SUMMIT VIEW FARMS 4TH PLAT, a subdivision
 in the City of Lee's Summit, Jackson County, Missouri.

XXXXX ACCEPTABLE DAYLIGHT LOCATION ELEV. = 1009.9'
 ///// ACCEPTABLE WALK-OUT LOCATION ELEV. = 1008.2'
 2' WALL

RELEASE FOR CONSTRUCTION
 AS NOTED ON PLANS REVIEW
 DEVELOPMENT SERVICES
 LEE'S SUMMIT, MISSOURI
 05/05/2022 4:16:05

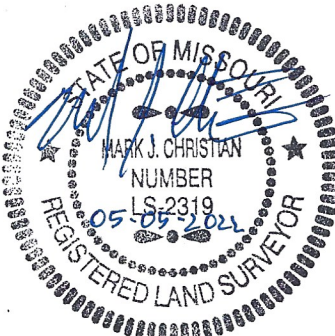
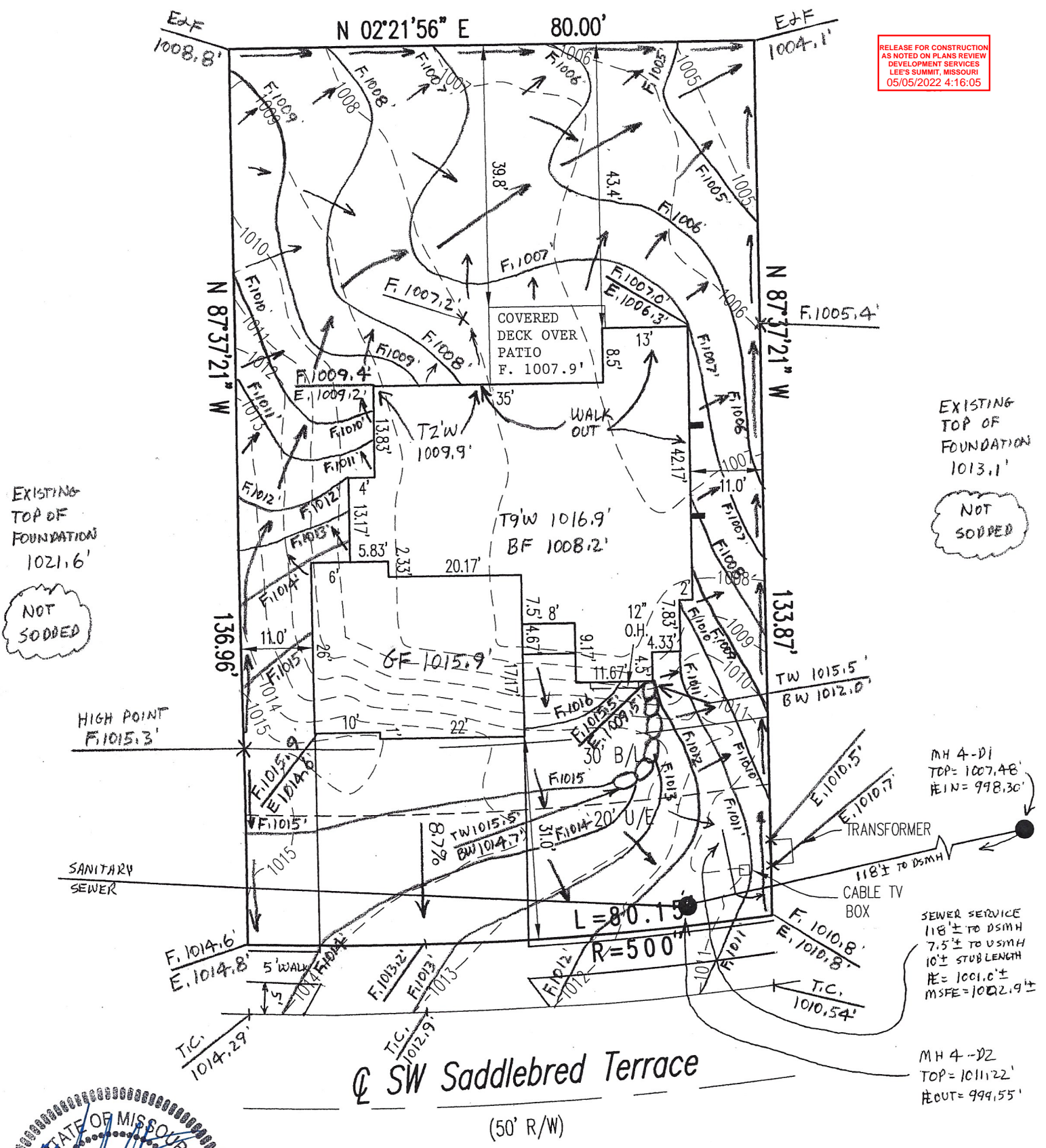

DECK APPROVAL REQUIRED
 PRIOR TO CONSTRUCTION
 AS-GRADED PLOT PLAN REQUIRED
 PRIOR TO SODDING

ATTENTION: Contractor to check and verify house dimensions and elevations at job site. We are not responsible for unknown or unplatted easements of any kind unless we are furnished the description of said easements before the field work is performed. NOTE: Final decision as to cuts and foundation height are to be made by builder on job site. NOTE: This plot plan is not to be construed as a boundary survey, and is not to be used for construction of fences. This plot plan is not an "AS-BUILT SURVEY" as the house shown was staked prior to construction and cannot be used in place of a "SURVEYOR'S REAL PROPERTY REPORT" or "MORTGAGE INSPECTION". ©Copyright 2022

SCALE: 1" = 20'
 DATE: 04-28-2022
 REVISED: 05-05-2022
 JOB NO: 22043