

RELEASE FOR CONSTRUCTION
AS NOTED FOR PLAN REVIEW
DEVELOPMENT SERVICES
LEE'S SUMMIT, MISSOURI

05/04/2022

GENERAL NOTES

1. GENERAL JOISTS TO BE 11-7/8" LPI20 PLUS @ 16" O.C. TYP. UNLESS OTHERWISE NOTED
2. ALL BLOCKING PER STRUCTURAL PLAN
3. LOADING TO BE 40 PSF LL - 15 PSF DL

AMERHART

400 MARSHVIEW DRIVE
SUN PRAIRIE, WI 53590
1-800-879-7123
1-608-834-2253

ADDITIONAL NOTES

1. ALWAYS READ PRODUCT BROCHURE BEFORE INSTALLATION OF EWP PRODUCTS.
2. REFER TO HOLE CHARTS PRIOR TO DRILLING PRODUCT.
3. THIS DOCUMENT IS INTENDED SOLEY AS A PLACEMENT PLAN. IT IS TO BE REVIEWED BY THE ENGINEER OF RECORD AND MUST MEET HIS/HER APPROVAL PRIOR TO INSTALLATION OF OUR PRODUCT.
4. THIS DOCUMENT IS NOT TO BE USED AS A REPLACEMENT FOR YOUR ORIGINAL STRUCTURAL PLANS.
5. LAYOUT, QUANTITY AND LENGTH TO BE VERIFIED BY CONTRACTOR.
6. IF WALLS ARE SPECIFIED IN THIS QUOTE, CONTRACTOR MUST VERIFY ALL DIMENSIONS AND ROUGH OPENING SIZES PRIOR TO CONSTRUCTION OF WALL. ROUGH OPENING SIZES ARE ESTIMATES ONLY. TALL WALL IS DESIGNED FOR VERTICAL LOADS AND DIRECT WIND LOADS ONLY. INLINE LATERAL BRACING OF THE BUILDING DIAPHRAGM IS TO BE ACCOUNTED FOR BY THE BUILDING DESIGNER/ENGINEER.

Ground Floor

I Joist

Label	Description	Width	Depth	Qty	Plies	Pcs	Length
J11	LPI 20Plus	2.5	9.5			9	34-0-0
J10	LPI 20Plus	2.5	9.5			11	32-0-0
J9	LPI 20Plus	2.5	9.5			6	28-0-0
J14	LPI 20Plus	2.5	9.5			6	26-0-0
J6	LPI 20Plus	2.5	9.5			6	18-0-0
J5	LPI 20Plus	2.5	9.5			1	16-0-0
J17	LPI 20Plus	2.5	9.5	1	2	2	12-0-0
J4	LPI 20Plus	2.5	9.5			1	12-0-0
J3	LPI 20Plus	2.5	9.5			5	10-0-0
J16	LPI 20Plus	2.5	9.5	1	2	2	10-0-0
J2	LPI 20Plus	2.5	9.5			3	6-0-0

Blocking

Label	Description	Width	Depth	Qty	Plies	Pcs	Length
BLK1	LPI 20 Plus	2.5	9.5			153	2-0-0

Rim Board

Label	Description	Width	Depth	Qty	Plies	Pcs	Length
R1	LP APA Rated OSB 1.125 X 9.5	1.125	9.5			19	12-0-0

LVL/LSL

Label	Description	Width	Depth	Qty	Plies	Pcs	Length
FB6	LP-LVL 2900Fb-2.0E	1.75	9.5	1	2	2	18-0-0
FB4	LP-LVL 2900Fb-2.0E	1.75	9.5	2	2	4	10-0-0

I JOIST LAYOUT/SUBMITTAL REVIEW

- ☐ REVIEWED & FOUND TO BE IN CONFORMANCE WITH REFERENCED PLAN
- ☒ FURNISH AS CORRECTED
- ☐ REVIEWED WITH CHANGES TO REFERENCED DRAWINGS
- ☐ REVISE AS NOTED & RESUBMIT

HD ENGINEERING & DESIGN
11655 W. 15TH ST. P.O. BOX 2232
SHAWNEE, KS 66214 WWW.HDENGINEERS.COM

SIGNED:

05/03/2022
DATE

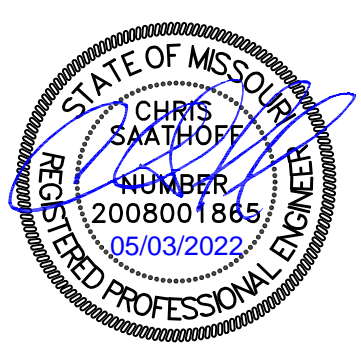

VERIFIED FOR
CONFORMANCE WITH
REFERENCED PLAN

A1 LP SOLID START RIM BOARD

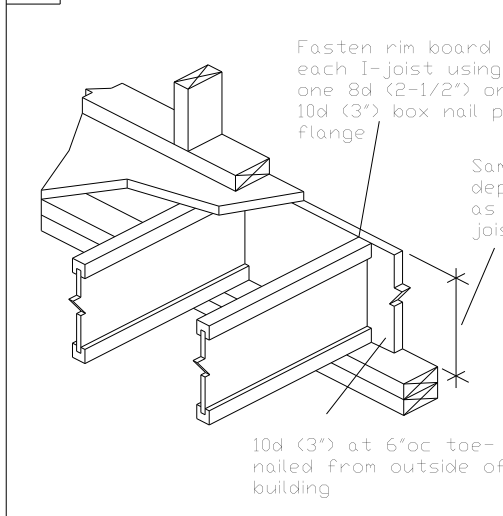

A7I SOLID RIM AS STARTER JOIST with Ladder Blocking

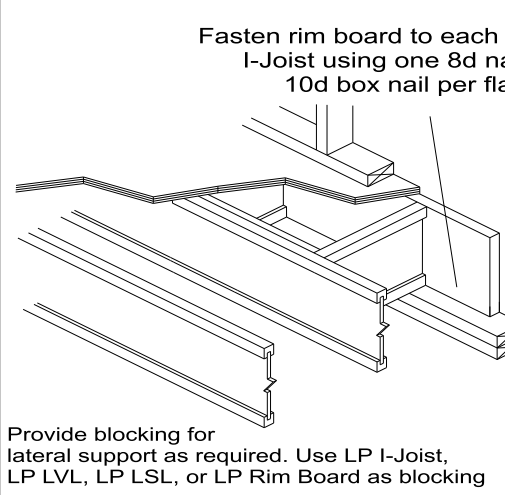

B4 JOIST NAILING AT INTERIOR SUPPORT

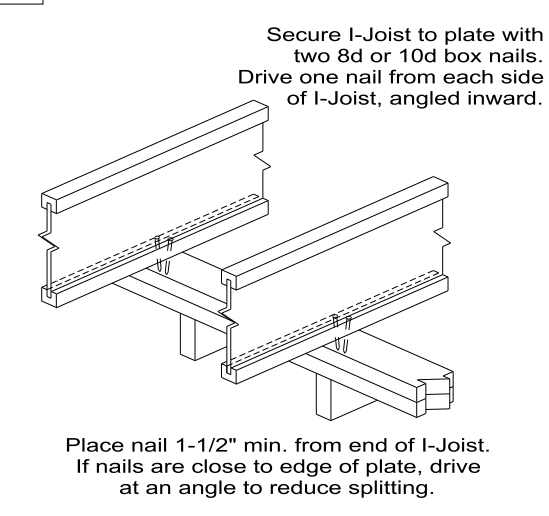

C1 CANTILEVER DETAIL No reinforcement required

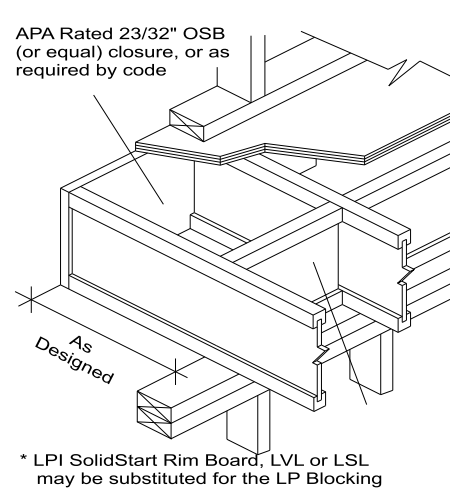

Layout Name

508 SE DAVID RD

Amerhart



Project
TL21100ATH

Created
July 06, 2021

Designer
Thomas Hamrick

Layout Name
508 SE DAVID RD

Dealer
TEAGUE LUMBER

Revised
July 06, 2021