

April 15, 2022

Summit Homes  
120 SE 30<sup>th</sup> St.  
Lee's Summit, MO 64082

**RE: Field Issue of over-driven nails and incorrect nail pattern for Lot #92 Manor at Stoney Creek – 4416 SW Alabaster Cir. Lee's Summit, MO 64082 – Permit # PRRES20211947**

Findings:

- Dining room requires CS-PF bracing per plans.
- More nails were fastened than CS-PF detail requires with a limited amount of nails being over-driven.

Recommendations:

- Additional nails shall be added adjacently to over-driven nails or between two over-driven nails.
- Nail head shall be flush with the surface of the sheathing.
- Nailing pattern shall meet the requirements of CS-PF bracing (see image below).

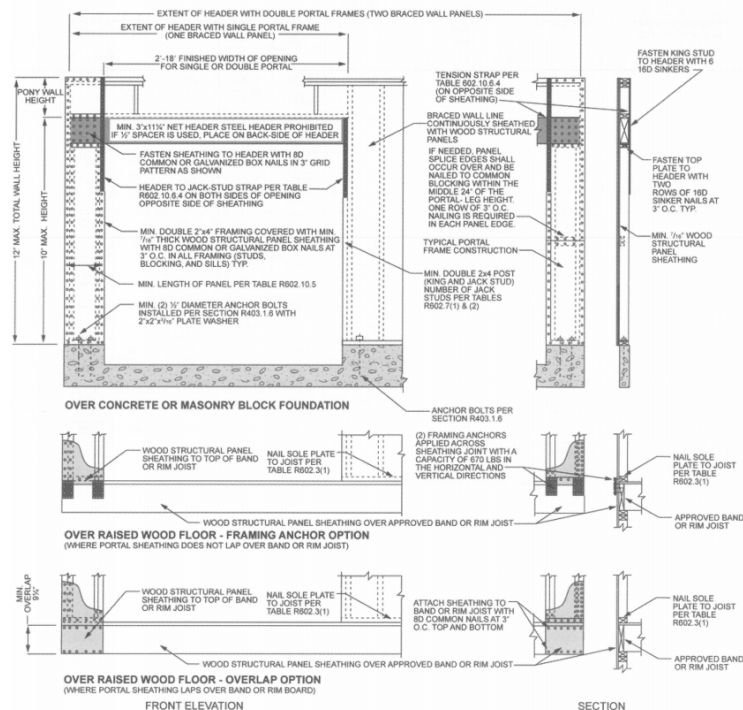

Sincerely,



Bradley Huxol, PE

