

RELEASE FOR
CONSTRUCTION
AS SHOWN ON THIS PLAN
UNLESS OTHERWISE NOTED
DATE: 03/03/2021

MH 1-3
STA 14+84.91
TOP 1024.14
FL IN 1009.34

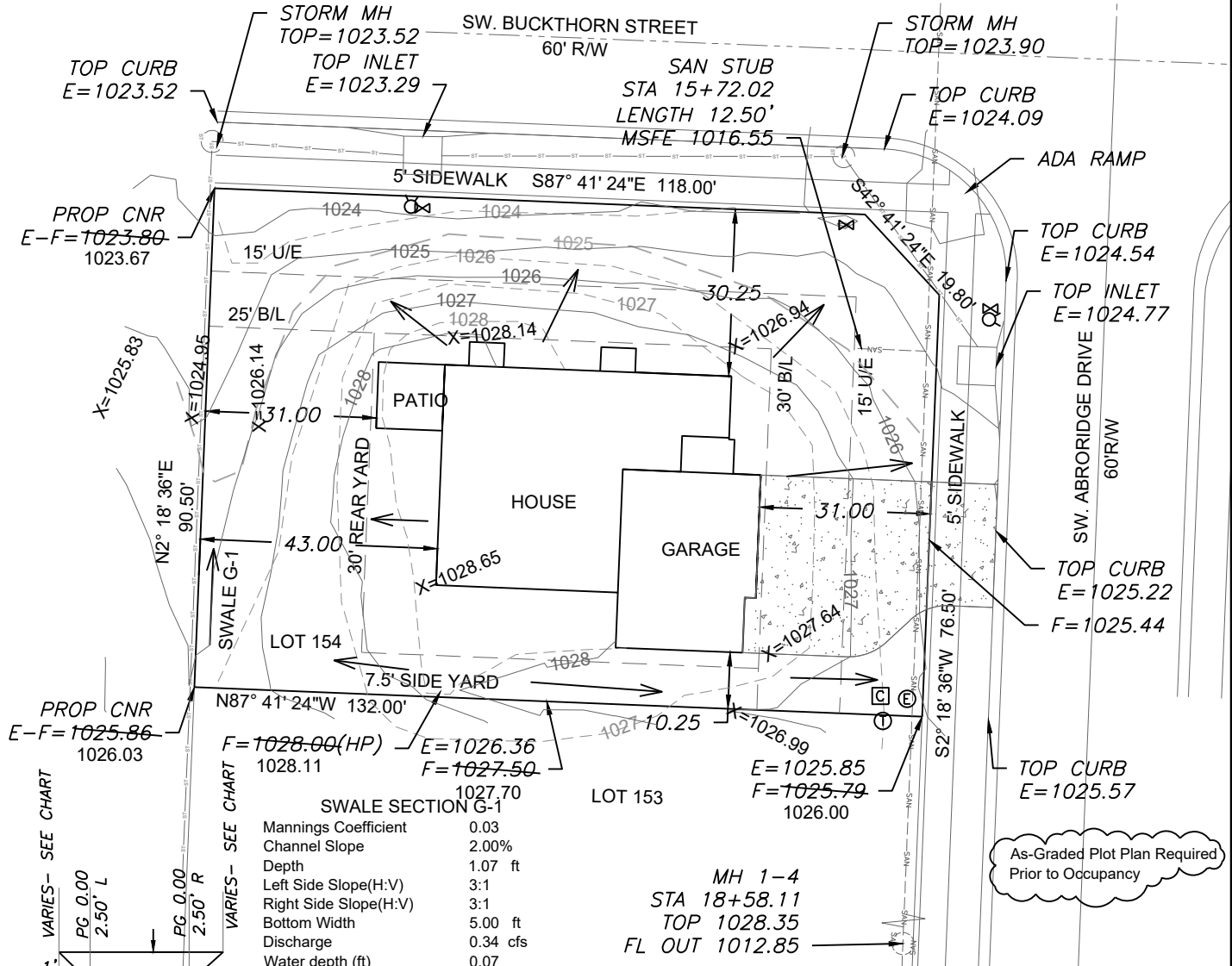

SWALE SECTION G-1

| | |
|-----------------------|----------|
| Mannings Coefficient | 0.03 |
| Channel Slope | 2.00% |
| Depth | 1.07 ft |
| Left Side Slope(H:V) | 3:1 |
| Right Side Slope(H:V) | 3:1 |
| Bottom Width | 5.00 ft |
| Discharge | 0.34 cfs |
| Water depth (ft) | 0.07 |

LEGEND

- Gas Meter
- Telephone or Fiber-Optic Pedestal
- Cable TV Pedestal
- Electric Pedestal
- Light Pole
- Mailbox
- Fire Hydrant
- Water Valve

PROPOSED HOUSE

TOP FOUNDATION = 1029.00
GARAGE FLOOR = 1027.50
TOP FOOTING = 1020.00
BASEMENT FLOOR = 1020.33
DRIVE SLOPE = 6.6%

E = EXISTING ELEVATION
F = PROPOSED FINAL ELEVATION
G = ADJACENT GRADE AT EGRESS
U/E = UTILITY EASEMENT
B/L = BUILDING LINE
S/Y/S = SIDE YARD SETBACK
R/Y/S = REAR YARD SETBACK

NOTES

1. BUILDER TO VERIFY ALL BUILDING ELEVATIONS AND DIMENSIONS.
2. THIS PLOT PLAN DOES NOT CONSTITUTE A BOUNDARY SURVEY.
3. THE EASEMENTS SHOWN ON THIS PLOT PLAN ARE TAKEN FROM THE FINAL PLAT. OTHER EASEMENTS MAY EXIST.

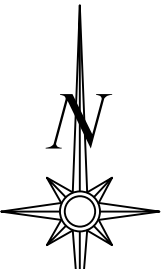
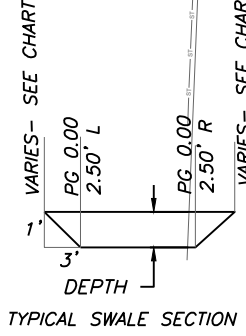

Scale 1"=30'

LOT INFORMATION

11,848 SQ. FT.
MSFE = 1016.55
ADDRESS
3200 SW ABRORIDGE DRIVE

LEGAL DESCRIPTION

LOT 154, HAWTHORN RIDGE
2ND PLAT A SUBDIVISION
AS RECORDED IN LEE
SUMMIT, JACKSON COUNTY,
MISSOURI.

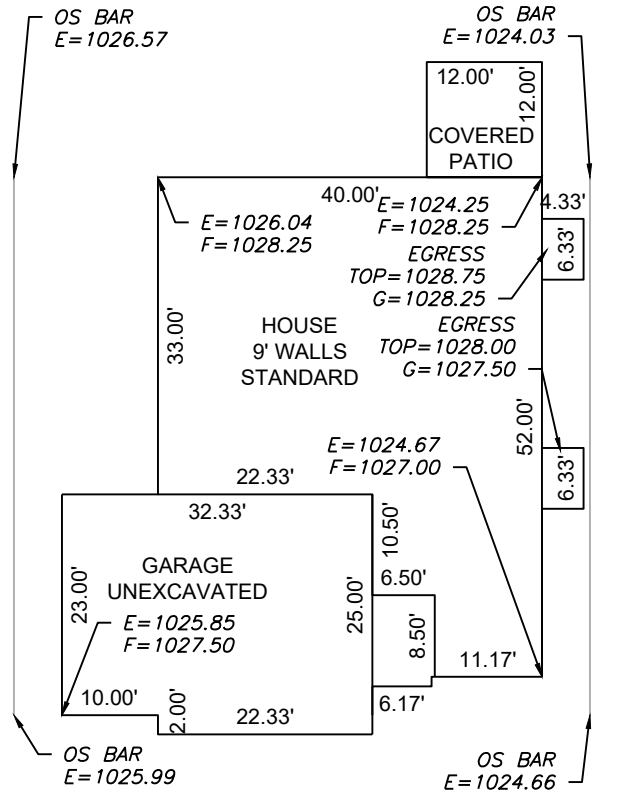

ENGINEERING SOLUTIONS
ENGINEERING & SURVEYING
50 SE 30TH STREET
LEE'S SUMMIT, MO 64082
P:(816) 623-9888 F:(816)623-9849
WWW.ENGINEERINGSOLUTIONKCC.COM

STATE OF MISSOURI
MATTHEW W. SCHLICHT
NUMBER
PE-2006019708
PROFESSIONAL ENGINEER

AS-GRADED PLOT PLAN - LOT 154

HAWTHORN RIDGE 2ND PLAT
LEE SUMMIT, JACKSON COUNTY, MISSOURI

SUMMIT HOMES
120 SE 30TH STREET
LEE SUMMIT, MO, 64082

| PROJECT NO. | FILE NAME | DATE | SHEET | OF |
|-------------|------------------------|----------|-------|----|
| 1 | LOT 154 HAWTHORN RIDGE | 3/3/2021 | 1 | 1 |

THIS DRAWING IS NOT VALID UNLESS THE SIGNATURE, DATE AND SEAL OF THE ENGINEER WHO SUPERVISED THE PREPARATION OF THIS DRAWING HAS BEEN AFFIXED HERETO.