



SCALE: 1"=20'
0 20

PREPARED FOR:
NEW MARK HOMES

AS-BUILT

LOT 3

WHISPERING WOODS FIRST PLAT

1920 SW RIVER RUN DRIVE

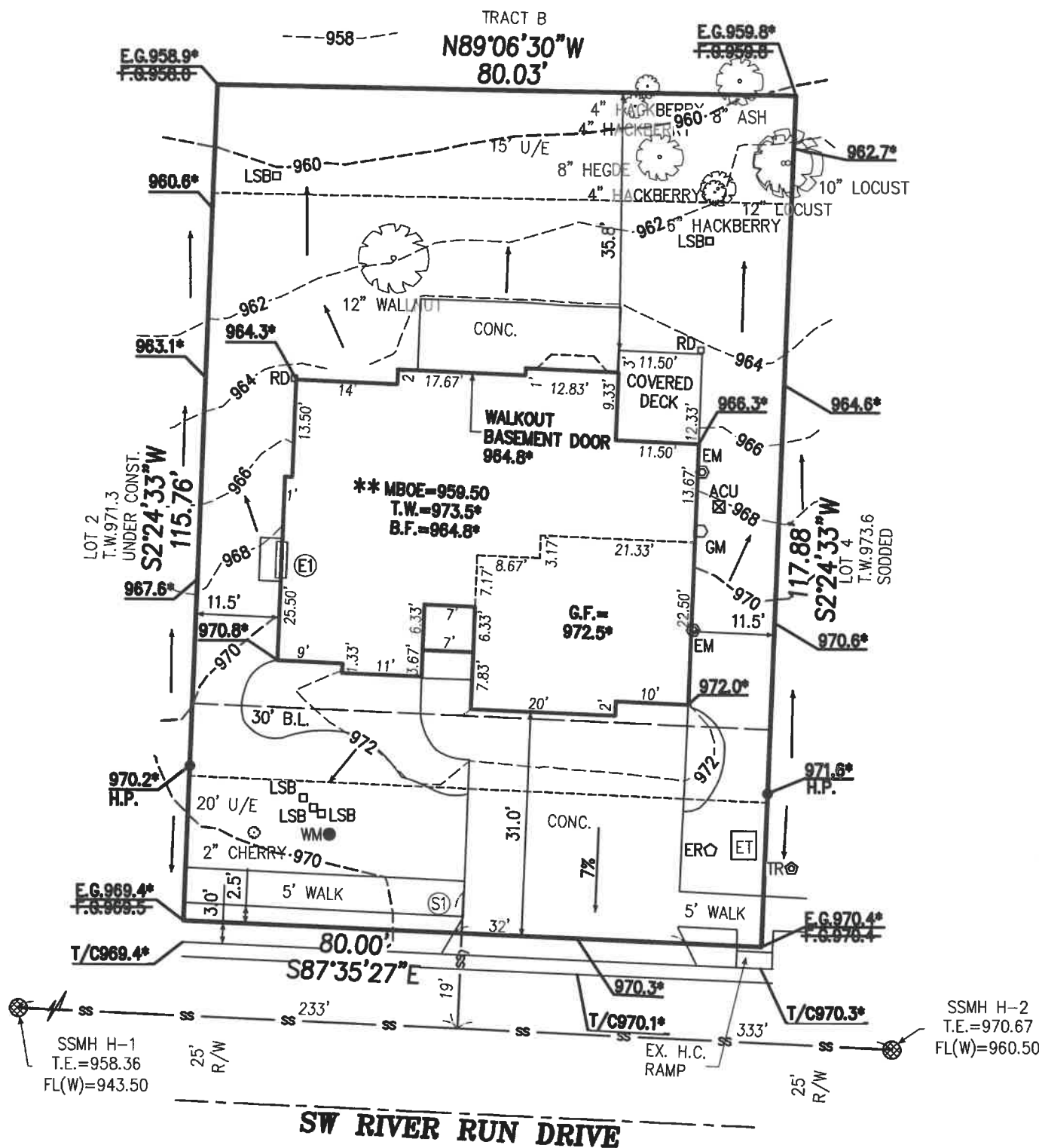

LEGEND

(S1) STUB LENGTH=19'
232' DDS
FL@EOS=959.25
MSFE=962.29

(E1) TOP EGRESS WELL=969.5*
F.G. EGRESS WELL=968.0*

** = MBOE=959.50
MINIMUM BUILDING
OPENING PER GRADING
PLAN
100YR WSEL=957.30
MBOE=964.73
BASEMENT FLOOR
WALKOUT AS SHOWN

E.G.= EXISTING GRADE
F.G.= FINISHED GRADE
T/C= TOP OF CURB
T.E.= TOP ELEVATION
H.P.= HIGH POINT
B.F.= BASEMENT FLOOR
T.W.= TOP OF WALL
G.F.= GARAGE FLOOR
FL= FLOW LINE
EGL=ENERGY GRADE LEVEL
MLO=MINIMUM LOW OPENING
L/E=LANDSCAPE EASEMENT
P.B.=PERIPHERAL BOUNDARY
WRWW=WATER RESISTANT WND. WELL
S/E=SANITARY SEWER EASEMENT
E/I=ENGINEERING & INSPECTION

LOT AREA=9,346 SQ. FT.

AS-BUILT GRADING
DATE FIELD VERIFIED: 12/9/21
973.5* DENOTES AS-BUILT ELEVATION

CONTOURS SHOWN HEREON
ARE AS-BUILT.

LEGAL DESCRIPTION:
LOT 3, WHISPERING WOODS FIRST
PLAT, A SUBDIVISION OF LAND IN
THE CITY OF LEE'S SUMMIT,
JACKSON COUNTY, MISSOURI.

NOTES:

1. SQUARE FOOTAGE OF DRIVEWAY AS SHOWN: 915
2. 6 INCHES OF CLEARANCE IS REQUIRED FROM THE FINISHED GRADE TO THE SILL PLATE OF THE STRUCTURE. THE GRADE SHALL FALL A MINIMUM OF 6 INCHES WITH THE FIRST 10 FEET FROM THE FOUNDATION OF THE BUILDING.
3. CLIENT TO VERIFY ALL WALL HEIGHTS AS SHOWN PRIOR TO EXCAVATION AND POURING OF FOUNDATION.
4. REVISED 10/30/20 CORRECTED ADDRESS
5. LOT IS ALREADY SODDED.
6. REVISED: 2/25/22 ADDRESSED CITY COMMENTS.

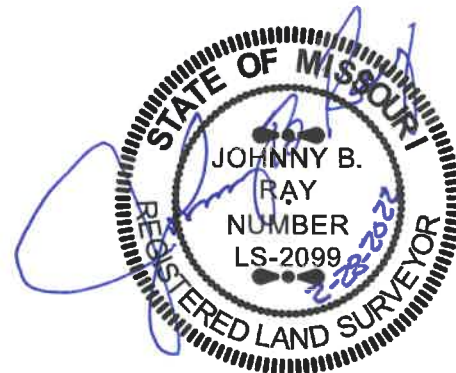

PLANNING
ENGINEERING
IMPLEMENTATION

PHELPS ENGINEERING, INC
1270 N. Winchester
Olathe, Kansas 66061
(913) 393-1155
Fax (913) 393-1166

PROJECT NO. 200881
DATE: 12/10/21
BY: DJP

Note: Builder shall obtain a
building permit prior to any
construction to ensure that this
site plan meets City approval.

This plot plan was prepared for
foundation construction only. All
dimensions to be verified by
builder and all grades as shown
shall be verified by builder to
insure proper drainage and
adequate fall to sewer. No title
information was furnished on
this drawing. Not responsible for
unplatted easements.

CERTIFICATE OF AUTHORIZATION
KANSAS
LAND SURVEYING - LS-82
ENGINEERING - E-391
MISSOURI
LAND SURVEYING-2007001128
ENGINEERING-2007005058