



# HD Engineering & Design

*Solutions for all your engineering and design needs*

2-11-22

STEWART BUILDERS

RE: HARRISON II LOT 64 SVF  
2316 SW CHASE CIR  
LEE'S SUMMIT, MO

Our firm has been asked to address framing inspection items for the home being built at the location listed above. At the time of inspection the home was in a rough framed state.

## Garage LVL Header

The electrician has drilled a vertical hole between the LVL plies over the center of the narrow walls. The hole locations are at the end sections of the LVL between to bearing points. The location of the hole will not affect the LVL's ability to transfer load as intended.

Our firm recommends approval of this item as framed.

## Clipped Joist Over Two Car

The framer has clipped the top of the floor joist at the front wall of the garage. The clip extends inside the interior face of the wall. To allow the joist to transfer load as intended our firm recommends blocking the joist, see below.

With the addition of the blocking our firm recommends approval of this item.

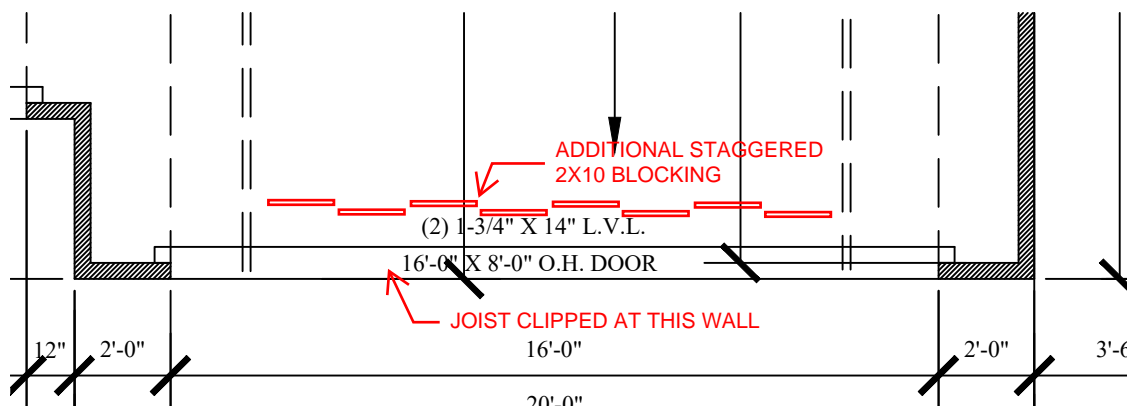

Very truly yours,  
HD ENGINEERING & DESIGN, INC.

  
John Hulse, Principal



THIS DOCUMENT CONTAINS  
COPYRIGHTED MATERIAL AND  
CONFIDENTIAL INFORMATION  
BELONGING TO HD ENGINEERING.  
UNAUTHORIZED USE, DISCLOSURE,  
DISSEMINATION, OR DUPLICATION OF  
ANY OF THE INFORMATION  
CONTAINED HEREIN MAY RESULT IN  
LIABILITY UNDER APPLICABLE LAW.

STRUCTURAL REVIEW  
HD ENGINEERING & DESIGN  
HD: 39124 DATE: 4/22/2020