



February 10, 2022

Distribution:

Craig Bruning
New Mark Homes
5207 NW Crooked Road
Parkville, MO 64152

Project:

20-154 Lot 136 Woodside Ridge
2159 NW Killarney Ln.
Lee's Summit, Missouri

COMPLIANCE LETTER

Apex Engineers, Inc. has been asked to address comments from the city rough-in inspection for the residence at the address above.

1. The tight drilling spacing of wiring holes near the breaker box exceed IRC specifications for holes in a joist.
 - **After review, the 2x10's with the approximate 1"x16" area of holes drilled through can be reinforced with OSB or Plywood of ½" nominal thickness on a single side of the joist per the attached detail.**

Please call if Apex Engineers, Inc. can be of further assistance. This report does not constitute approval from the enforcing jurisdiction, nor does it constitute approval of said installations. Special inspections shall be provided to verify installation is done in accordance with this report.

LIMITATIONS

The scope of our services includes only those items specifically addressed herein. No attempt was made to design or check the design of any structural members other than those specifically addressed herein. All other items are outside the scope of this inspection; including but not limited to, any environmental assessment (such as, but not limited to mold, mildew, presence of hazardous or toxic materials in the soil, surface water, ground water, etc.).

In addition, the scope our services does not include any evaluation of the building or site for job-site safety and/or hazardous conditions. All construction shall be performed in compliance with IRC and OSHA standards at all times. Our firm has not been retained to examine the site or building for any of these conditions. In addition, the contractor shall retain sole responsibility for the quality of work, for adhering to plans, specifications, appropriate codes, and, for repairing defects, deficiencies or omission, regardless of when they are found

Best Regards,
Apex Engineers, Inc.

Thomas Adams, P.E.
Project Engineer

Bryce D. Crady, P.E.
Principal





Project: 20-154 LOT 136 WOODSIDE RIDGE

Sheet: 1/1

Engineer: TDA

Date: 2/10/2022

info@apex-engineers.com | www.apex-engineers.com

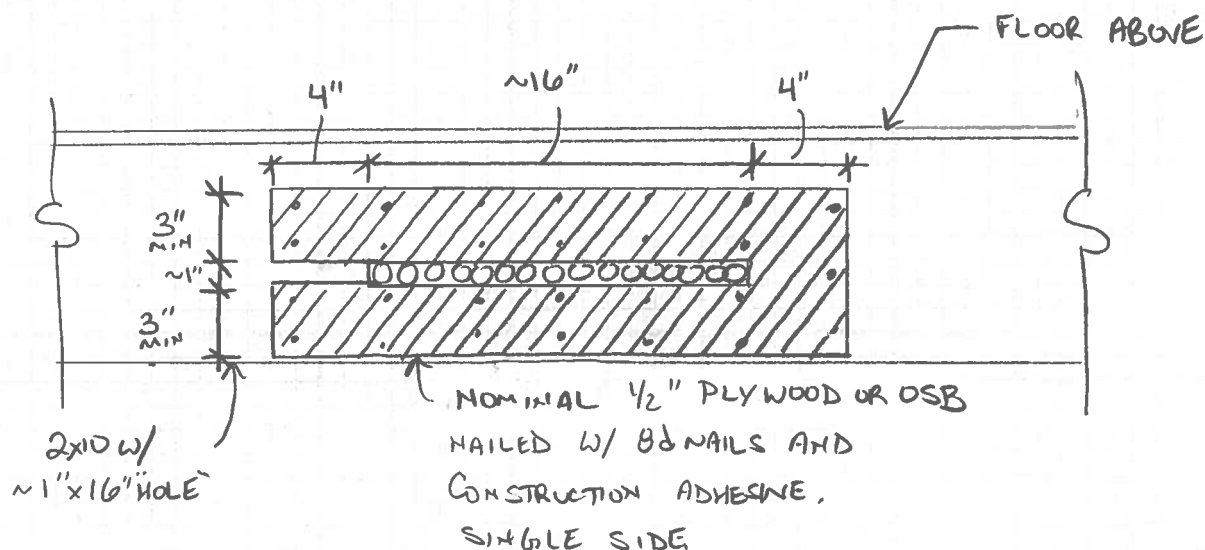

JOIST REPAIR AT BREAKER BOX

N.T.S.