

PROJECT SCHEDULE		
SIGN TYPE/ DESCRIPTION:	QTY.:	PG.
A. ILLUM. FACE-LIT/ SIDE-LIT LETTERSET (LC05-PC-1)	ONE (1)	4
B. ILLUM. SUSPENDED CABINET W/ PUSH-THRUS (LC05-HC-EE)	ONE (1)	6
C. ILLUM. EDGE-LIT "RAYBAN" LOGO SIGN (RB-MTL)	ONE (1)	8
D. ILLUM. EDGE-LIT HORIZONTAL LOGO SIGN (OAK-EL-HL.2)	ONE (1)	11
E. ILLUM. EDGE-LIT CHANNEL LETTERS (LC05-EL-LC)	ONE (1)	13
F. ILLUM EDGE-LIT LETTERS ON BACKER PANEL (LC07-BP-EL-LL-INT)	ONE (1)	15
G. ILLUM EDGE-LIT LETTERS ON BACKER PANEL (LC07-BP-EL-C-INT)	ONE (1)	14

PROJECT:

LENSCRAFTERS

SUMMIT WOOD CROSSING

1700 NW CHIPMAN RD.

LEES SUMMIT, MO 64081

STORE # 1643    SPACE # M-6B

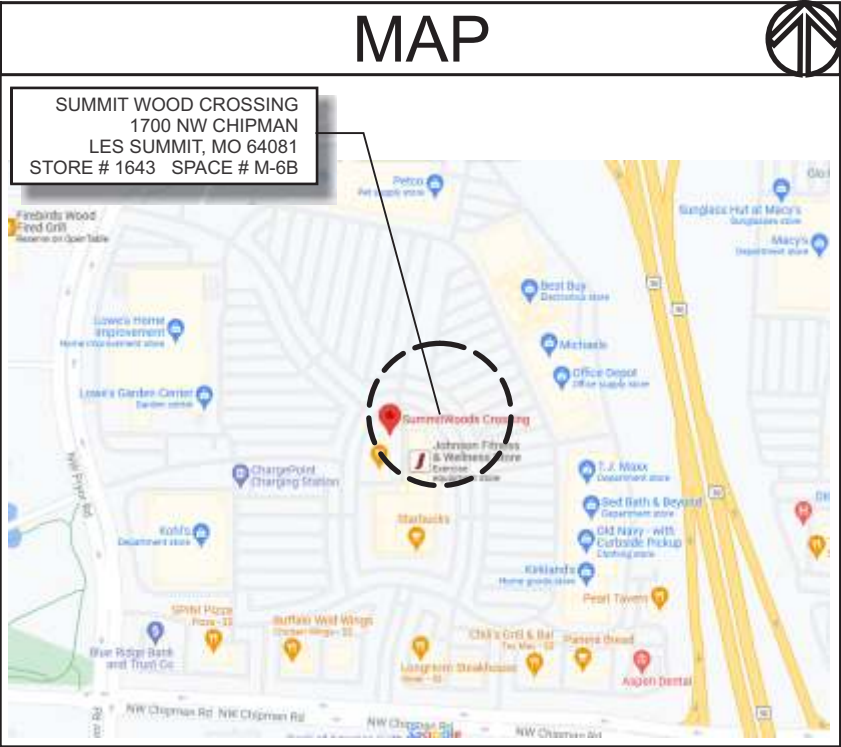

REVISIONS			
#	DATE	DB	NOTES
R1	11/17/2021	KH	INCREASED SIZE OF STOREFRONT SIGN
R2	1.6.2022	JH	•ADDED STOREFRONT ELEVATION w DIMENSIONS.



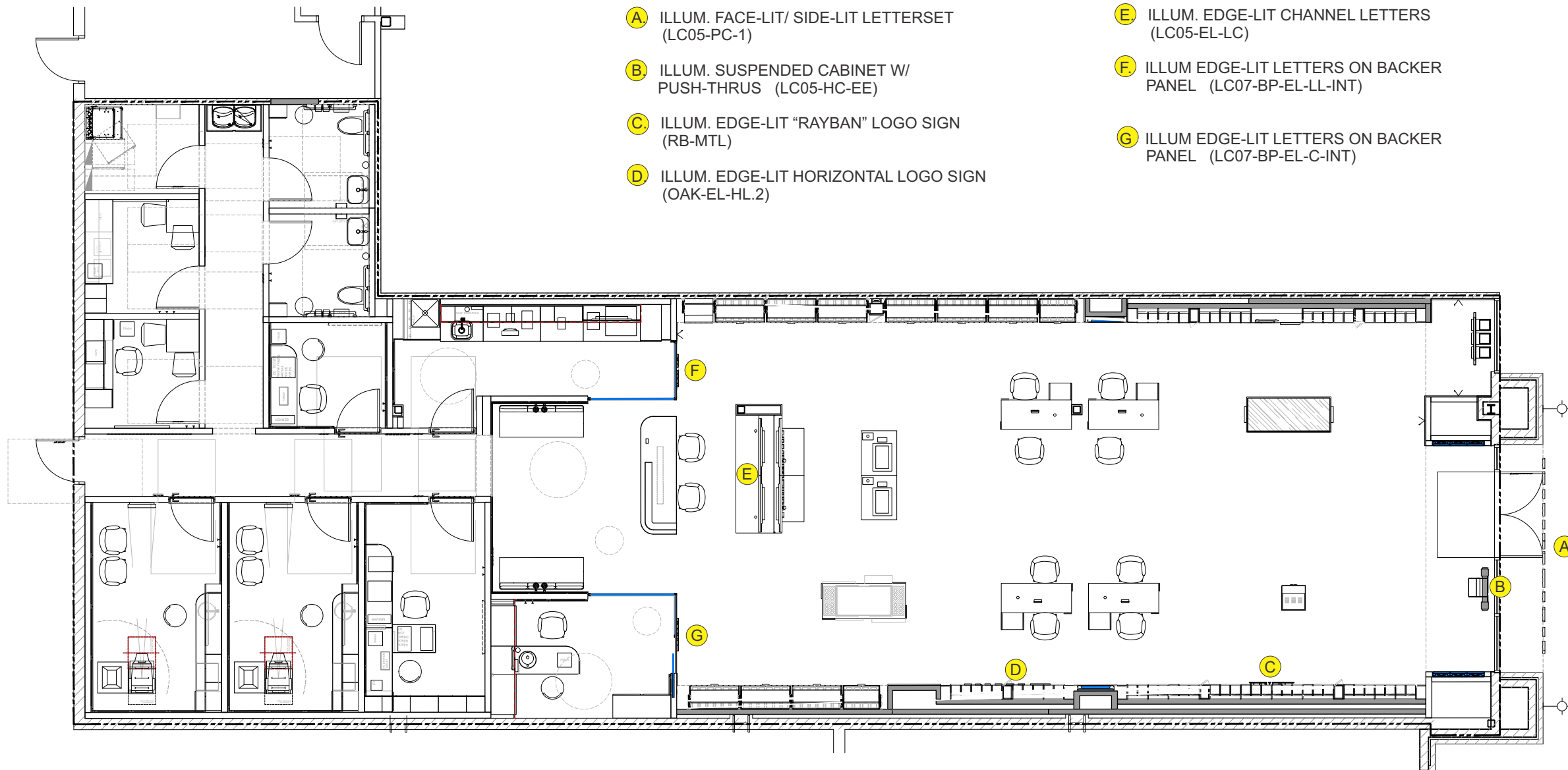

A. ILLUM. FACE-LIT/ SIDE-LIT LETTERSET  
(LC05-PC-1)

B. ILLUM. SUSPENDED CABINET W/  
PUSH-THRUS (LC05-HC-EE)

C. ILLUM. EDGE-LIT "RAYBAN" LOGO SIGN  
(RB-MTL)

D. ILLUM. EDGE-LIT HORIZONTAL LOGO SIGN  
(OAK-EL-HL.2)

E. ILLUM. EDGE-LIT CHANNEL LETTERS  
(LC05-EL-LC)

F. ILLUM EDGE-LIT LETTERS ON BACKER  
PANEL (LC07-BP-EL-LL-INT)

G. ILLUM EDGE-LIT LETTERS ON BACKER  
PANEL (LC07-BP-EL-C-INT)

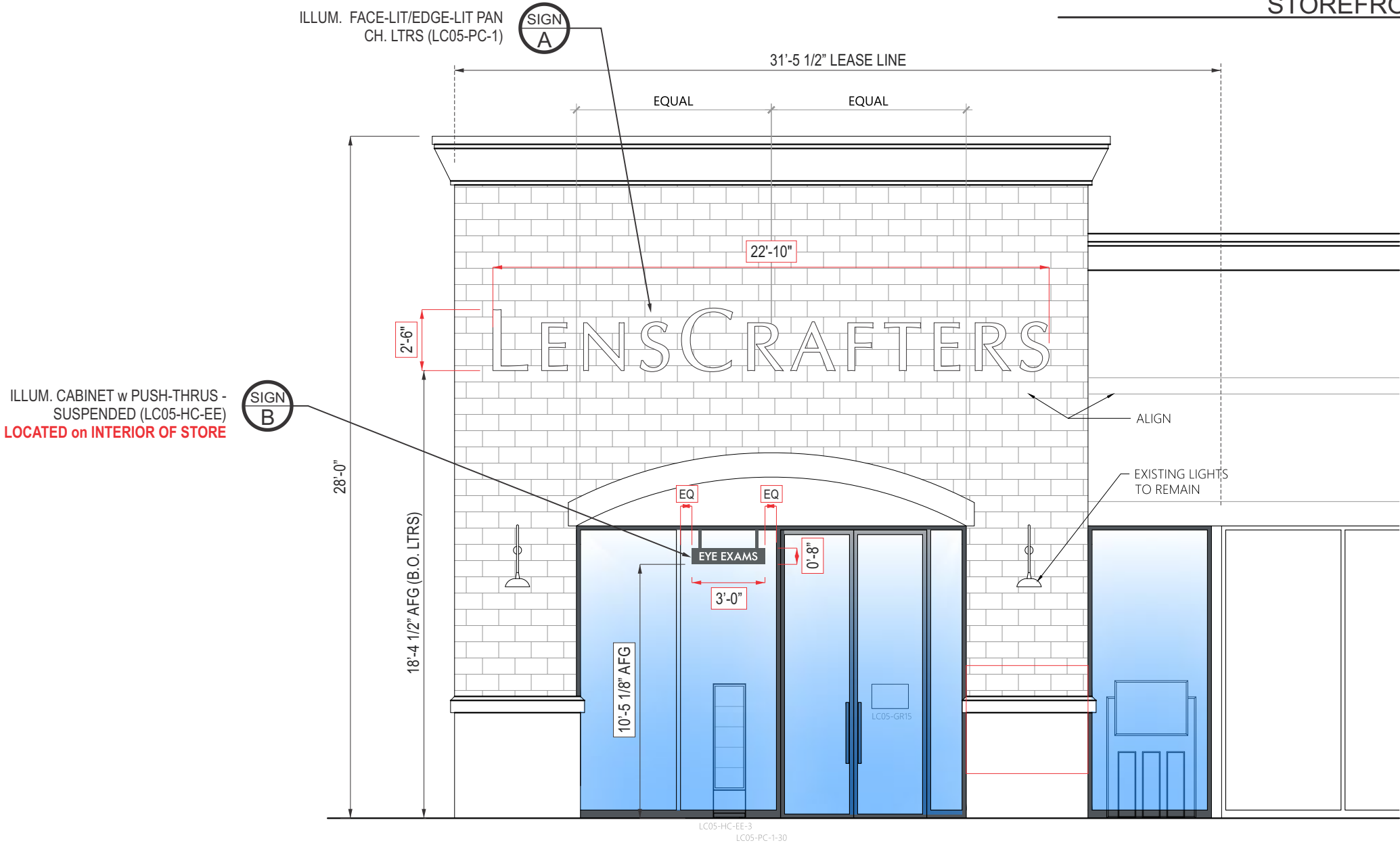

QTY.: ONE (1)



ISOMETRIC (30°) VIEW

SIGN CODE	Letter Height L	Width X
LC05-PC-1-12	12"	9' - 2"
LC05-PC-1-14	14"	10' - 8"
LC05-PC-1-16	16"	12' - 2"
LC05-PC-1-18	18"	13' - 8"
LC05-PC-1-24	24"	18' - 3"
LC05-PC-1-30	30"	22' - 10"
LC05-PC-1-36	36"	27' - 5"

NOTE : The purpose of the size chart shown above is to provide guideline information in selecting the size that meets the needs of each individual condition. The chart is not a restriction for the only sizes available, but a quick reference to evaluate which sign size best satisfies constraints from the survey data.



TYP. FRONT

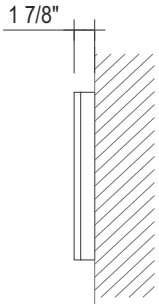

TYP. SIDE

**NOTE:**Fabricator is responsible for field verification, confirmation, and engineering of all materials, attachment methods, conditions, and necessary blocking for proper installation. There should be no "oil canning" or warping visible on aluminum material. Fabricator is responsible for the proper installation of the specified LEDs. LEDs must be installed in a manner to allow for bright, even illumination. Hot spots, shadows, dim areas or uneven illumination will be summarily rejected.

## A-1

A-1

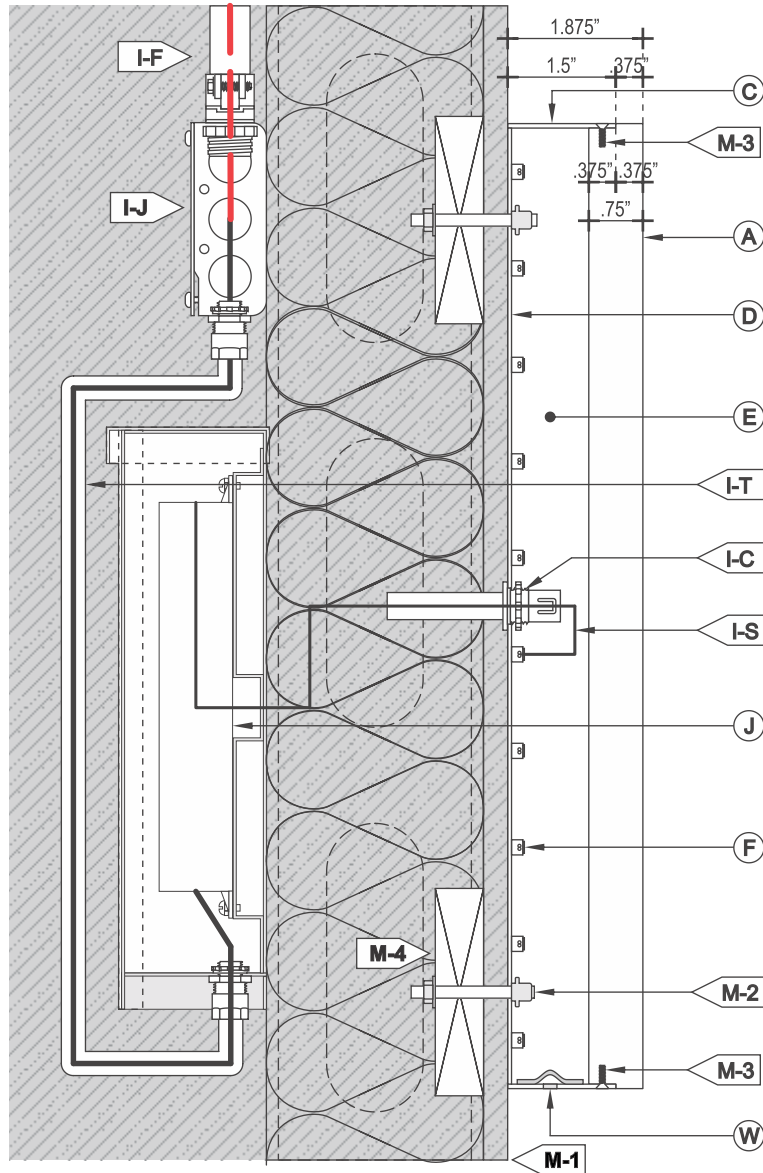
[illegible]

<b>I WIRING</b>	
I-C	7/8" DIA. HOLE @ LEXAN W/ PAIGE WALL BUSTER
	CONNECTOR & CONDUIT.
I-F	TO ELECTRICAL FEED
I-S	U.L. APPROVED LOW VOLTAGE CLASS II WIRING
I-J	ELECTRICAL JUNCTION BOX
	ALL CONNECTIONS TO BE IN ELECTRICAL BOXES
<b>J POWER SUPPLY</b>	
TYPE:	POWER SUPPLY ON TO MAINTAIN LED
	WARRANTY
	HOUSE IN WEATHER-PROOF, TOP ACCESS METAL BOX.
VOLTAGE;	120V
<b>M MOUNTING</b>	
	SEE MOUNTING NOTE.
M-1	EXISTING FASCIA, <b>VIF</b>
M-2:	10/24 ALLTHREAD STUDS w/ BOLTS / NUTS
M-3:	FLAT-HEAD MECHANICAL FASTENERS
COLOR/FINISH:	TO MATCH RETURNS
M-4:	BLOCKING AS REQ'D
<b>W WEEP HOLES</b>	
TYPE:	1/4" w/ COVER

**120V**  
**INSTALL**

1. CUSTOMER G.C. TO PROVIDE ADEQUATE WOOD OR MTL. BLOCKING IN CORRELATION W/ FAÇADE FRAMING AS REQUIRED.
  2. INSTALLER IS TO V.I.F. & PROVIDE THE PROPER NON-CORROSIVE MOUNTING HARDWARE TO ENSURE SAFE INSTALLATION.
  3. ALL EXTERIOR FAÇADE PENETRATIONS TO BE WATER TIGHT.
  4. INSTALLATION TO MEET CURRENT N.E.C., U.L. & LOCAL CODES.
- LOCATION OF THE DISCONNECT SWITCH AFTER INSTALLATION SHALL COMPLY WITH ARTICLE 600.6(A) (1) OF THE NATION ELECTRICAL CODE.

ELECTRICAL

1. ALL ELECTRICAL COMPONENTS TO BE U.L. APPROVED.
2. CUSTOMER IS RESPONSIBLE FOR ONE (1) 120v/ 20a DEDICATED CIRCUIT W/ GROUND PER SIGN TO WITHIN 6' OF SIGN.
3. THIS SIGN IS INTENDED TO BE INSTALLED IN ACCORDING W/ THE REQUIREMENTS OF ARTICLE 600 OF THE NATIONAL ELECTRICAL CODE AND/OR OTHER APPLICABLE LOCAL CODES. THIS INCLUDES PROPER GROUNDING & BONDING OF THE SIGN.

FABRICATOR

1. PLACEMENT OF LIGHTING ELEMENTS FOR OPTIMUM ILLUMINATION OF SIGN TO BE DETERMINED IN PRODUCTION.
2. MANUFACTURER & U.L. LABELS TO BE APPLIED & VISIBLE FROM THE GROUND. LOCATED ON THE LAST CHANNEL LETTER OR END OF THE SIGN BOX/FREESTANDING SIGN



ALL ELECTRICAL  
COMPONENTS ARE  
TO BE UL APPROVED

Preferred for interior use only.

ILLUM. CABINET w PUSH-THRUS - SUSPENDED (LC05-HC-EE)



SCALE: 1"=1'-0"

QTY.: ONE (1)



SIGN CODE	Letter Height L	Cabinet Width X	Cabinet Height Y	Top Margin A	Bottom Margin B	Left Margin C	Right Margin D
LC05-HC-EE-3	4"	3' - 0"	8"	2 1/8"	2 1/8"	4 5/8"	4 5/8"
LC05-HC-EE-4	5"	4' - 0"	11"	2 3/4"	2 3/4"	6 1/8"	6 1/8"
LC05-HC-EE-6	8"	6' - 0"	1' - 4"	4 1/4"	4 1/4"	9 1/8"	9 1/8"
LC05-HC-EE-8	10"	8' - 0"	1' - 10"	5 3/4"	5 3/4"	1'-0 1/8"	1'-0 1/8"

NOTE : The purpose of the size chart shown above is to provide guideline information in selecting the size that meets the needs of each individual condition. The chart is not a restriction for the only sizes available, but a quick reference to evaluate which sign size best satisfies constraints from the survey data.



ISOMETRIC (30°) VIEW

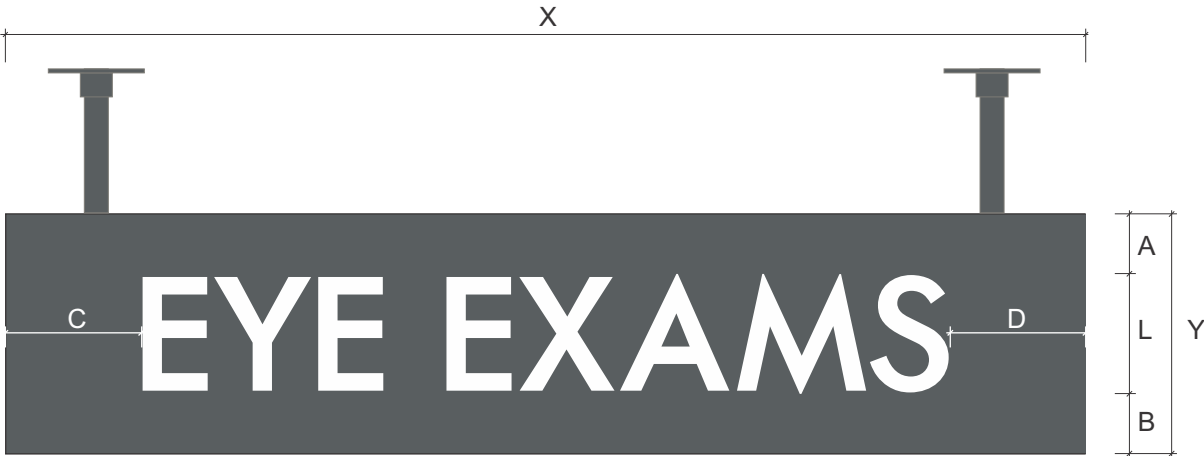

TYP. FRONT

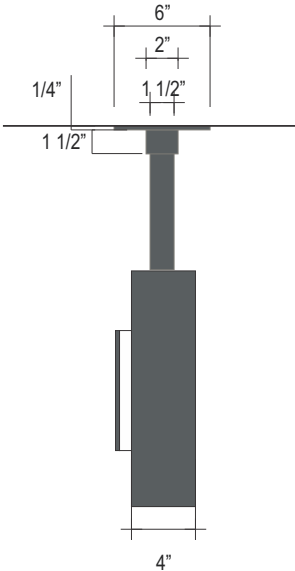

TYP. SIDE



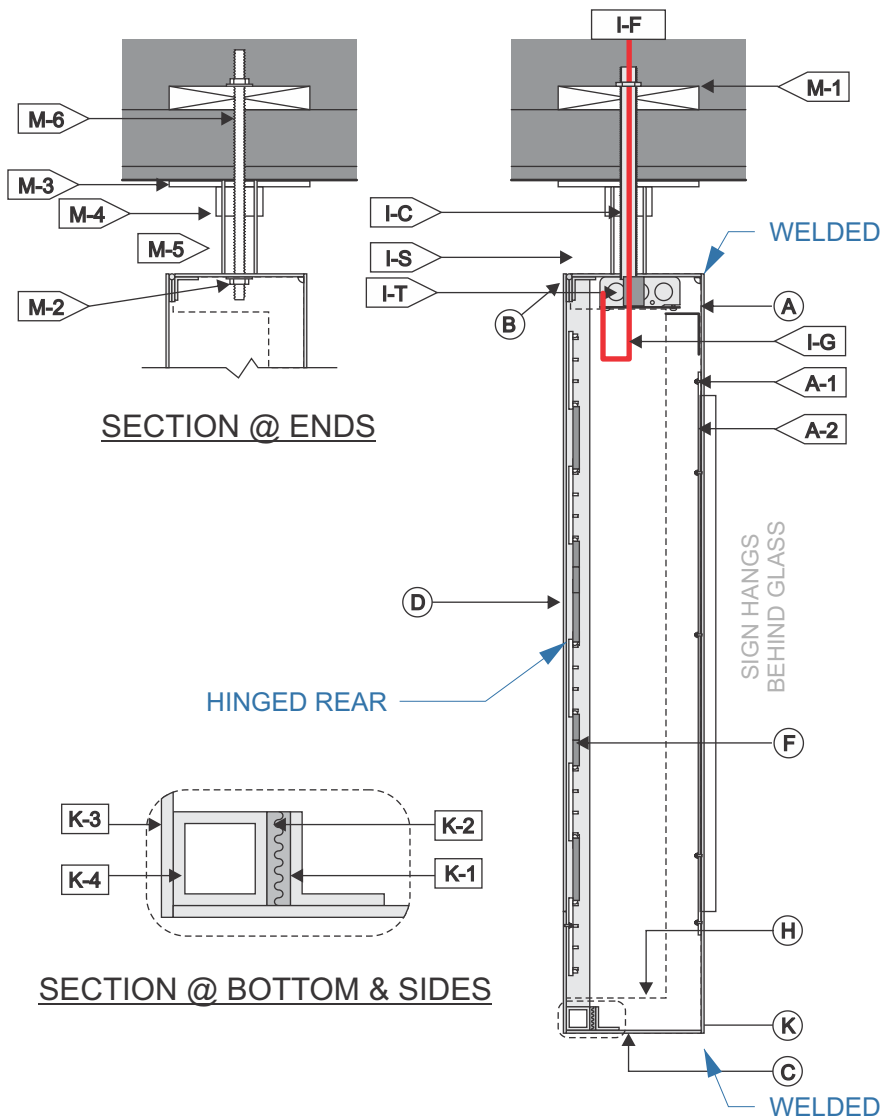

ILLUM. CABINET w PUSH-THRUS - SUSPENDED (LC05-HC-EL-EE)

B-1

SCALE: NTS

A FACE	
MATERIAL:	1/8" ALUM., ROUTED WITH LOGO. WELDED
COLOR/ FINISH:	MATTHEWS MP 10269 'DARK SLATE' / SATIN
A-1:	BACKUP MOUNTS WITH 10/24 STUDS & NUTS.
A-2 BACKUP:	3/16" WHITE ACRYLIC #2447
A-3 PUSH THRU:	1" CLEAR ACRYLIC
FINISH:	
B HINGE	
SIZE:	1" CONT., MOUNTS TO BACK OF SIGN
C RETURNS	
DEPTH:	4"
MATERIAL:	1/8" ALUM.
COLOR	MATTHEWS MP 10269 'DARK SLATE'
D BACK	
MATERIAL:	1/8" ALUM. HINGED
COLOR	MATTHEWS MP 10269 'DARK SLATE'
F ILLUMINATION	
TYPE:	LEDS
COLOR:	6500K WHITE
	ALL WIRES TO BE TERMINATED W/ A MECHANICAL UL LISTED FASTENER
H FRAME	
MATERIAL:	2" x 2" ALUM. ANGLE. (DASHED LINE)

I WIRING	
I-C	3/4" Ø THREADED CONDUIT w/ NUT & WASHERS.
I-D	DISCONNECT SWITCH (SIDE OF CABINET)
I-F:	TO 12V FEED
I-S	U.L. APPROVED LOW VOLTAGE CLASS II WIRING
I-J	ALL CONNECTIONS TO BE IN ELECTRICAL BOXES
I-T	3/4" Ø THREADED CONDUIT COUPLING, WELDED @ TOP.
J POWER SUPPLY	
TYPE:	U.L. APPROVED LED LOW VOLTAGE POWER SUPPLY.
VOLTAGE:	120V.
K HOLD CLOSE	
K-1:	1" x 1" ANGLE @ SIDES & BOTTOM
K-2:	VELCRO @ SIDES & BOTTOM
K-3:	ALUM. FACE.
K-4:	1" x 1" ALUM. TUBE @ SIDES & BOTTOM
M MOUNTING	
M-1:	REQ'D BLOCKING BY OTHERS.
M-2:	WELDED NUT INSIDE TOP OF CABINET.
M-3:	1/4" THK. x 6" x 6" ALUM. MOUNTING PLATE
COLOR:/FINISH:	MATTHEWS MP 10269 'DARK SLATE'
M-4:	6" x 2" DIA. ALUM. FLANGE, WELDED TO MTG PLATE
COLOR:/FINISH:	MATTHEWS MP 10269 'DARK SLATE'
M-5:	PVC PIPE COVER SLEEVE.
COLOR:/FINISH:	MATTHEWS MP 10269 'DARK SLATE'
M-6:	ALL-THREAD, NUT & WASHERS.

120V INSTALL	1. CUSTOMER G.C. TO PROVIDE ADEQUATE WOOD OR MTL. BLOCKING IN CORRELATION W/ FACADE FRAMING AS REQUIRED. 2. INSTALLER IS TO V.I.F. & PROVIDE THE PROPER NON-CORROSIVE MOUNTING HARDWARE TO ENSURE SAFE INSTALLATION. 3. ALL EXTERIOR FACADE PENETRATIONS TO BE WATERTIGHT. 4. INSTALLATION TO MEET CURRENT N.E.C., U.L. & LOCAL CODES. LOCATION OF THE DISCONNECT SWITCH AFTER INSTALLATION SHALL COMPLY WITH ARTICLE 600.6(A) (1) OF THE NATION ELECTRICAL CODE			ELECTRICAL	1. ALL ELECTRICAL COMPONENTS TO BE U.L. APPROVED. 2. CUSTOMER IS RESPONSIBLE FOR ONE (1) 120v/ 20a DEDICATED CIRCUIT w/ GROUND PER SIGN TO WITHIN 6' OF SIGN. 3. THIS SIGN IS INTENDED TO BE INSTALLED IN ACCORDING W/ THE REQUIREMENTS OF ARTICLE 600 OF THE NATIONAL ELECTRICAL CODE AND/OR OTHER APPLICABLE LOCAL CODES. THIS INCLUDES PROPER GROUNDING & BONDING OF THE SIGN.			FABRICATOR	1. PLACEMENT OF LIGHTING ELEMENTS FOR OPTIMUM ILLUMINATION OF SIGN TO BE DETERMINED IN PRODUCTION. 2. MANUFACTURER & U.L. LABELS TO BE APPLIED & VISIBLE FROM THE GROUND. LOCATED ON THE LAST CHANNEL LETTER OR END OF THE SIGN BOX/FREESTANDING SIGN			 ALL ELECTRICAL COMPONENTS ARE TO BE UL APPROVED

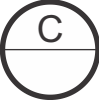

SCALE: 3"=1'-0"

QTY.: ONE (1)

3'-1 7/8"



TYP. FRONT

D.1

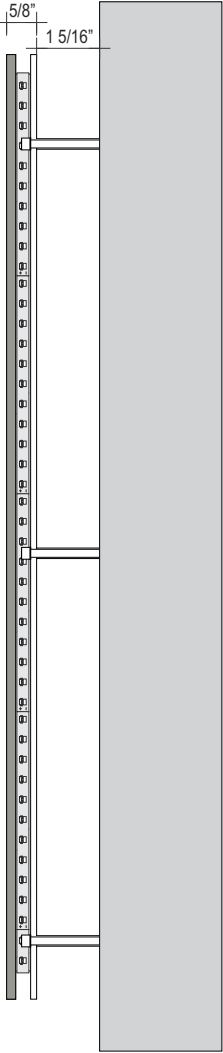
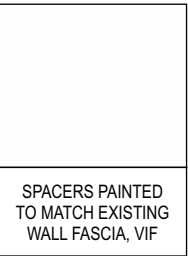

TYP. SIDE

D.2



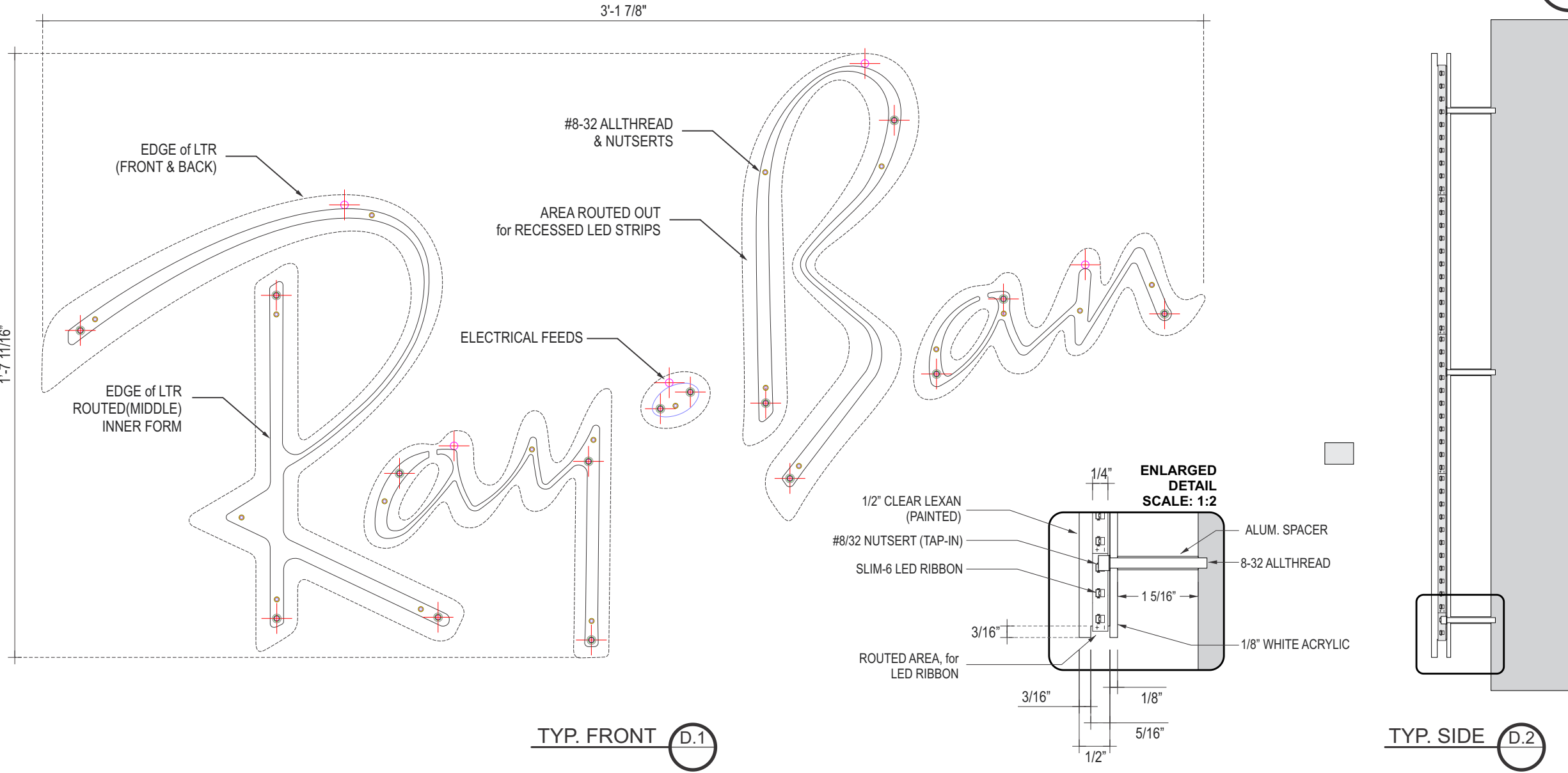





Reference Elevation  
Scale: 3/4" = 1'-0"

NOTE: Fabricator is responsible for field verification, confirmation, and engineering of all materials, attachment methods, conditions, and necessary blocking for proper installation. There should be no "oil canning" or warping visible on aluminum material. Fabricator is responsible for the proper installation of the specified LEDs. LEDs must be installed in a manner to allow for bright, even illumination. Hot spots, shadows, dim areas or uneven illumination will be summarily rejected.

	<p>11 Azar Court • P.O. Box 24186 Baltimore, Maryland 21227 T: 410-247-5300 • F: 410 247-1944</p> <p>Reproduction In Whole or Part Prohibited without Express Permission of Triangle S &amp; S © TSS</p>	<p>CLIENT &amp; LOCATION</p> <p>LENSCRAFTERS</p> <p>SUMMIT WOOD CROSSING 1700 NW CHIPMAN LES SUMMIT, MO 64081 STORE # 1643 SPACE # M-6B</p>	LEAD NO.	DATE	REVIEWED BY	SHEET NO.
			202445 R2	11.12.2021		
			SM - PM	DRAWN BY	SEG. NO.	
			S.M. - V.W.	KH		
						11 of 18

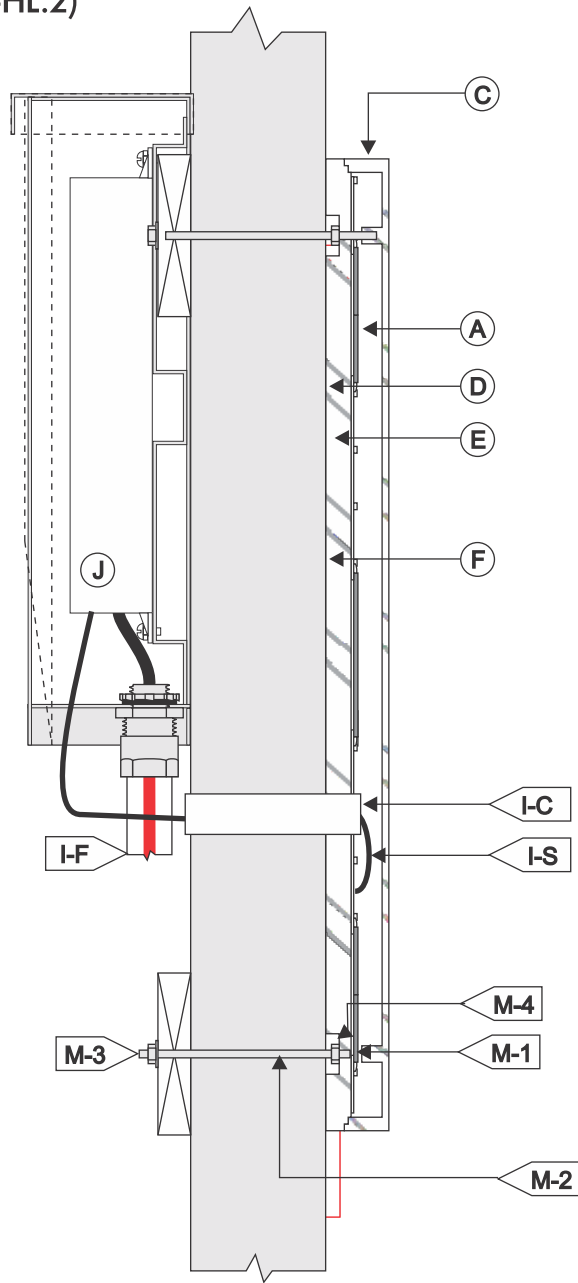

A FACE	
MATERIAL:	CLEAR ACRYLIC
COLOR/FINISH:	MATCH RAL #7012 'BASALT GREY' / SATIN
C RETURNS	
DEPTH:	1 3/8"± O.A ASSEMBLED
MATERIAL:	1" CLEAR ACRYLIC
COLOR/FINISH:	MATCH RAL BENJAMIN MOORE 1603 GRAPHITE/SATIN
D BACKS:	
MATERIAL:	1/2" CLEAR ACRYLIC
FINISH:	SANDED
E INSIDE OF CAN	
COLOR:	WHITE
F ILLUMINATION:	
TYPE:	6500K WHITE, @ BACK SHINING INTO LETTER

I WIRING	
I-C	1/2" O.D. TRUE KONEK PVC TUBE
I-F	TO ELECTRICAL FEED
I-S	U.L. APPROVED LOW VOLTAGE CLASS II WIRING
	ALL CONNECTIONS TO BE IN ELECTRICAL BOXES
J POWER SUPPLY	
TYPE:	REMOTE LED POWER SUPPLY HOUSE IN FRONT
	ACCESS WEATHER-PROOF LED POWER SUPPLY BOX.
VOLTAGE;	120V
M MOUNTING	
SEE MOUNTING NOTE.	
M-1	ROUTED ANCHORS WITH TAPPED CENTERS
M-2	10/24 ALLTHREAD STUDS
M-3	NUTS & WASHERS SECURED THRU TO BLOCKING
M-4	ROUTED RECESSED FOR NUTS

LENSCRAFTERS

ISOMETRIC (30°) VIEW

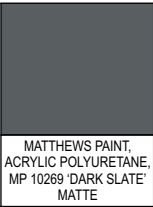
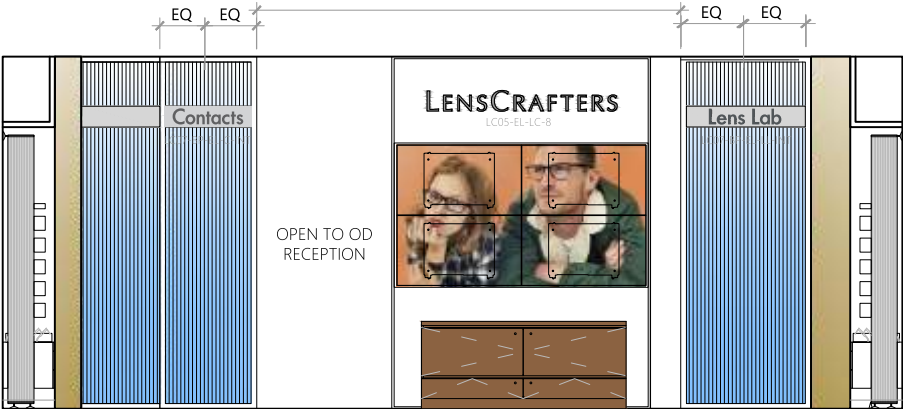
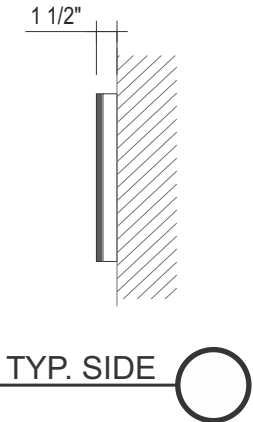

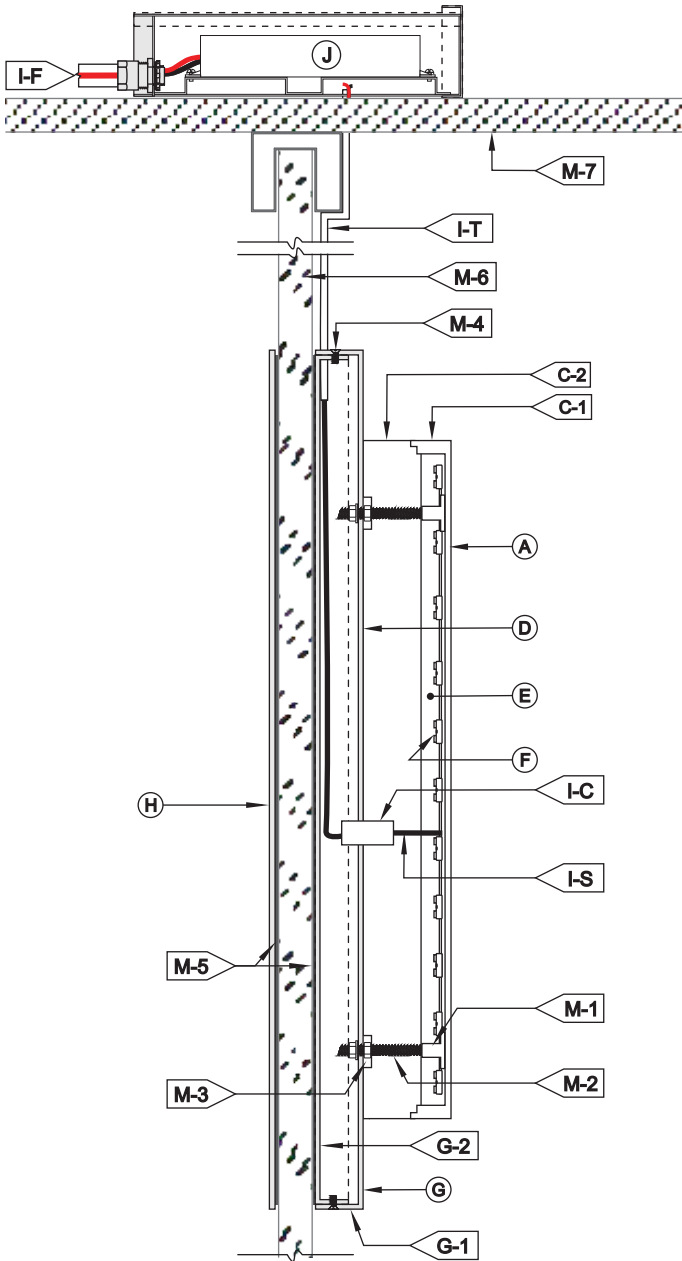

A FACE	
MATERIAL:	WHITE ACRYLIC #2447.
COLOR:	MATTHEWS PAINT ACRYLIC POLYURETHANE
	MP 10269 'DARK SLATE'
FINISH:	MATTE
C RETURNS	
OVERALL DEPTH:	1 1/2"
C-1 FRONT:	1/2" WHITE ACRYLIC #2447 ROUTED TO 7/16" D.
COLOR:	MATTHEWS PAINT ACRYLIC POLYURETHANE
	MP 10269 'DARK SLATE'
FINISH:	MATTE
C-2 BACK:	1" WHITE 2447 ACRYLIC
D BACK	
VINYL	BLOCK OUT (WHITE STICKY SIDE TOWARDS LETTER)
E INSIDE OF CAN	
COLOR:	WHITE
F ILLUMINATION	
TYPE/COLOR:	6500K WHITE LED'S @ BACK OF FACE;
	SHINES OUT OF LTR
G BACKER PANEL	
MATERIAL:	0.080" ALUM. PAN-FORMED PANEL.
COLOR/FINISH:	STAINLESS STEEL / SATIN FINISH
G-1 RETURNS	1" DEEP PAN-FORMED PANEL, FINISH TO MATCH FACE.
G-2 BACK:	3/4" DEEP PAN-FORMED MOUNTING PANEL WITH
	ADHESIVE TAPE ON BACK FOR GLASS MOUNTING.

H PLATE:	
MATERIAL:	STAINLESS STEEL, ADHERED 2ND SURFACE TO GLASS
	DIRECTLY BEHIND PANEL TO COVER VHB TAPES.
COLOR/FINISH:	STAINLESS STEEL / SATIN FINISH
I WIRING	
I-C:	1/2" O.D. TRUE KONEK PVC TUBE
I-F:	TO ELECTRICAL FEED
I-S:	U.L. APPROVED LOW VOLTAGE CLASS II WIRING
	ALL CONNECTIONS TO BE IN ELECTRICAL BOXES
I-T:	CLEAR LOW VOLTAGE WIRE.
J POWER SUPPLY	
TYPE:	REMOTE LED POWER SUPPLY HOUSE IN FRONT
	ACCESS WEATHER-PROOF LED POWER SUPPLY BOX.
VOLTAGE:	120V
M MOUNTING	
SEE MOUNTING NOTE.	
M-1:	ROUTED ANCHORS WITH TAPPED CENTERS.
M-2:	10/24 THREADED STUDS NUTS & WASHERS SECURED
	THRU BACK PANEL FACE.
M-3:	ROUTED RECESSED FOR NUTS.
M-4:	FLATHEAD COUNTER SUNK SCREWS.
COLOR/FINISH:	FINISH TO MATCH RETURNS.
M-5:	VHB ADHESIVE TAPES.
M-6:	EXISTING GLASS DIVIDER.
M-7:	EXISTING CIELING.

NOTE: Fabricator is responsible for field verification, confirmation, and engineering of all materials, attachment methods, conditions, and necessary blocking for proper installation. There should be no "oil canning" or warping visible on aluminum material. Fabricator is responsible for the proper installation of the specified LEDs. LEDs must be installed in a manner to allow for bright, even illumination. Hot spots, shadows, dim areas or uneven illumination will be summarily rejected.



QTY.: ONE (1)

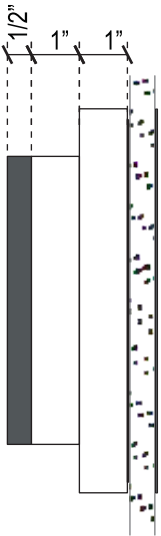
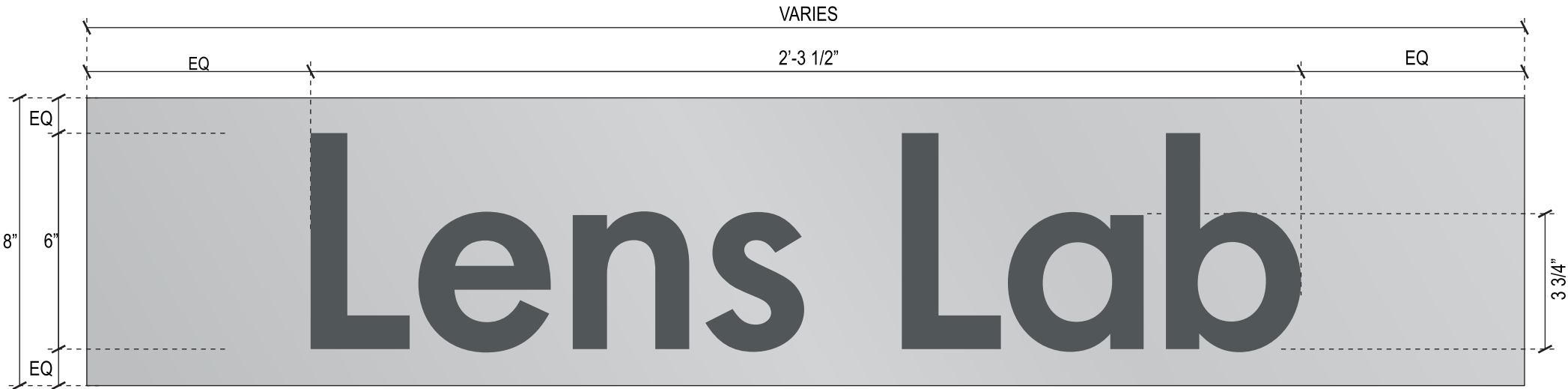

Reference Elevation - LC07-BP-EL-LL-INT  
Scale: 3" = 1'-0"

Side View  
Scale: 1 1/2" = 1'-0"

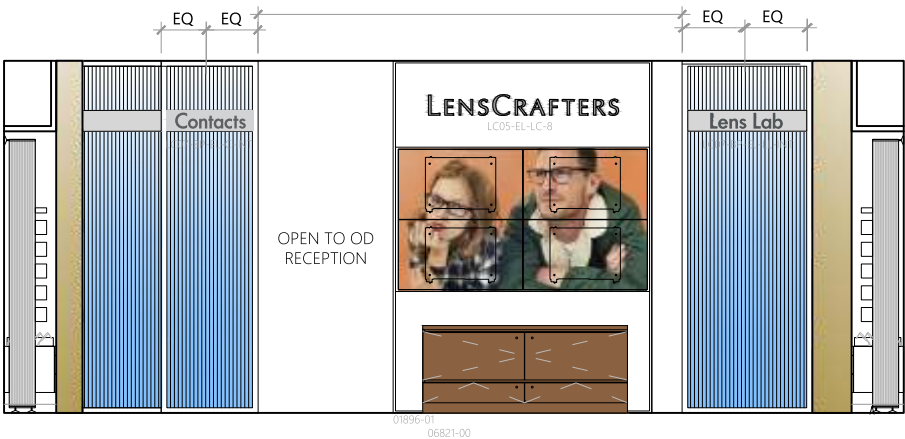

NOTE: Fabricator is responsible for field verification, confirmation, and engineering of all materials, attachment methods, conditions, and necessary blocking for proper installation. There should be no "oil canning" or warping visible on aluminum material. Fabricator is responsible for the proper installation of the specified LEDs. LEDs must be installed in a manner to allow for bright, even illumination. Hot spots, shadows, dim areas or uneven illumination will be summarily rejected.

LEAD NO.	DATE	REVIEWED BY	SHEET NO.
202445 R2	11.12.2021		
SM - PM	DRAWN BY	SEG. NO.	15 of 18
S.M. - V.W.	KH		

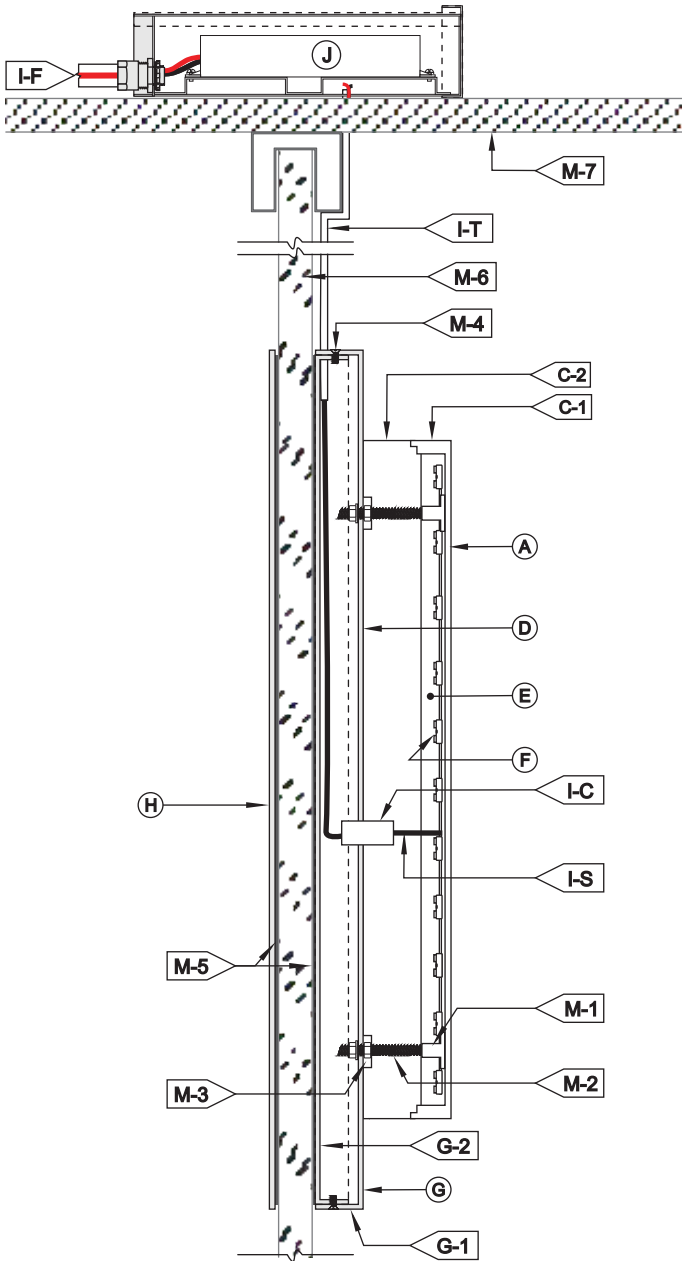

A FACE	
MATERIAL:	WHITE ACRYLIC #2447.
COLOR:	MATTHEWS PAINT ACRYLIC POLYURETHANE
	MP 10269 'DARK SLATE'
FINISH:	MATTE
C RETURNS	
OVERALL DEPTH:	1 1/2"
C-1 FRONT:	1/2" WHITE ACRYLIC #2447 ROUTED TO 7/16" D.
COLOR:	MATTHEWS PAINT ACRYLIC POLYURETHANE
	MP 10269 'DARK SLATE'
FINISH:	MATTE
C-2 BACK:	1" WHITE 2447 ACRYLIC
D BACK	
VINYL	BLOCK OUT (WHITE STICKY SIDE TOWARDS LETTER)
E INSIDE OF CAN	
COLOR:	WHITE
F ILLUMINATION	
TYPE/COLOR:	6500K WHITE LED'S @ BACK OF FACE;
	SHINES OUT OF LTR
G BACKER PANEL	
MATERIAL:	0.080" ALUM. PAN-FORMED PANEL.
COLOR/FINISH:	STAINLESS STEEL / SATIN FINISH
G-1 RETURNS	1" DEEP PAN-FORMED PANEL, FINISH TO MATCH FACE.
G-2 BACK:	3/4" DEEP PAN-FORMED MOUNTING PANEL WITH
	ADHESIVE TAPE ON BACK FOR GLASS MOUNTING.

H PLATE:	
MATERIAL:	STAINLESS STEEL, ADHERED 2ND SURFACE TO GLASS
	DIRECTLY BEHIND PANEL TO COVER VHB TAPES.
COLOR/FINISH:	STAINLESS STEEL / SATIN FINISH
I WIRING	
I-C:	1/2" O.D. TRUE KONEK PVC TUBE
I-F:	TO ELECTRICAL FEED
I-S:	U.L. APPROVED LOW VOLTAGE CLASS II WIRING
	ALL CONNECTIONS TO BE IN ELECTRICAL BOXES
I-T:	CLEAR LOW VOLTAGE WIRE.
J POWER SUPPLY	
TYPE:	REMOTE LED POWER SUPPLY HOUSE IN FRONT
	ACCESS WEATHER-PROOF LED POWER SUPPLY BOX.
VOLTAGE:	120V
M MOUNTING	
SEE MOUNTING NOTE.	
M-1:	ROUTED ANCHORS WITH TAPPED CENTERS.
M-2:	10/24 THREADED STUDS NUTS & WASHERS SECURED
	THRU BACK PANEL FACE.
M-3:	ROUTED RECESSED FOR NUTS.
M-4:	FLATHEAD COUNTER SUNK SCREWS.
COLOR/FINISH:	FINISH TO MATCH RETURNS.
M-5:	VHB ADHESIVE TAPES.
M-6:	EXISTING GLASS DIVIDER.
M-7:	EXISTING CIELING.

NOTE: Fabricator is responsible for field verification, confirmation, and engineering of all materials, attachment methods, conditions, and necessary blocking for proper installation. There should be no "oil canning" or warping visible on aluminum material. Fabricator is responsible for the proper installation of the specified LEDs. LEDs must be installed in a manner to allow for bright, even illumination. Hot spots, shadows, dim areas or uneven illumination will be summarily rejected.

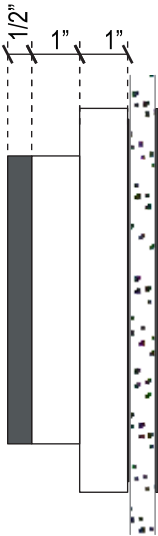
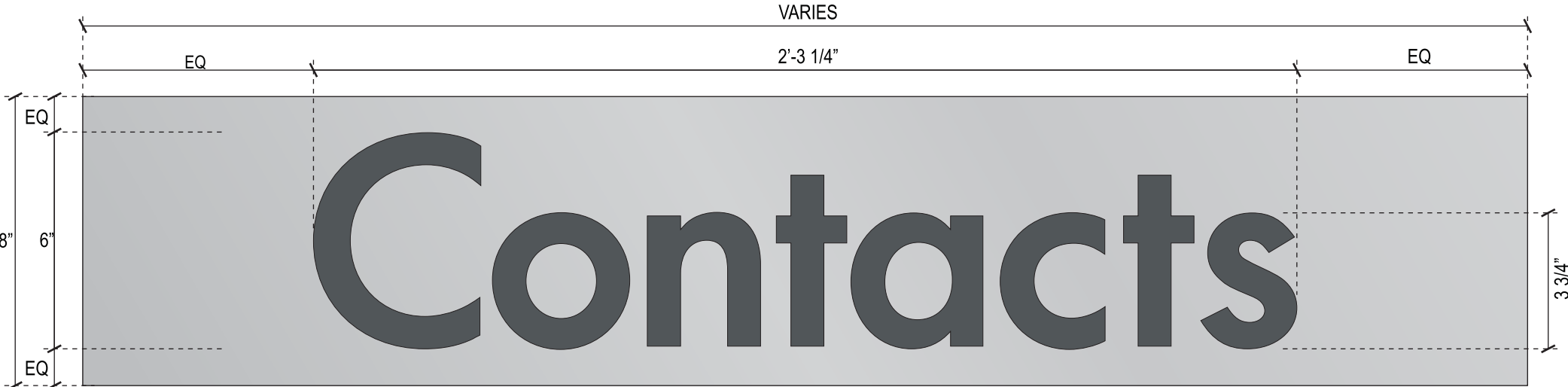

Reference Elevation - LC07-BP-EL-C-INT  
Scale: 3" = 1'-0"

Side View  
SCALE: N.T.S.

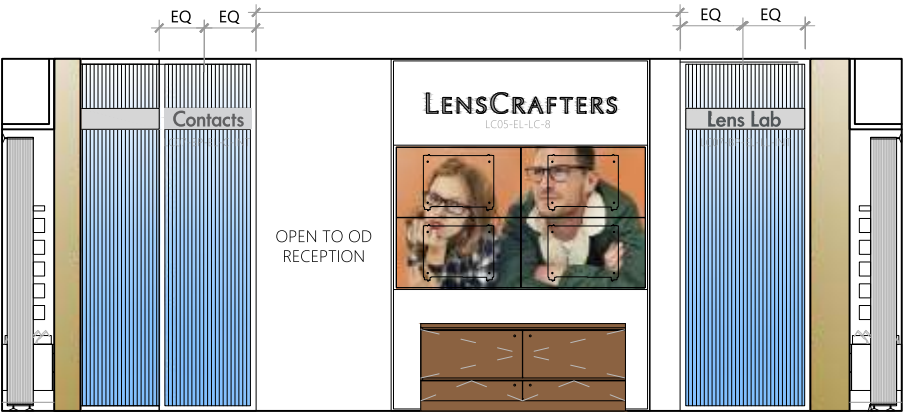

NOTE: Fabricator is responsible for field verification, confirmation, and engineering of all materials, attachment methods, conditions, and necessary blocking for proper installation. There should be no "oil canning" or warping visible on aluminum material. Fabricator is responsible for the proper installation of the specified LEDs. LEDs must be installed in a manner to allow for bright, even illumination. Hot spots, shadows, dim areas or uneven illumination will be summarily rejected.

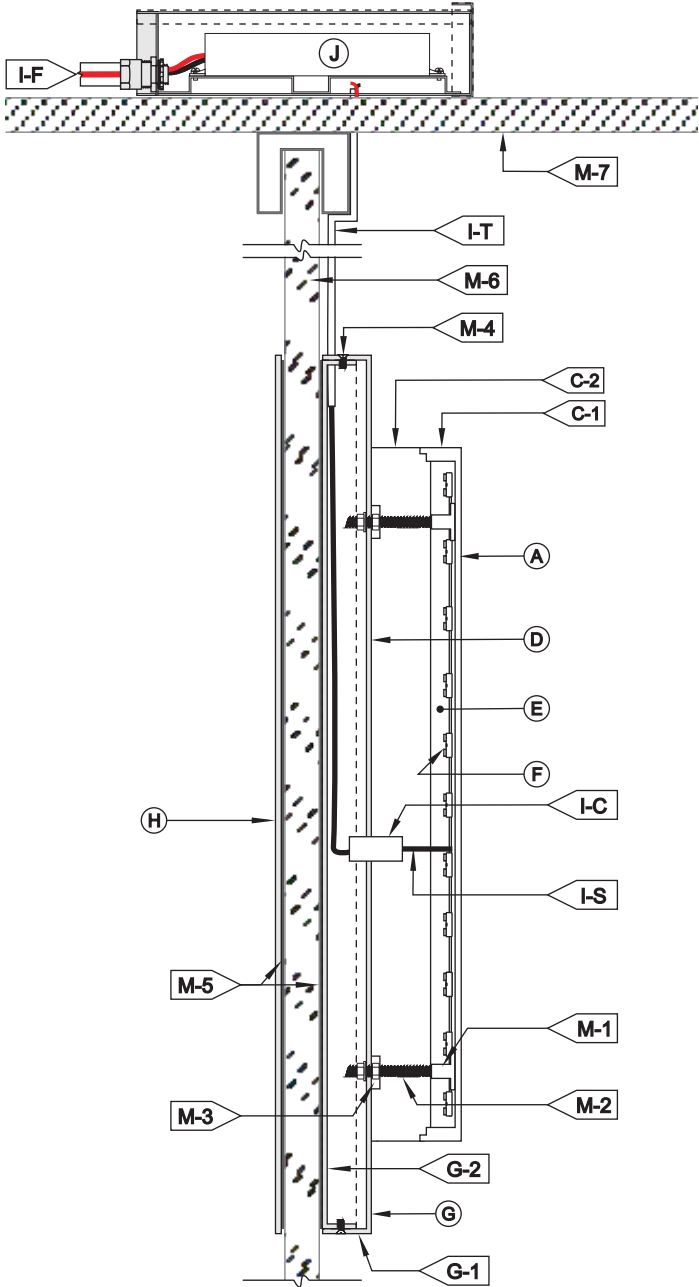

A FACE	
MATERIAL:	WHITE ACRYLIC #2447.
COLOR:	MATTHEWS PAINT ACRYLIC POLYURETHANE
	MP 10269 'DARK SLATE'
FINISH:	MATTE
C RETURNS	
OVERALL DEPTH:	1 1/2"
C-1 FRONT:	1/2" WHITE ACRYLIC #2447 ROUTED TO 7/16" D.
COLOR:	MATTHEWS PAINT ACRYLIC POLYURETHANE
	MP 10269 'DARK SLATE'
FINISH:	MATTE
C-2 BACK:	1" WHITE 2447 ACRYLIC
D BACK	
VINYL	BLOCK OUT (WHITE STICKY SIDE TOWARDS LETTER)
E INSIDE OF CAN	
COLOR:	WHITE
F ILLUMINATION	
TYPE/COLOR:	6500K WHITE LED'S @ BACK OF FACE;
	SHINES OUT OF LTR
G BACKER PANEL	
MATERIAL:	0.080" ALUM. PAN-FORMED PANEL.
COLOR/FINISH:	STAINLESS STEEL / SATIN FINISH
G-1 RETURNS	1" DEEP PAN-FORMED PANEL, FINISH TO MATCH FACE.
G-2 BACK:	3/4" DEEP PAN-FORMED MOUNTING PANEL WITH
	ADHESIVE TAPE ON BACK FOR GLASS MOUNTING.

H PLATE:	
MATERIAL:	STAINLESS STEEL, ADHERED 2ND SURFACE TO GLASS
	DIRECTLY BEHIND PANEL TO COVER VHB TAPES.
COLOR/FINISH:	STAINLESS STEEL / SATIN FINISH
I WIRING	
I-C:	1/2" O.D. TRUE KONEK PVC TUBE
I-F	TO ELECTRICAL FEED
I-S:	U.L. APPROVED LOW VOLTAGE CLASS II WIRING
	ALL CONNECTIONS TO BE IN ELECTRICAL BOXES
I-T:	CLEAR LOW VOLTAGE WIRE.
J POWER SUPPLY	
TYPE:	REMOTE LED POWER SUPPLY HOUSE IN FRONT
	ACCESS WEATHER-PROOF LED POWER SUPPLY BOX.
VOLTAGE;	120V
M MOUNTING	
SEE MOUNTING NOTE.	
M-1:	ROUTED ANCHORS WITH TAPPED CENTERS.
M-2:	10/24 THREADED STUDS NUTS & WASHERS SECURED
	THRU BACK PANEL FACE.
M-3:	ROUTED RECESSED FOR NUTS.
M-4:	FLATHEAD COUNTER SUNK SCREWS.
COLOR/FINISH:	FINISH TO MATCH RETURNS.
M-5:	VHB ADHESIVE TAPES.
M-6:	EXISTING GLASS DIVIDER.
M-7:	EXISTING CIELING.

NOTE: Fabricator is responsible for field verification, confirmation, and engineering of all materials, attachment methods, conditions, and necessary blocking for proper installation. There should be no "oil canning" or warping visible on aluminum material. Fabricator is responsible for the proper installation of the specified LEDs. LEDs must be installed in a manner to allow for bright, even illumination. Hot spots, shadows, dim areas or uneven illumination will be summarily rejected.