

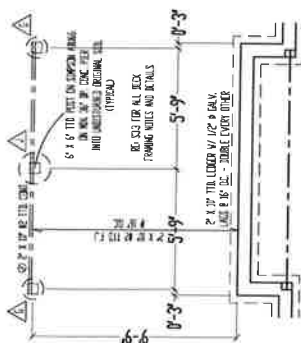

VIEWPOINT
RESIDENTIAL DESIGN LLC

1550 SW Market St., Ste. 220-A ▲ Lee's Summit, MO 64081-3113 ▲ Office: (816) 554-0400 Ext. 101
www.viewpointdesign.net ▲ Email: Plans@ViewpointDesign.net

THEY ARE THE ONLY PEOPLE WHO CAN
DO IT. THEY ARE THE ONLY PEOPLE WHO
CAN DO IT. THEY ARE THE ONLY PEOPLE
WHO CAN DO IT. THEY ARE THE ONLY
PEOPLE WHO CAN DO IT. THEY ARE
THE ONLY PEOPLE WHO CAN DO IT.



OPTION DECK

SCALE: $1/4^N = 1 - \rho^N$

8'-0" FOUNDATION WALLS
(UNLESS NOTED OTHERWISE)
ON 16" X 8" STRIP FOOTINGS
(STEP WHERE GRADE REQUIRES)

X 10³ FLOOR SYSTEM
FOUNDATION

SCALE: $1/4'' = 1' - 0''$

OPTIONAL LOWER LEVEL: 740 SQ. FT.

[illegible][illegible]

PIER FOOTING SCHEDULE	
G	12" x PER FTG.
H	16" x PER FTG.
J	18" x PER FTG.
K	24" x PER FTG.

JOIST SCHEDULE	
	2" X 10" #3 FLOOR JOIST @ 16" OC.
	2" X 10" #2 FLOOR JOIST @ 16" OC.

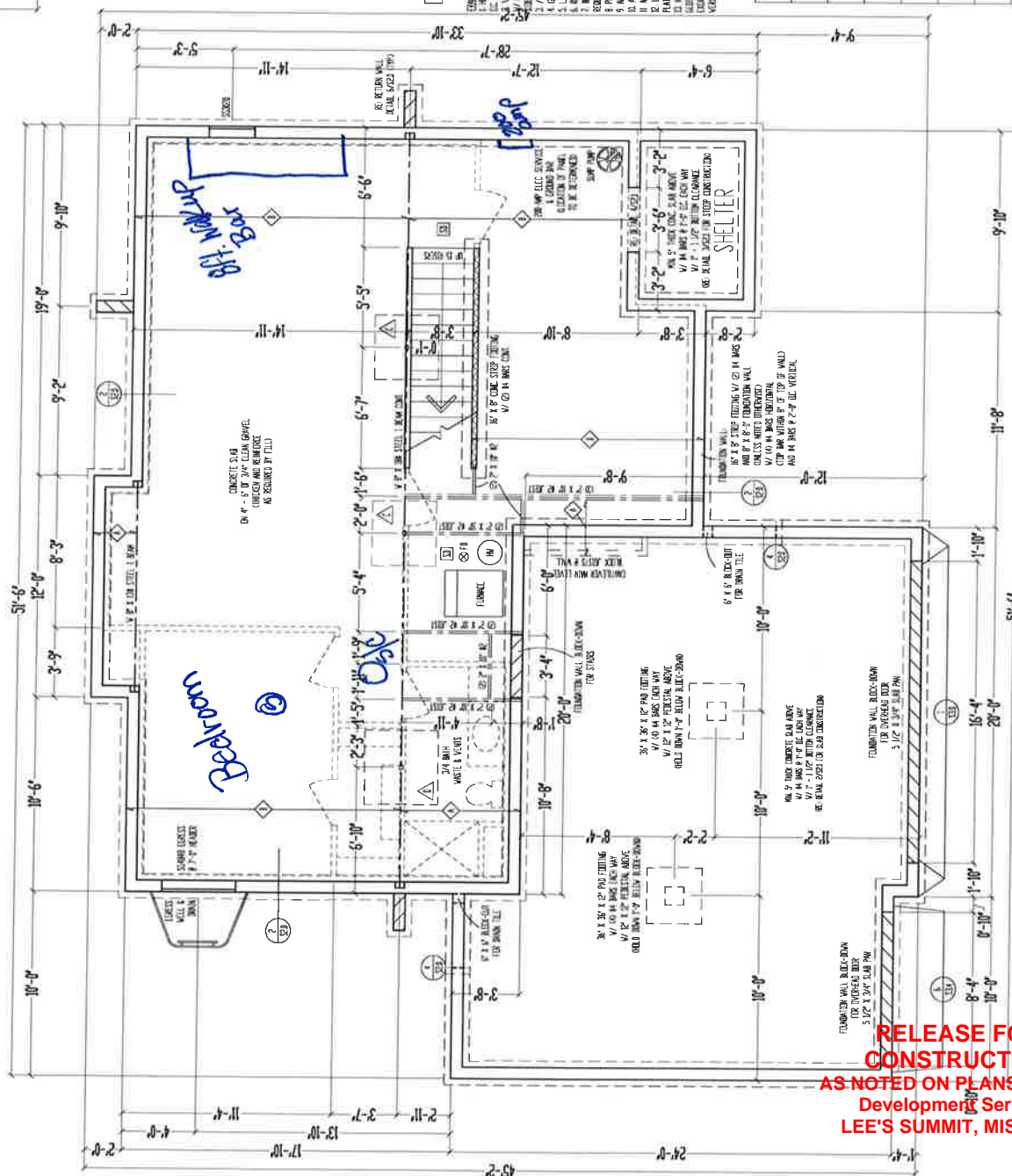

**RELEASE FOR
CONSTRUCTION
AS NOTED ON PLANS REVIEW
Development Services
LEE'S SUMMIT, MISSOURI**