

LEGEND

- Gas Meter
- Telephone or Fiber-Optic Pedestal
- Cable TV Pedestal
- Electric Pedestal
- Light Pole
- Mailbox
- Fire Hydrant
- Water Valve

PROPOSED HOUSE

TOP FOUNDATION = 976.25
 GARAGE FLOOR = 971.25
 TOP FOOTING = 967.25
 BASEMENT FLOOR = 967.58
 DRIVE SLOPE = 7.2%

E = EXISTING ELEVATION
 F = PROPOSED FINAL ELEVATION
 G = ADJACENT GRADE AT EGRESS
 U/E = UTILITY EASEMENT
 B/L = BUILDING LINE
 S/Y/S = SIDE YARD SETBACK
 R/Y/S = REAR YARD SETBACK

NOTES

1. BUILDER TO VERIFY ALL BUILDING ELEVATIONS AND DIMENSIONS.
2. THIS PLOT PLAN DOES NOT CONSTITUTE A BOUNDARY SURVEY.
3. THE EASEMENTS SHOWN ON THIS PLOT PLAN ARE TAKEN FROM THE FINAL PLAT. OTHER EASEMENTS MAY EXIST.

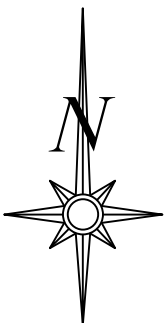

Scale 1"=30'

LOT INFORMATION

12,308 SQ. FT.
 MSFE=960.06
 ADDRESS
 2038 SW FARM FIELD LANE
LEGAL DESCRIPTION
 LOT 1 HOOK FARMS FIRST PLAT
 A SUBDIVISION AS RECORDED
 IN LEE'S SUMMIT JACKSON
 COUNTY MISSOURI

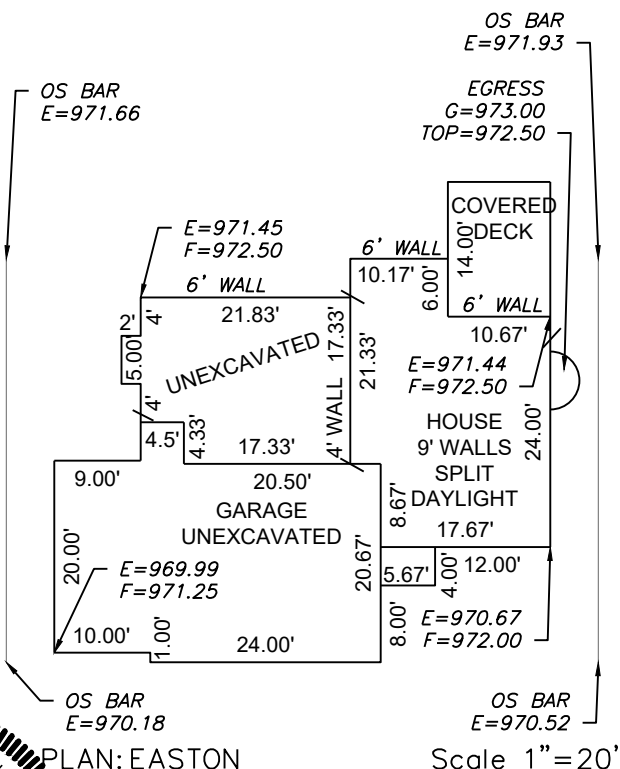

PLAN: EASTON

ENGINEERING SOLUTIONS
 ENGINEERING & SURVEYING
 50 SE 30TH STREET
 LEE'S SUMMIT, MO 64082
 P:(816) 623-9888 F:(816)623-9849
 WWW.ENGINEERINGSOLUTIONKCC.COM

STATE OF MISSOURI
 MATTHEW J. SCHLICHT
 NUMBER
 PE-2006019708
 PROFESSIONAL ENGINEER

PLOT PLAN - LOT 1

HOOK FARMS FIRST PLAT
 LEE'S SUMMIT, JACKSON COUNTY, MISSOURI

IQ HOMES BUILDER
 P.O. BOX 6423
 LEE'S SUMMIT, MISSOURI, 64064

PROJECT NO.	FILE NAME	DATE	SHEET	OF
1	LOT 1, HOOK FARMS FIRST PLAT	8/25/2021	1	1