



October 8, 2021

Summit Homes
120 SE 30th St.
Lee's Summit, MO 64082

RE: Field Issue of holdown device for PFH portal frame at 8' garage door opening for Lot #87 Woodside Ridge – 314 NW Ambersham Drive Lee's Summit, MO 64081 – Permit # PRRES20211772

This letter addresses the embedded holdown straps for PFH portal frame at 8' garage door opening for Lot#87 Woodside Ridge.

- It is structurally acceptable to omit embedded straps and install a HDU5-SDS2.5 holdown device at both ends of 8' garage door opening for PFH portal frame. Install per manufacturer's specifications.

Load Tables

These products are available with additional corrosion protection.

| | Model No. | Ga. | Dimensions (in.) | | | | | Fasteners (in.) | | Minimum Wood Member Size (in.) | Allowable Tension Loads (160) | | |
|---|--------------|-----|------------------|--------------------------------|-----------------------------|------------------------------|------------------------------|----------------------------|-----------------|--------------------------------|-------------------------------|--------|------------------------------------|
| | | | W | H | B | CL | SO | Anchor Bolt Dia. (in.) | Wood Fasteners | | DF/SP | SPF/HF | Deflection at Allowable Load (in.) |
| ■ | HDU2-SDS2.5 | 14 | 3 | 8 ¹¹ ₁₆ | 3 ³ ₄ | 1 ¹ ₁₆ | 1 ¹ ₁₆ | ⁵ ₁₆ | (6) ¼ x 2½ SDS | 3 x 3½ | 3,075 | 2,215 | 0.088 |
| ■ | HDU4-SDS2.5 | 14 | 3 | 10 ¹⁹ ₁₆ | 3 ³ ₄ | 1 ¹ ₁₆ | 1 ¹ ₁₆ | ⁵ ₁₆ | (10) ¼ x 2½ SDS | 3 x 3½ | 4,565 | 3,285 | 0.114 |
| ■ | HDU5-SDS2.5 | 14 | 3 | 13 ³ ₁₆ | 3 ³ ₄ | 1 ¹ ₁₆ | 1 ¹ ₁₆ | ⁵ ₁₆ | (14) ¼ x 2½ SDS | 3 x 3½ | 5,645 | 4,340 | 0.115 |
| ■ | HDU8-SDS2.5 | 10 | 3 | 16 ⁵ ₁₆ | 3½ | 1¾ | 1½ | ¾ | (20) ¼ x 2½ SDS | 3 x 3½ | 6,765 | 5,820 | 0.11 |
| | | | | | | | | | | 3½ x 3½ | 6,970 | 5,995 | 0.116 |
| | | | | | | | | | | 3½ x 4½ | 7,870 | 6,580 | 0.113 |
| ■ | HDU11-SDS2.5 | 10 | 3 | 22¼ | 3½ | 1¾ | 1½ | 1 | (30) ¼ x 2½ SDS | 3½ x 5½ | 9,535 | 8,030 | 0.137 |
| | | | | | | | | | | 3½ x 7¼ | 11,175 | 9,610 | 0.137 |
| ■ | HDU14-SDS2.5 | 7 | 3 | 25 ¹ ₁₆ | 3½ | 1 ¹ ₁₆ | 1 ¹ ₁₆ | 1 | (36) ¼ x 2½ SDS | 3½ x 5½ | 10,770 | 9,260 | 0.122 |
| | | | | | | | | | | 3½ x 7¼ | 14,390 | 12,375 | 0.177 |
| | | | | | | | | | | 5½ x 5½ | 14,445 | 12,425 | 0.172 |

1. HDU14 requires heavy-hex anchor nut to achieve tabulated loads (supplied with holdown).

2. HDU14 loads on 4x6 post are applicable to installation on either the narrow or the wide face of the post.

3. Fasteners: Nail dimensions are listed diameter by length. SD and SDS screws are Simpson Strong-Tie® Strong-Drive SD Connector and SDS Heavy-Duty Connector screws. For additional information, see [Fastener Types and Sizes Specified for Simpson Strong-Tie Connectors](#).

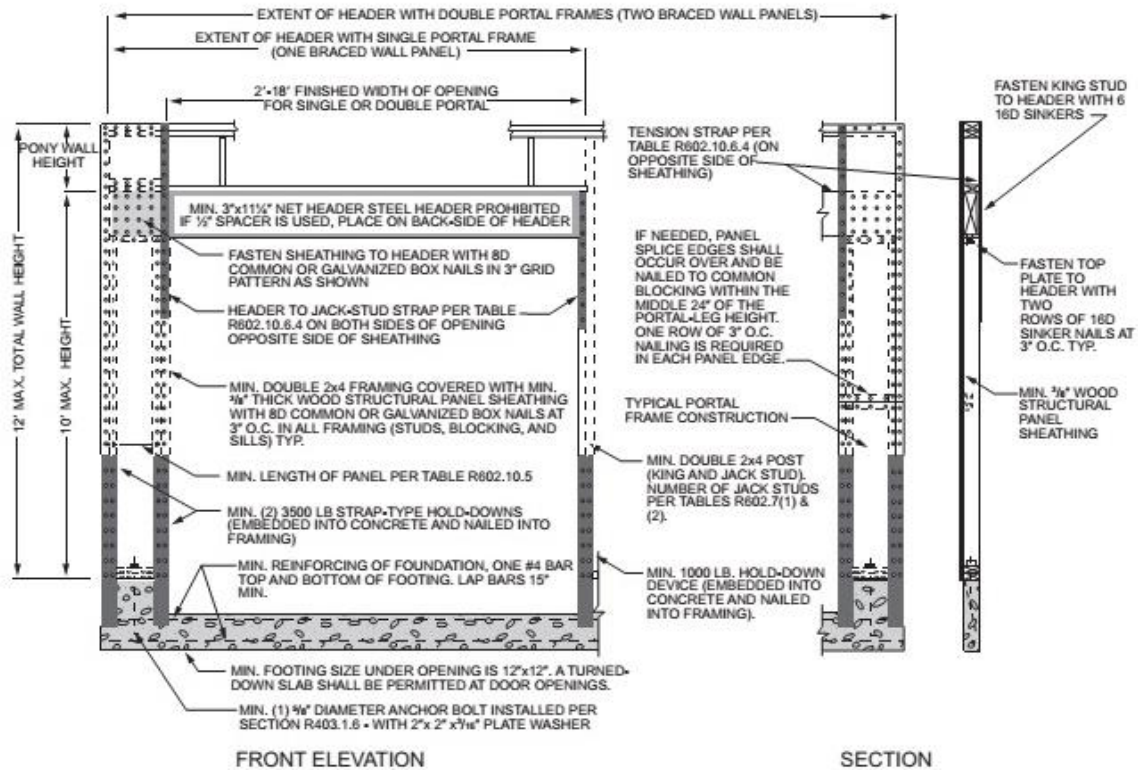

FIGURE R602.10.6.2 METHOD PFH—PORTAL FRAME WITH HOLD-DOWNS

Sincerely,

Bradley Huxol, PE

