



June 2, 2021

IQ Homebuilders
Attn: Brett Shelton

Re: 2330 SW Old Port Road

Vista Structural Engineering, LLC, was asked to address the following framing inspection item for the house being built at 2330 SW Old Port Road:

A floor beam is not sitting fully in pocket at foundation wall. Roughly 1- $\frac{3}{4}$ " is overhanging due to foundation being out of square. Can a 2x4 be bolted to the foundation wall to fully support the beam? *A treated 2x4, or a 2x4 with a moisture barrier installed, bolted to the concrete foundation per the attached sketch, will sufficiently support the beam at the foundation wall. Reference the attached picture and sketch on the following pages. We approve of this attached detailed solution.*

Our firm appreciates the opportunity to serve you. If you have any questions or if you need anything further, please feel free to contact us.

Sincerely,

Vista Structural Engineering, LLC

Dennis Heier, P.E.

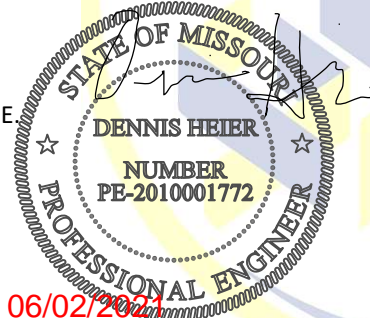

VISTA STRUCTURAL ENGINEERING, LLC

14718 NW DELIA STREET
PORTLAND, OREGON 97229



VISTA STRUCTURAL ENGINEERING, LLC

14718 NW DELIA STREET
PORTLAND, OREGON 97229

- 2 -

PHONE: 971.645.0901
VISTASTRUCTURAL.COM

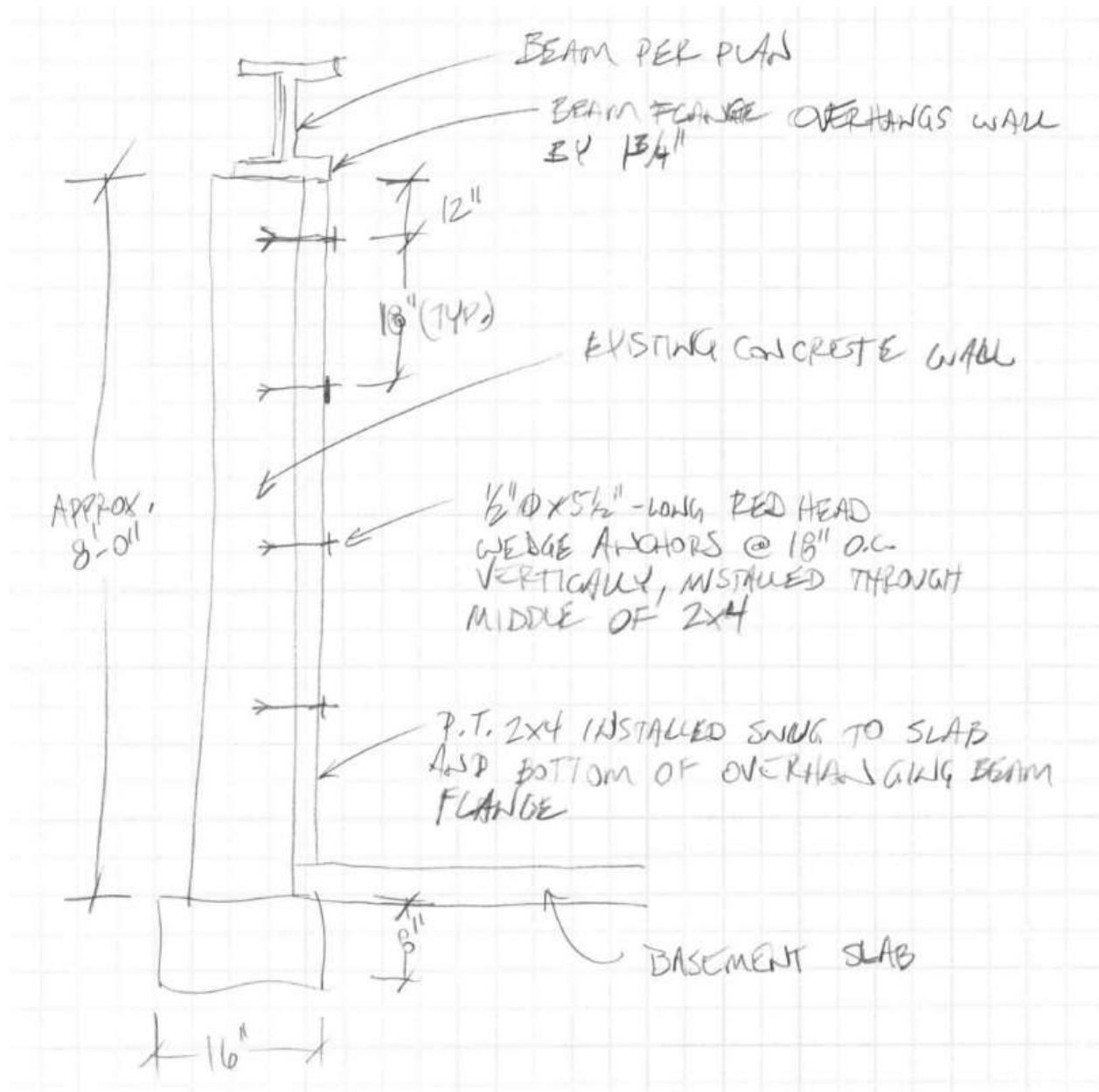

VISTA STRUCTURAL ENGINEERING, LLC

14718 NW DELIA STREET
 PORTLAND, OREGON 97229