



May 21, 2021

Summit Homes
120 SE 30th St.
Lee's Summit, MO 64082

RE: Field Issue of non-continuous post for covered deck and attachment of post to beam, support at "A" footing by stairs, and revision of braced wall panels for Lot # 114 Woodside Ridge – 129 NW Ambershame Dr. Lee's Summit, MO 64081– Permit # PRRES20204843

This letter addresses the non-continuous deck post and attachment of post to beam, support at "A" footing by stairs and revision of braced wall panels for Lot # 114 Woodside Ridge.

The revision shall be as follows:

- Install (2) 16 ga. ST12 Simpson galvanized straps per post per manufacturer's specifications on both posts for deck and patio covering.
- Install with (10) 0.162 x 2-1/2 nails or Strong Drive Screws per manufacturer's specs.
- Straps shall be centered over post cut and installed on opposite sides of post.

Many of these products are approved for installation with [Strong-Drive® SD Connector screws](#).

Model No.	Ga.	Dimensions (in.)		Fasteners (Total) (in.)	Allowable Tension Loads (DF/SP)	Allowable Tension Loads (SPF/HF)
		W	L		(160)	(160)
ST2115	20	¾	16½	(10) 0.162 x 2½	660	660
ST9	16	1¼	9	(8) 0.162 x 2½	885	765
ST12		1¼	11½	(10) 0.162 x 2½	1,105	955
ST18		1¼	17¾	(14) 0.162 x 2½	1,420	1,335
ST22		1¼	21½	(18) 0.162 x 2½	1,420	1,420
ST292	20	2½	9½	(12) 0.162 x 2½	1,260	1,120
ST2122		2½	12¾	(16) 0.162 x 2½	1,530	1,510
ST2215		2½	16½	(20) 0.162 x 2½	1,875	1,875
ST6215		2½	16½	(20) 0.162 x 2½	2,090	1,910
ST6224	16	2½	23¾	(28) 0.162 x 2½	2,535	2,535
ST6236	14	2½	33¾	(40) 0.162 x 2½	3,845	3,845

1. See [General Notes for Straps and Ties](#).

2. Fasteners: Nail dimensions in the table are listed diameter by length. For additional information, see [Fastener Types and Sizes Specified for Simpson Strong-Tie Connectors](#).

- Install ½" x 5" lag screws at beam to post connection and at end deck joist to post connection. Install (2) ½" lag screws per connection.

- Install (2) LIB braced wall panels at interior of bedroom #2 as shown in image below per 2018 IRC. WSP panels at bedroom #2 shall be omitted.

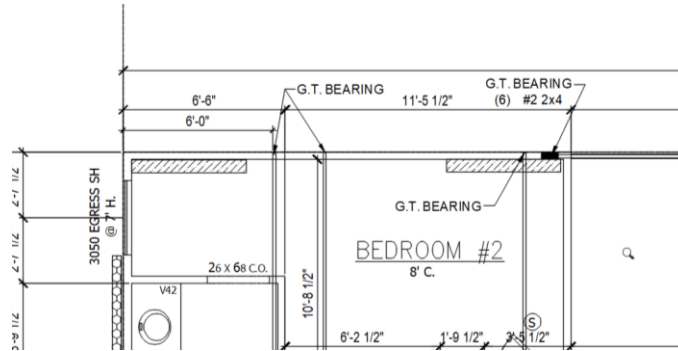

- It is structurally acceptable to install (3) Douglas Fir Larch #2 2x4's below stud pack above at stair support with footing "A" as shown in image below.

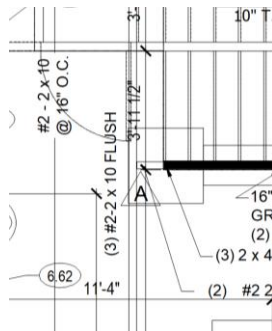

Sincerely,

Bradley Huxol, PE

