

CONSTRUCTION STAKE PLOT PLAN

ACCU-SURV SURVEY COMPANY
300 S. SUNSET LANE
RAYMORE, MO. 64083
(816) 322-1973 FAX (816)322-9522

ORDERED BY: Stewart Builders, LLC
ADDRESS: 508 S.E. David Road
DESCRIPTION: Lot 2, COBEY CREEK - 1ST PLAT, a subdivision
in the City of Lee's Summit, Jackson County, Missouri.

XXXXX ACCEPTABLE DAYLIGHT LOCATION ELEV. = NONE

///// ACCEPTABLE WALK-OUT LOCATION ELEV. = NONE

DECK APPROVAL REQUIRED
PRIOR TO CONSTRUCTION

FINAL GRADE AS-BUILTS
REQUIRED PRIOR TO SODDING.

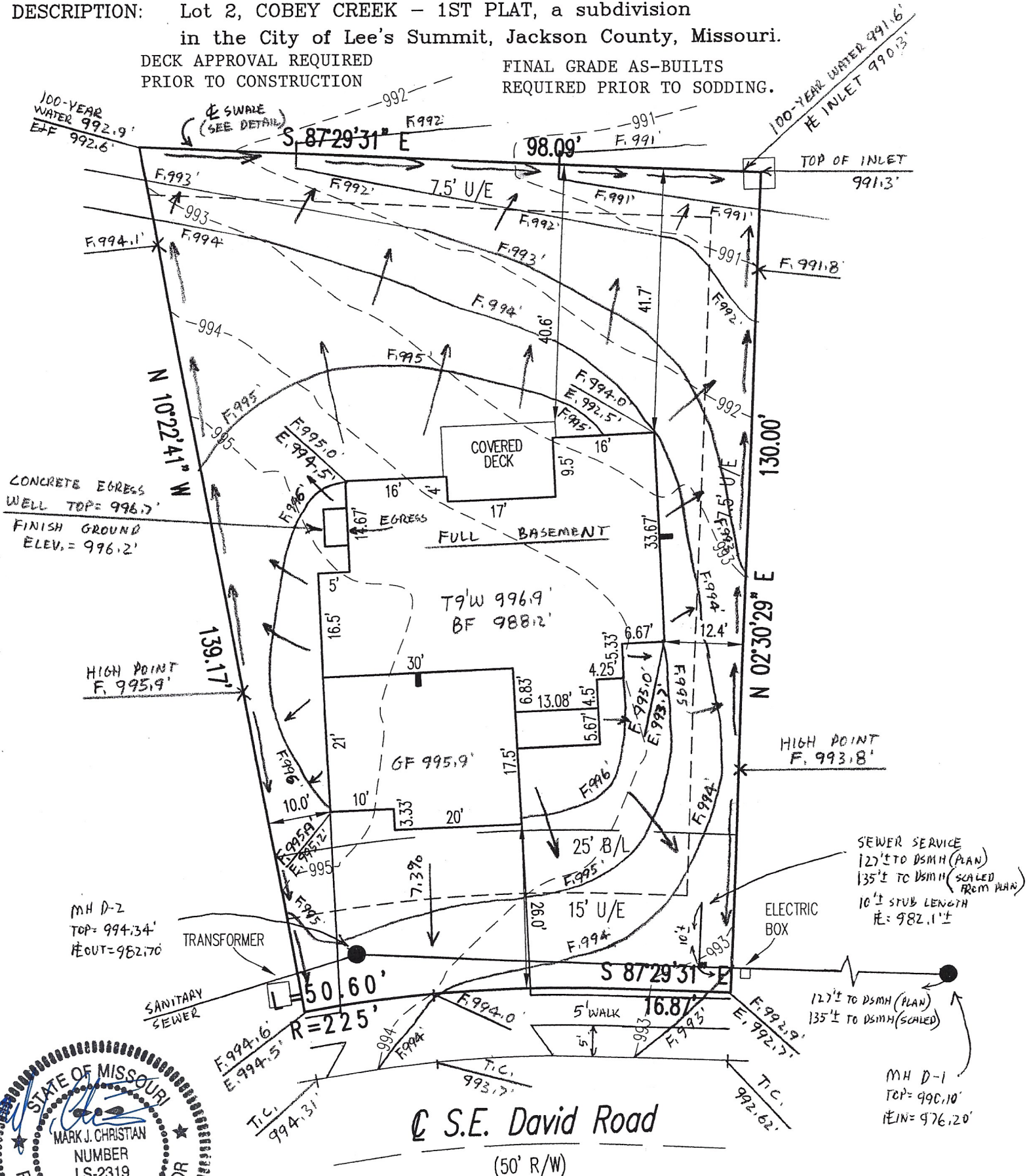

MINIMUM BASEMENT OPENING
ELEVATION : 992.9' + 2.0' = 994.9'

LOW OPENING IS TOP OF EGRESS
WELL ELEVATION = 996.7'

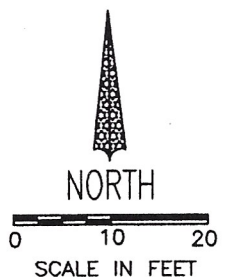
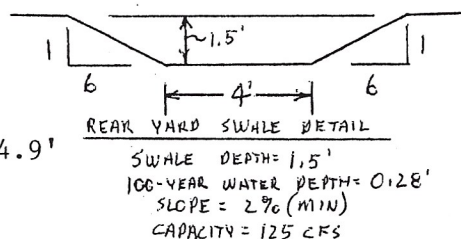

ATTENTION: Contractor to check and verify house dimensions and elevations at job site. We are not responsible for unknown or unplatted easements of any kind unless we are furnished the description of said easements before the field work is performed. NOTE: Final decision as to cuts and foundation height are to be made by builder on job site. NOTE: This plot plan is not to be construed as a boundary survey, and is not to be used for construction of fences. This plot plan is not an "AS-BUILT SURVEY" as the house shown was staked prior to construction and cannot be used in place of a "SURVEYOR'S REAL PROPERTY REPORT" or "MORTGAGE INSPECTION". ©Copyright 2021

SCALE: 1" = 20'

DATE: 03-28-2021

JOB NO: 21040